

**NOTE: PLEASE AN ASSISTANT IS REQUIRED
ES NECESARIO UN AYUDANTE UN ASSISTANT
ESTNECESSAIRE.**



**Please scan the QR code to
check the assemble video**



Leading the Way in Safe Box Manufacturing Excellence!

01

PRODUCT STRUCTURE

02

FIRST-TIME OPENING AND BATTERY INSTALLATION

03

SETTING THE PASSWORD

04

OPENING AND CLOSING THE SAFE

05

DUAL ALARM SYSTEM

06

CUSTOMER SUPPORT AND WARRANTY

⚠ WARNING



WARNING•Tip over hazard: The cabinet can be tipped over by children or adults, please make sure the cabinet is mounted on the wall or floor. Keep the keys in a secure place away from children.

PRODUCT STRUCTURE

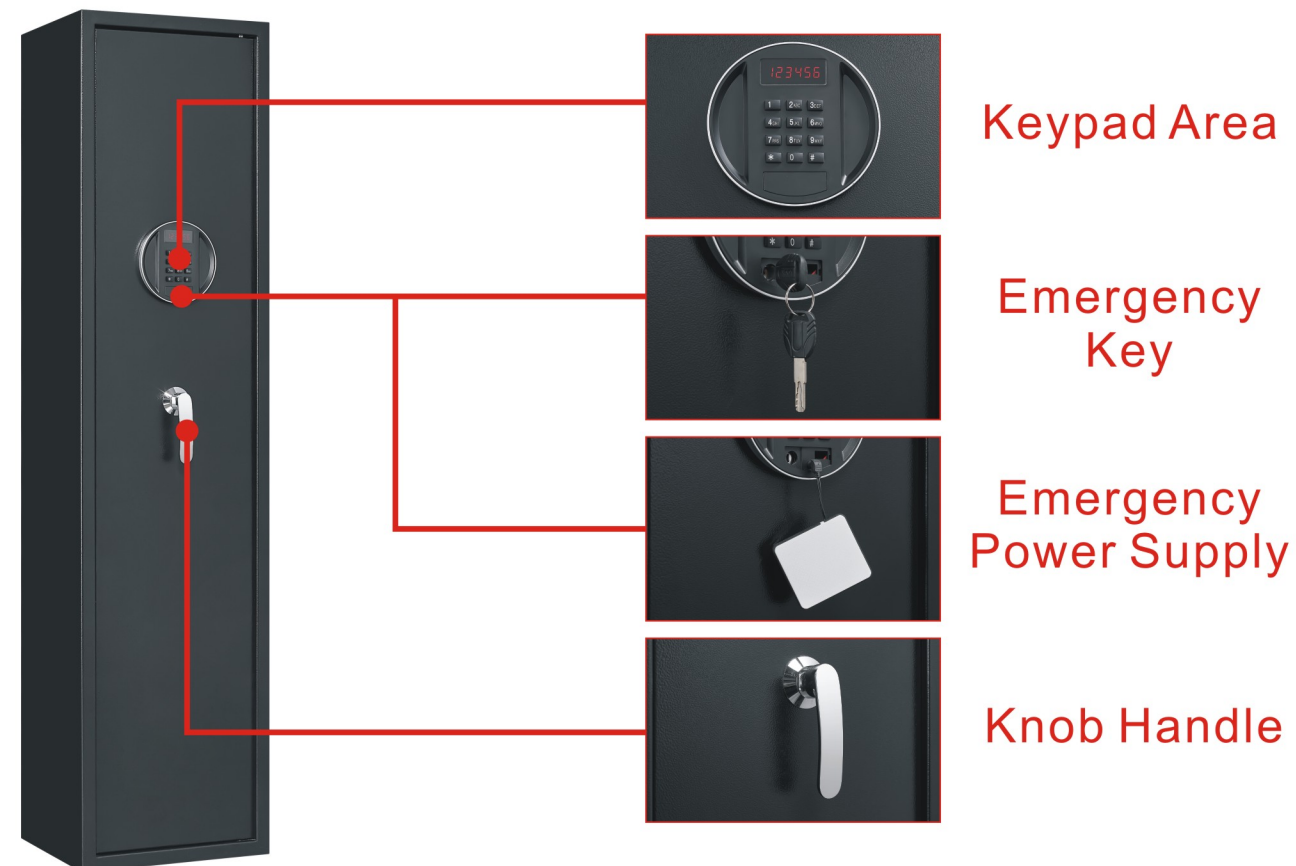

Battery Compartment

Interior Cabinet

Reset Button

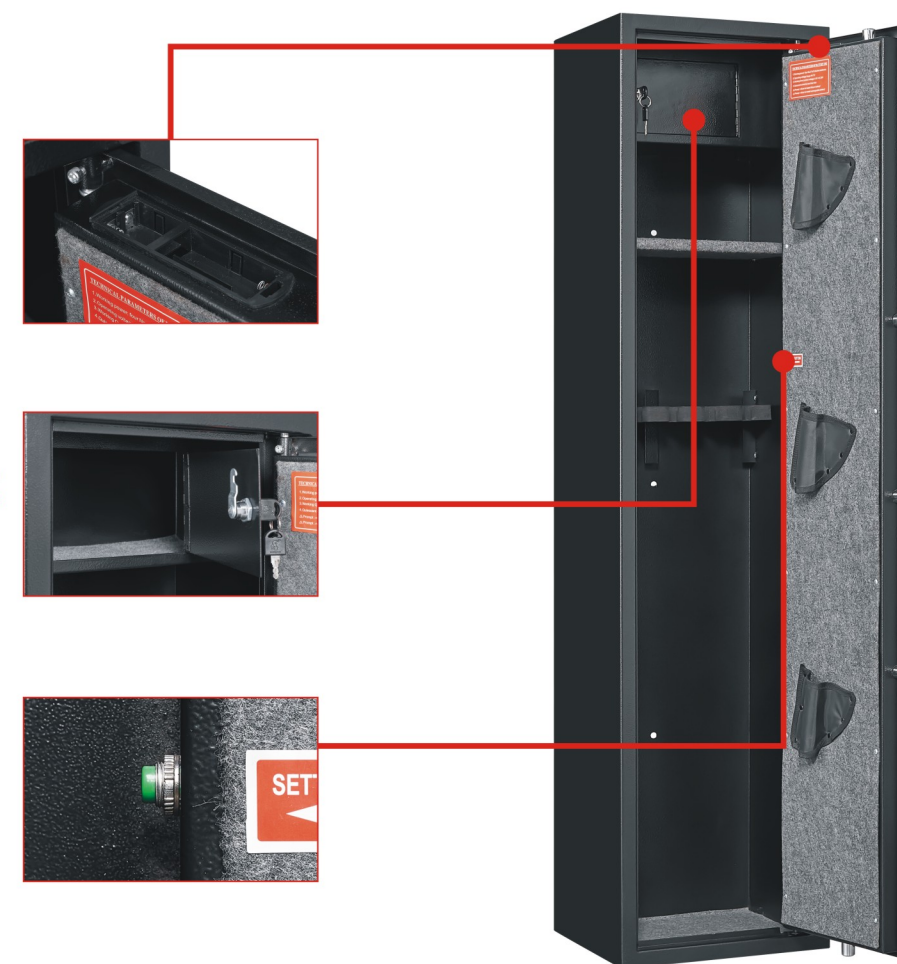

FIRST-TIME OPENING



STEP 1: Open the nameplate on the panel to find the emergency key slot;

STEP 2: Insert the key into the keyhole and rotate it counterclockwise;

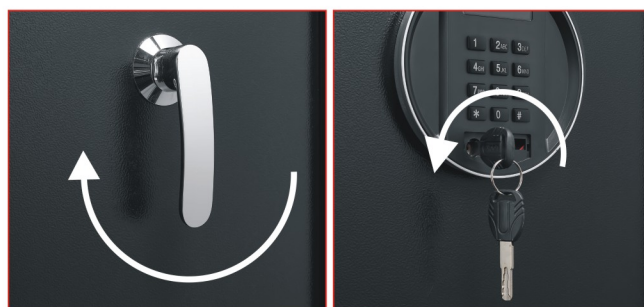

STEP 3: Simultaneously, turn the knob clockwise to open the safe;

IMPORTANT NOTE: The key must be fully inserted into the lock before rotating it

BATTERY INSTALLATION

STEP 1: After opening the door, locate the battery compartment on the backside of the door panel;

STEP 2: Prepare four brand new AA batteries and insert them into the battery compartment, ensuring to observe the correct polarity. When you hear a "beep" sound, it indicates that the circuit is activated.

IMPORTANT NOTE:

When the voltage is too low, the display screen shows "bt-Lo" with buzzer sounds to indicating the batteries are needed to be replaced by new ones to ensure normal use.



SETTING THE PASSWORD

IMPORTANT NOTES:

1: Unlock the door with password: Press "#" to active the panel, the display screen lights up and shows "-----", input password and press "#" to confirm.

2: There are 2 initial passwords for this safe: "1234", "123456". Please change them according to your needs.

3: When setting a password, it must contain at least 3 characters and can have a maximum of 8 characters.

4: This safe allows the setup of 2 different password combinations.

SETTING THE FIRST PASSWORD:

STEP 1: Press the setting button, the display screen lights up and shows "-----" with a buzzer sound.

STEP 2: Enter your new password and press "#" to confirm.

STEP 3: With a long "beep" sound, new password is set successfully.



STEP 2~3:All the same with setting your first password.

IMPORTANT NOTES:

1.On the first consecutive attempt of entering an incorrect password for three times, the buzzer will continuously sound for 20 seconds without interruption.

2.On the second consecutive attempt of entering an incorrect password for three times, the buzzer will continuously sound for 5 minutes without interruption. (You can stop the sound by opening the safe with the key and removing the batteries.)



OPENING THE SAFE

THREE UNLOCKING METHODS:

- 1.**The first unlocking method: Using the emergency key;
- 2.**The second unlocking method: Using the keypad password;
- 3.**The third unlocking method: Using the emergency battery box+password.

VIBRATION ALARM

The alarm can be lifted by entering correct password.

1.The vibration alarm can be activated by pressing "*" button more than 3 seconds till the screen lights up and shows "BE-ON".

2.When powering on, the system defaults to turn off the alarm.

3.The alarm will be deactivated once the door is opened. If it's needed, please re-activate the alarm as step 1.

RESTORE FACTORY SETTINGS

1.Press and hold the set button for about 3 seconds (do not release) until the digital tube displays "SUCESS" and the buzzer makes a long "beep --" sound.

2.The guest password is initialized to "1234" and the master password is initialized to "123456".