

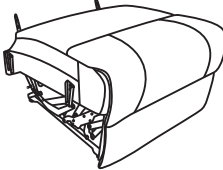







# Assembly Instructions

## Package Contents

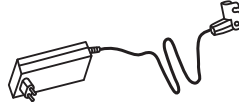
 A Chair Seat	 B Left Armrest	 C Right Armrest	 D Backrest
<b>Box 1</b>	<b>Box 2</b>		<b>Box 3</b>
 E Power Source	 F Power Cord	 G Massage Remote	 H  I J K

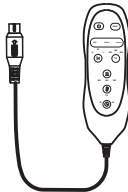
## Step 1

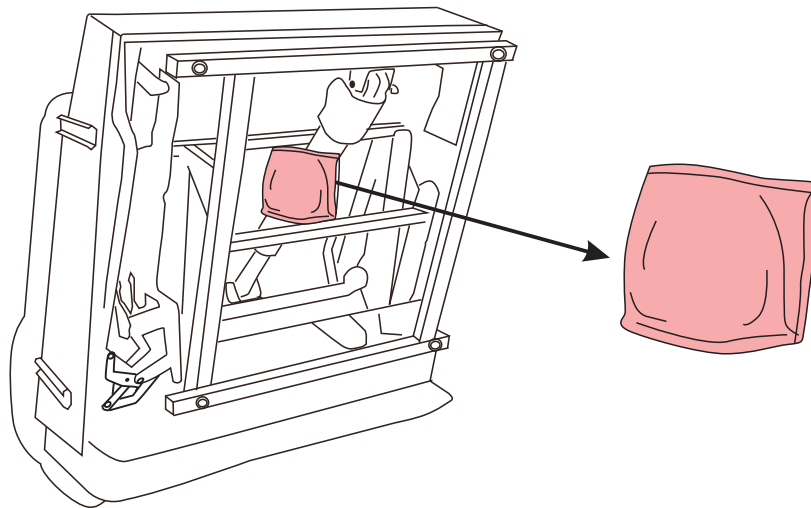

Take out a small package. This small package contains accessories E, F, G, H, I and J. If this small package is lost during transportation, please email us.

## Step 2

Connect the Armrests (B&C) to the chair seat (A) by aligning the metal latches (male brackets) and grooves (female brackets) and sliding the right/left armrest down to the bottom. Push down on the top of the armrest to lock the armrest into position. You will hear a click from each side of the armrest to ensure the back is locked properly.

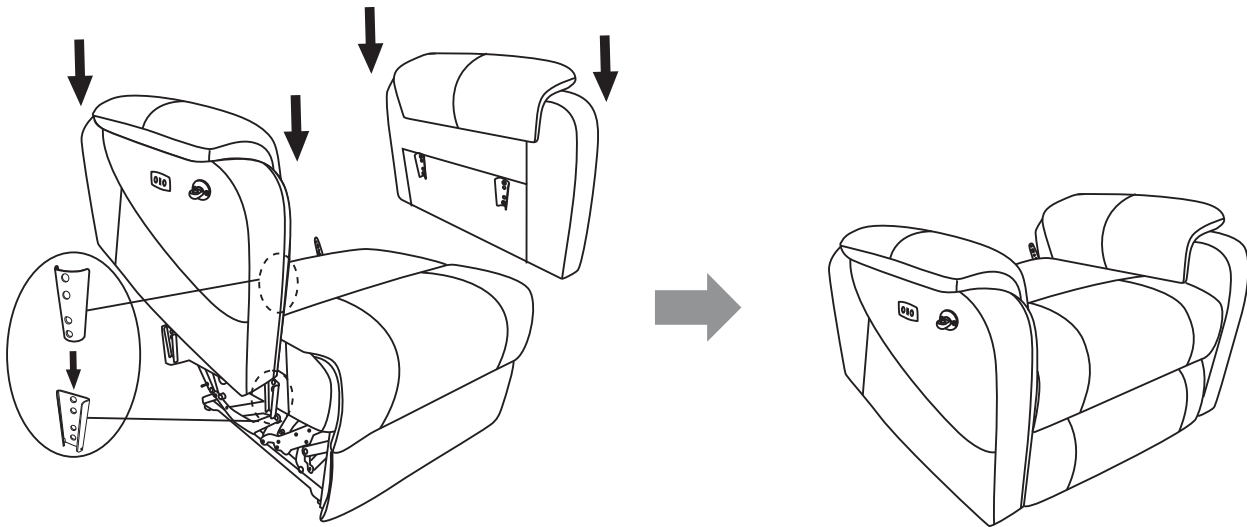

## Step 3

Connect the chair backrest (D) to the chair seat (A) by aligning the metal latches (male brackets) and grooves (female brackets) and sliding the backrest down to the bottom. Push down on the top of the back to lock the back into position. You will hear a click from each side of the backrest to ensure the back is locked properly.

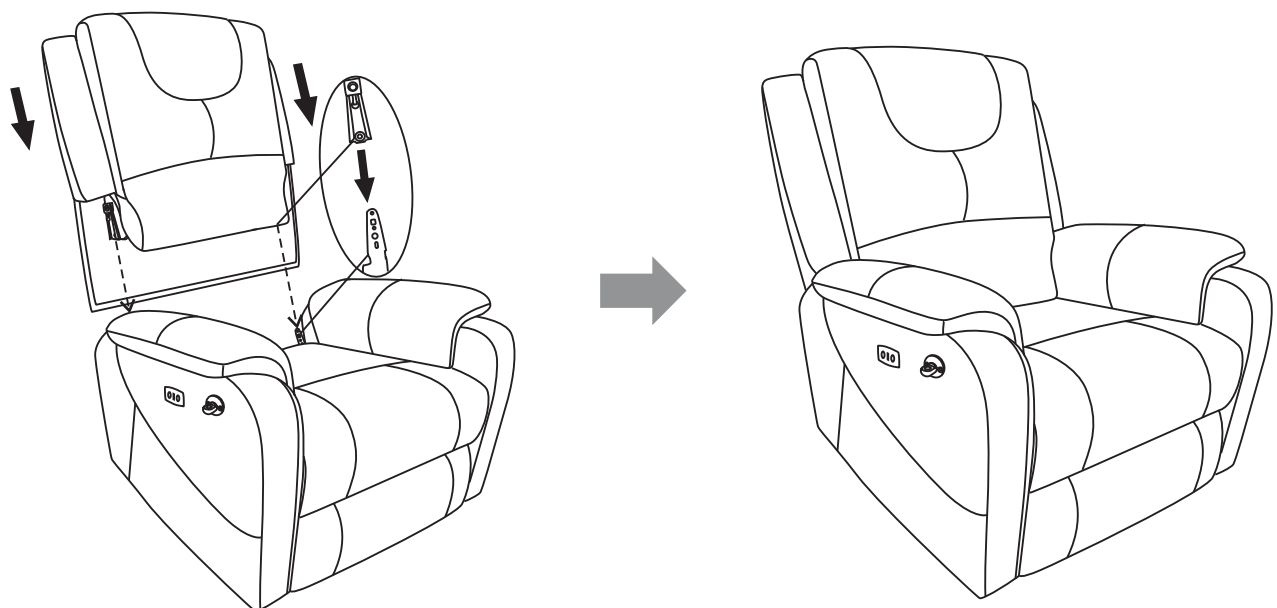

## Step 4

Correct phone holder to the cradling piece and fix it ok.

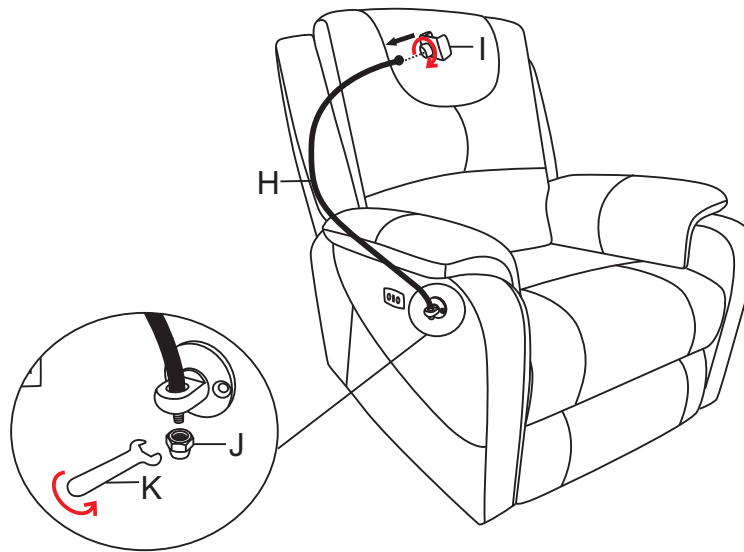

## Instructions for Connecting Power Cords

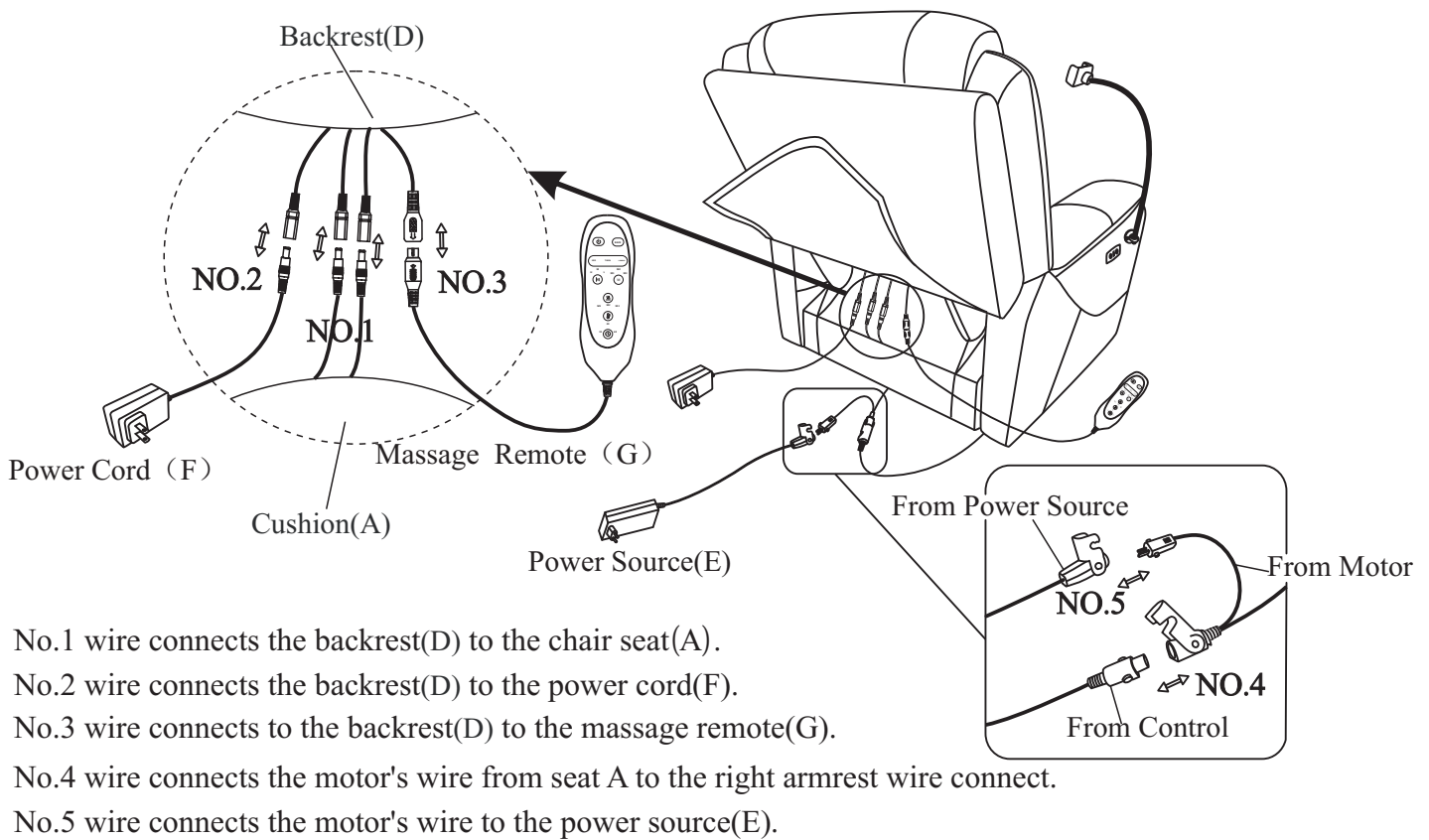

No.1 wire connects the backrest(D) to the chair seat(A).

No.2 wire connects the backrest(D) to the power cord(F).

No.3 wire connects to the backrest(D) to the massage remote(G).

No.4 wire connects the motor's wire from seat A to the right armrest wire connect.

No.5 wire connects the motor's wire to the power source(E).

### Note:

1. If the wiring has several colors, please connect according to the colors, such as black to black, white to white, and red to red.
2. Plug the **Power Cord(F)** and **Power Source(E)** into the outlet to get the recliner working.