

Shower System Installation Manual

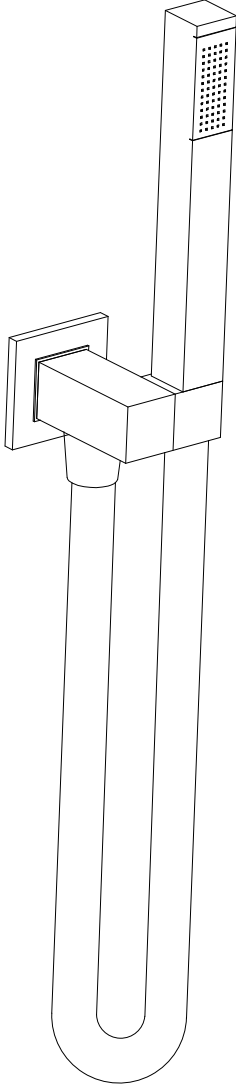

Dual function concealed faucet parts list

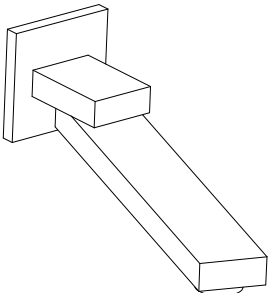
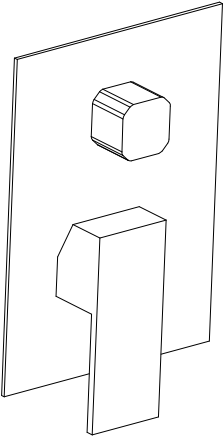
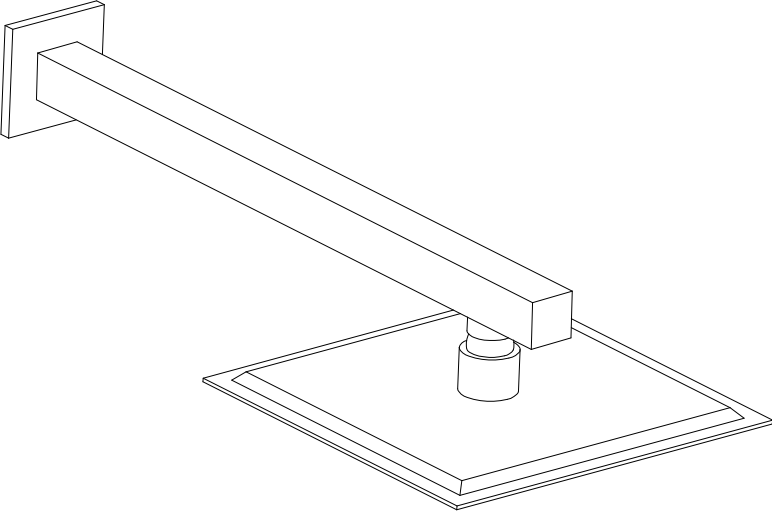
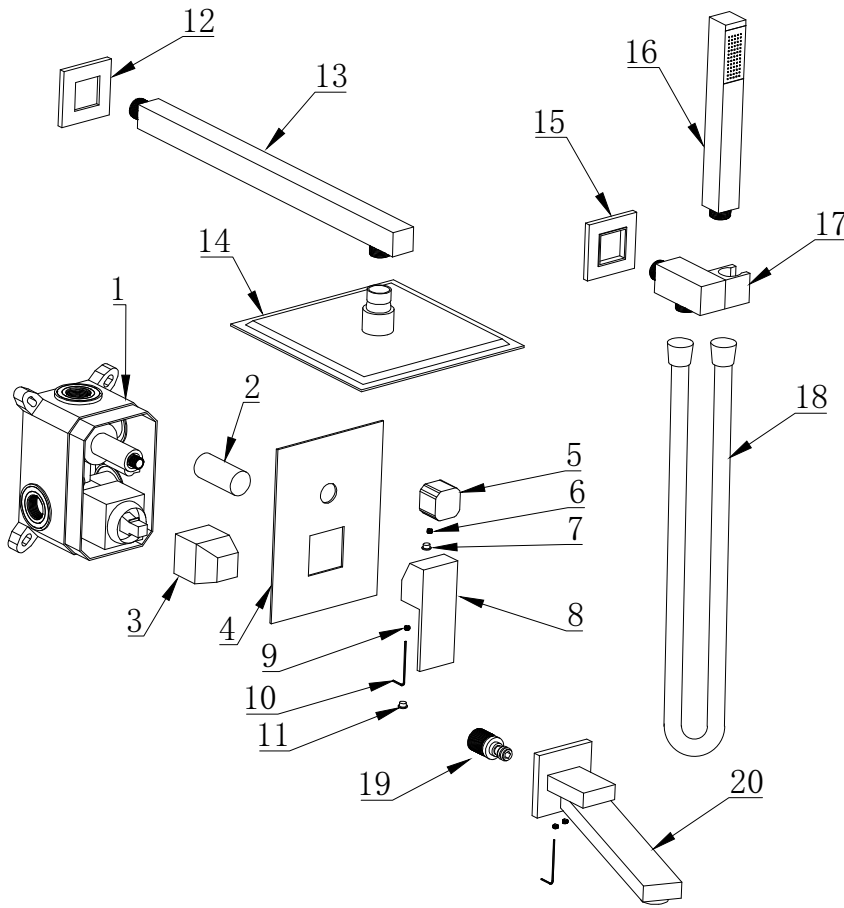

No	Description	QTY
1	Rough-in valve	1
2	protective cover	1
3	protective cover	1
4	cover board	1
5	diverter handle	1
6	Hexagonal screw	1
7	Decorative hat	1
8	on/off handle	1
9	Hexagonal screw	1
10	Allen key	1
11	Decorative hat	1
12	cover board	1
13	shower arm	1
14	shower head	1
15	Wall covering	1
16	handle shower	1
17	Bracket	1
18	shower hose	1
19	1/2-14NPT	1
20	rotatable bathtub spout	1

Technical drawing of dual function

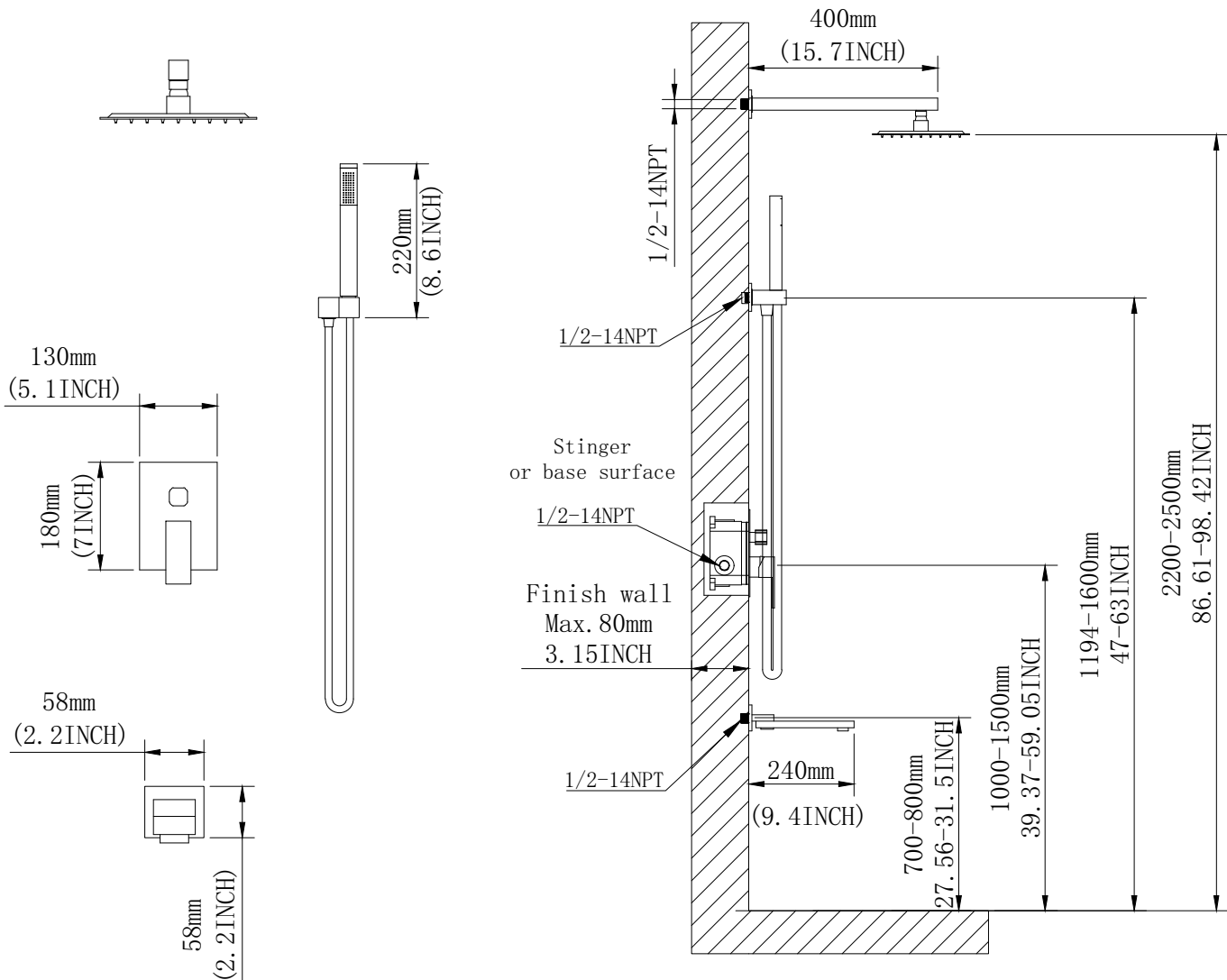

Technical drawing of drilling size

1. The size of the embedded box that needs to be drilled is 5.3" • 6.7"

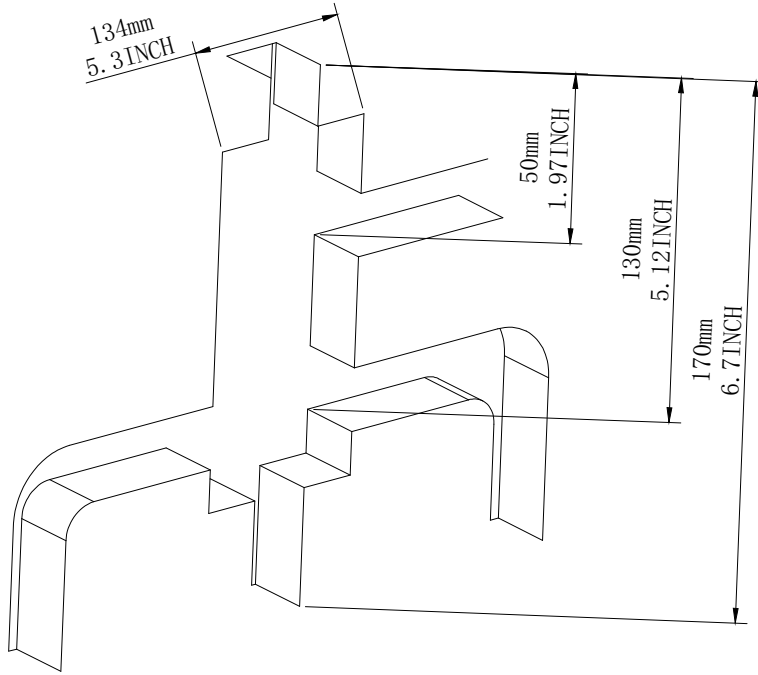

2. The depth of the embedded box is 2.36" • 3.15"
It's better to drill the depth of 2.36" for blank wall

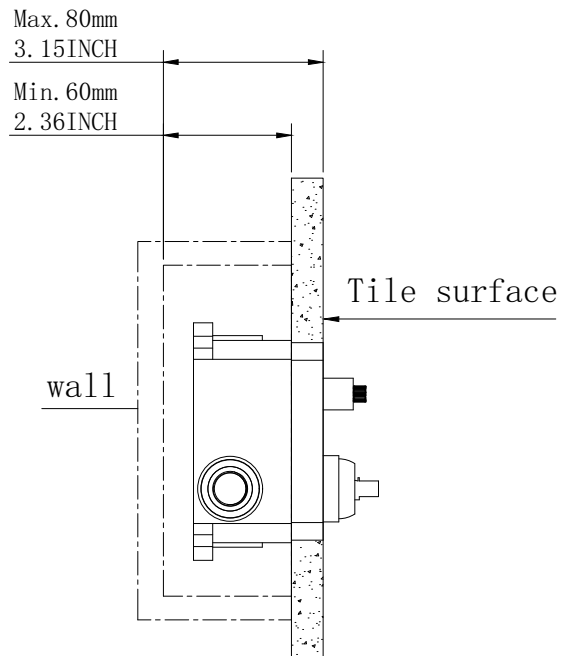
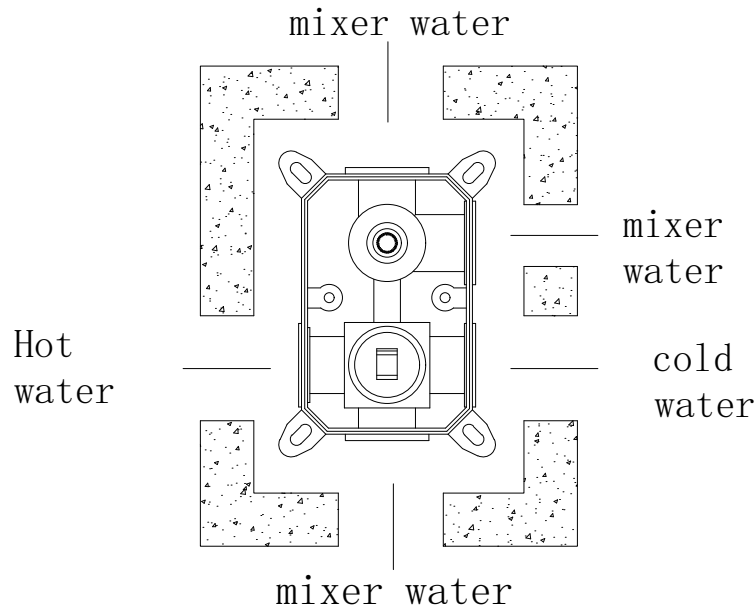

Pipe connection

1. Please drill the holes on the wall for the main body embedded part, hot and cold water inlet pipes as well as shower arm connection pipes according to the basic product dimension drawing as below.
2. Please make hot and cold water inlet pipe, the mixed water outlet pipe connect with control valve, and tightened with the wrench.

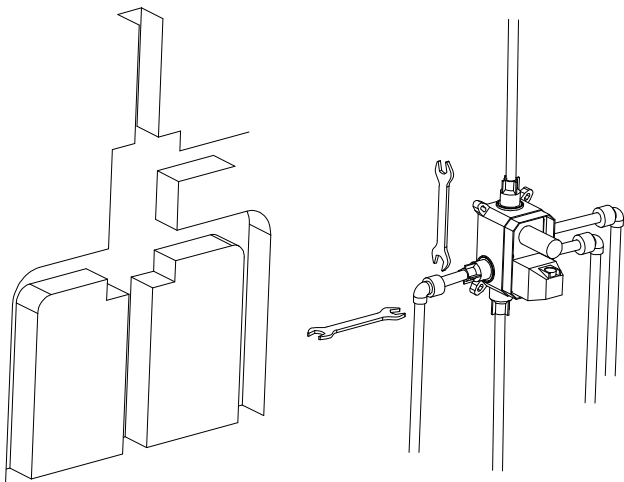

Water testing and sealing testing

1. After the pipe connection is completed, open the protective panel and cover, and then open the cartridge, flush the pipeline; Then close the cartridge to check the pressure resistance and sealing performance of the pipeline, make sure there are no leakage.

2. Block each outlet pipe with a stopper then open the cartridge to check if the pipe joint is well-sealed and the pipe condition under pressure to ensure no leakage.

Testing Purpose: Flush the impurities and sludge in the pipeline to avoid clogging and affect the effluent functions.

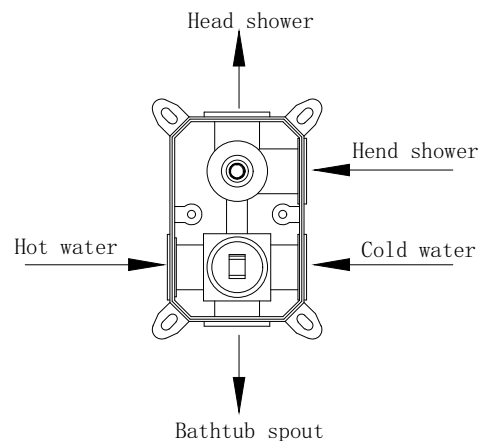

The procedure of sealing the wall
 Use a parallel ruler to measure the flatness of the embedded box casing and the vertical wall surface. If the wall surface is not flat, it should be patched to ensure the embedded box casing and vertical wall angle meets at nearly ideal angle of 90, then lay the tile decoration.

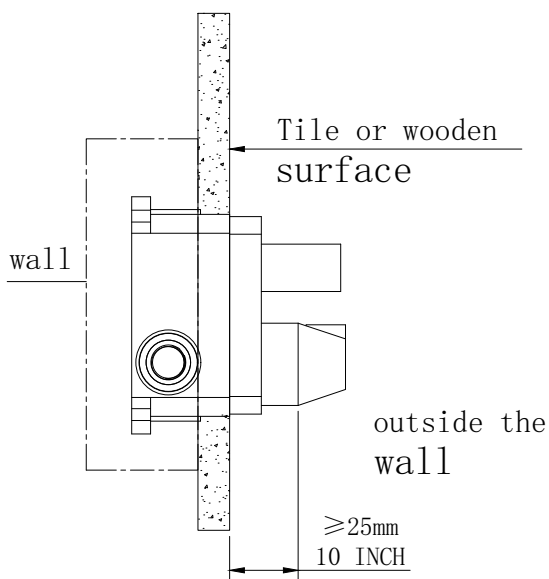

Install the shower head

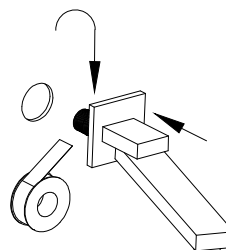
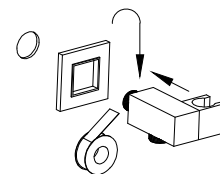
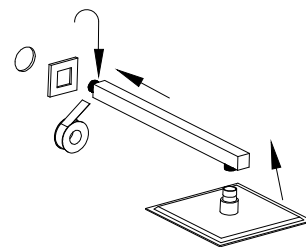

Handle shower installation

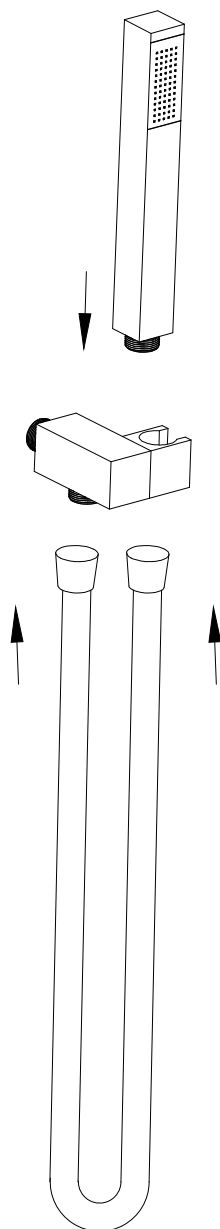

Installation of Rough-in valve

1. Take off the protective panel and cover
2. The decorative panel and the handle are connected to the control valve as shown below sequence

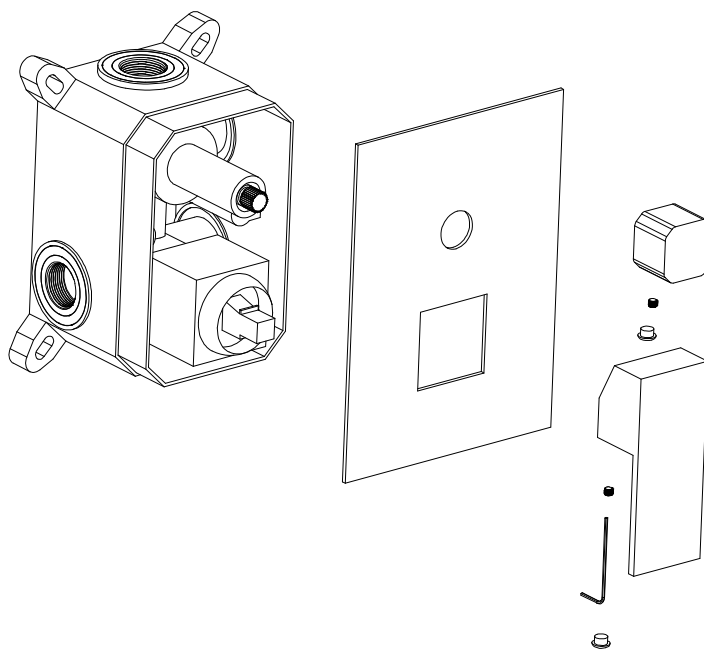

According to the figure below, please correctly adjust the direction of water separator handle

