

**LAB LOCATION:** DONGGUAN **ISSUE DATE:** May 15 2024  
**REPORT NUMBER:** EFW724041109-H-01 **PAGE:** 1 of 14

**Applicant** : Suqian quanermei Home Furnishing Industry Co., Ltd  
**Address** : No.9 Development Avenue, Yiyang Industrial Science and Technology Park, Siyang County, Suqian City  
**Contact Person** : Lin Xiadan  
**Sample Description** : Dresser  
**Item/ Style Number:** WA13064, WB14677, WV48945, WC49170, WE13253, WF38556, WG31614, WD34902, WH29297, WJ19778, WK53681, LXY00A036, WL37267, WM54894, WN21479, JP0007-HY, WP52620, WR23406, BEY-0006-4, WT13500  
**P. O. / Order No** : --  
**SKU No** : --  
**Quantity** : 1box  
**Buyer** : --  
**Manufacture** : --  
**Testing Status** : --  
**Previous Report No.** : --  
**Other/ Comments** : --  
**Country of Origin** : --  
**Country of Destination** : --  
**Date of Submission** : April 11, 2024  
**Test Performance Dates** : April 11, 2024- May 15, 2024  
**Overall Rating** : **PASS**

**Photo of Submitted Sample**



**EFW724041109-H-01**

For and on behalf of  
**Modern Testing Services (Dongguan) Limited**



**Li Xin Yu, Insoul**  
**Assistant Manager, Hardlines**

**LAB LOCATION:** DONGGUAN  
**REPORT NUMBER:** EFW724041109-H-01

**ISSUE DATE:** May 15 2024  
**PAGE:** 2 of 14

**TEST RESULT SUMMARY**

<b>Test Requested</b>	<b>Results</b>
Total Lead Content in Paint or Similar Surface Coating – U.S. CPSC 16 CFR 1303	PASS
Formaldehyde Content in Air from Wood Products – US EPA, 40CFR Part 770.10, Toxic Substance Control Act (TSCA) title VI	PASS
ASTM F2057 - 23 Standard Safety Specification for Clothing Storage Units	PASS

**LAB LOCATION:** DONGGUAN  
**REPORT NUMBER:** EFW724041109-H-01

**ISSUE DATE:** May 15 2024  
**PAGE:** 3 of 14

**COMPONENT BREAKDOWN LIST:**

Test Item	Component Description
<b>A</b>	<b>Dresser</b>
A1	Brown MDF ( Raw material ) ( 16mm )
A2	Golden coating with underlying white coating ( On handle )
A3	Transparent coating with underlying khaki / brown coating ( On main body )
A4	Khaki / brown coating ( On edge banding )
A5	White coating ( On slide rail )

**TEST RESULT:**

**1. Total Lead Content in Paint or Similar Surface Coating – U.S. CPSC 16 CFR 1303**

Test Item	Accessibility (Remark 1)	Classification	Total Lead (Pb) (ppm)		Conclusion
			Result	Limit	
A2+A3	Accessible as received	Paint or similar surface coating	24	90	PASS
A4	Accessible as received	Paint or similar surface coating	<10	90	PASS
A5	Accessible as received	Paint or similar surface coating	10	90	PASS

ND = Not Detected (Laboratory Reporting Limit = 10ppm)

Method:

- 1) Lead in paint and other similar surface coatings:  
 The test is conducted according to the US CPSC Standard Operating Procedure for Determining Lead (Pb) in Paint and Other Similar Surface Coatings, February 25, 2011 (CPSC-CH-E1003-09.1)
- 2) Lead in metals:  
 The test is conducted according to the US CPSC Standard Operating Procedure for Determining Total Lead (Pb) in Children’s Metal Products (Including Children’s Metal Jewelry), November 15, 2012 (CPSC-CH-E1001-08.3)
- 3) Lead in other non-metal materials including plastics, glass and leather material:  
 The test is conducted according to the US CPSC Standard Operating Procedure for Determining Total Lead (Pb) in Non-Metal Children’s Products, November 15, 2012 (CPSC-CH-E1002-08.3)

Remark:

1. The accessibility of the submitted sample is verified according to 16 CFR 1500.87 (e) before and after abuse.

Note: ppm = part per million = mg/kg (milligram per kilogram)  
 “<” = less than

**LAB LOCATION:** DONGGUAN  
**REPORT NUMBER:** EFW724041109-H-01

**ISSUE DATE:** May 15 2024  
**PAGE:** 4 of 14

**2. Formaldehyde Content in Air from Wood Products – US EPA, 40CFR Part 770.10, Toxic Substance Control Act (TSCA) title VI**

Test Item	Result - Formaldehyde (ppm)			Conclusion
	Trial 1	Trial 2	Mean	
#A1	0.09	0.09	0.09	PASS
Limit	-	-	0.11	-

ND = Not Detected (Laboratory Reporting Limit = 0.02ppm)  
 Note: ppm = part per million  
 "<" = less than

Method: ASTM D 6007-14 Standard Test Method for Determining Formaldehyde Concentrations in Air from Wood Products Using a Small Scale Chamber.

Remark:

Formaldehyde Emission Standards for Hardwood Plywood (HWPW), Particleboard (PB), and Medium Density Fiberboard (MDF)				
- Emission Standards (ppm) -				
HWPW-VC	HWPW-CC	PB	MDF	Thin MDF
0.05	0.05	0.09	0.11	0.13
HWPW-VC = Veneer Core; HWPW-CC = Composite Core				

#Result of item A1 in this report was transferred from item 1 of Report No. EFW724041108.

LAB LOCATION: DONGGUAN  
 REPORT NUMBER: EFW724041109-H-01

ISSUE DATE: May 15 2024  
 PAGE: 5 of 14

**3. ASTM F2057-23 Standard Safety Specification for Clothing Storage Units**

Clause	Requirement	Result		Remark
		Pass	Fail	
<b>4.0 Performance Requirements</b>				
4.2	During the test, the unit shall not tip over or be supported by any component unless that component was specifically designed for that purpose.	X		Volume: 4.7 ft <sup>3</sup> Weight: 52.8 kg
4.3	If a failed component prohibits the completion of the test, then the failed component(s) shall be repaired or replaced to the original specifications, or the component replaced and the test repeated with the failed component secured as to not affect the test results but to prevent the component from failing	—	—	NA
4.4	An anti-tip device shall be included with each item of furniture covered under the scope of this safety specification for attachment by the consumer	X		
4.5	The anti-tip device provided shall meet the requirement of Specification F3096	X		
4.6.1	<u>Interlock Requirements:</u> Interlocks shall not require additional consumer action to engage during normal operation of the extendible element, for example, opening and closing the drawer to access the interior volume	—	—	NA
4.6.1.1	<u>Interlock Requirements:</u> Consumer action to reengage the interlock system after disengaging to allow removal of one or more extendible elements is allowed, for example, to install an anti-tip device or retrieve a lost sock.	—	—	NA
4.6.1.2	<u>Interlock Requirements:</u> An interlocked extendible element removed for such one-time action shall not require removal of components such as back panels and dust bottom to access the interlocking mechanism during reengagement. Reengagement shall not require tools unless those tools are also required for disengagement.	—	—	NA

**LAB LOCATION:** DONGGUAN  
**REPORT NUMBER:** EFW724041109-H-01

**ISSUE DATE:** May 15 2024  
**PAGE:** 6 of 14

Clause	Requirement	Result		Remark
		Pass	Fail	
4.6.1.3	<p><u>Interlock Requirements:</u>            An interlocked extendible element removed for such one-time action shall either:</p> <p>(1) Not be fully functional when reinstalled until the interlock is reengaged. (For example, it will not fully close or ride on tracks if interlock is not reengaged—which can be an automatic action when reinstalled in case.); or</p> <p>(2) Including one or more separate warnings as described elsewhere</p>	—	—	NA
4.6.2	<p><u>Interlock Requirements:</u>            Interlocks shall not require consumer assembly and/or installation if the unit is shipped assembled, except as allowed in 4.6.1.1.</p>	—	—	NA
4.6.3	<p><u>Interlock Requirements:</u>            Consumer assembly and/or installation of interlock components as part of the normal consumer assembly process is allowed for items shipped/sold unassembled.</p>	—	—	NA
4.6.4	<p><u>Interlock Requirements:</u>            When conducting the test the extendible element shall be considered interlocked to the open extendible element if either:</p>	—	—	NA
4.6.4.1	<p><u>Interlock Requirements:</u>            It remains closed during the test and is functional after tested extendible element is closed; or</p>	—	—	NA
4.6.4.2	<p><u>Interlock Requirements:</u>            Its opening acts to close the extendible element originally open.</p>	—	—	NA

**LAB LOCATION:** DONGGUAN  
**REPORT NUMBER:** EFW724041109-H-01

**ISSUE DATE:** May 15 2024  
**PAGE:** 7 of 14

Clause	Requirement	Result		Remark
		Pass	Fail	
9.2.1	<p>Simulated Clothing Load:                      Position the empty unit on test surface described in 8.2.1. For units with levelers, adjust the unit per 8.1.2. 9.2.1.2 If 50 % or more of the storage volume is extended, determine the weight for loading the extendable elements and/or space behind the doors based on the volume calculated in 5.4. Load per 8.3.3. See Fig. 8(B). If less than 50 % of the storage volume is extended, the unit shall remain empty. 9.2.1.3 Open all doors and extend all available extendible elements in accordance with 8.1.3. Elements shall remain open for 30 s.</p> <p>Requirement: The unit shall not tip over or be supported by any component unless that component was specifically designed for that purpose.</p>	X		
9.2.2	<p>Simulated Horizontal Dynamic Force:</p> <p>Force Application on Extendible Element—Where the extendible element has been determined to have the highest hand-hold height, not to exceed 56 in. Apply a 10 lbf horizontal force, parallel to the direction of outward motion, at the highest hand-hold, not to exceed 56 in. on the extendible element most likely to cause tipover. The force shall be applied within 1/4 in. of the top edge of a drawer or to the center of the pull area of the extendible element, whichever is higher but less than 56 in. over a period of at least 5 s and held for 10 s.</p> <p>Force Application on Door with Handle/pull— Where the door handle/pull has been determined to be the highest reach point not to exceed 56 in. Apply a 10 lbf horizontal force, parallel to the direction of initial outward motion, at a height not exceeding 56 in. to the handle or pull. The force shall be applied over a period of at least 5 s and held for 10 s. The door shall be in a position most likely to cause the unit to tip over. If the door handle or pull exceeds the max reach height, follow 9.2.2.1(3). 9.2.2.3 If the door pull/handle height and the extendible element height are the same, it is permissible to test either component.</p> <p>Requirement: The unit shall not tip over or be supported by any component unless that component was specifically designed for that purpose.</p>	X		

**LAB LOCATION:** DONGGUAN  
**REPORT NUMBER:** EFW724041109-H-01

**ISSUE DATE:** May 15 2024  
**PAGE:** 8 of 14

Clause	Requirement	Result		Remark
		Pass	Fail	
9.2.3	<p>9.2.3 Simulating a Reaction on Carpet with Child Weight:                      Position the empty unit on test surface. Place the test block(s) under the unit's most rear floor support(s), such as a leg, foot, or upright. Open all doors and extend all available extendible elements in accordance with 8.1.3. Gradually, over a period of at least 5 s, apply the test apparatus without impact over the top of the door or extendible element most likely to cause tip over Allow the test apparatus to rest without additional support for 30 s. If it is not apparent which door, extendible element, or for clothing storage units with interlock(s), the combination of open and closed extendible elements is most likely to cause tip over, perform multiple tests.</p> <p>Requirement: The unit shall not tip over or be supported by any component unless that component was specifically designed for that purpose.</p>	X		
9.3.1	A paper label shall be considered permanent if, during an attempt to remove it without the aid of tools or solvents, it cannot be removed, it tears into pieces upon removal, or such action damages the surface to which it is attached.	X		
9.3.2	A non-paper label shall be considered permanent if, during an attempt to remove it without the aid of tools or solvents, it cannot be removed or such action damages the surface to which it is attached.	--	--	NA
9.3.3	<p>Adhesion Test for Warnings Applied Directly onto the Surface of the Product:                      Apply the tape test defined in Test Method B – Cross-Cut Tape Test of Test Methods D3359 eliminating parallel cuts. Perform this test once in each different location where warnings are applied. The warning statements shall be considered permanent if the printing in the area tested is still legible and attached after being subjected to this test.</p>	X		



**LAB LOCATION:** DONGGUAN  
**REPORT NUMBER:** EFW724041109-H-01

**ISSUE DATE:** May 15 2024  
**PAGE:** 9 of 14

Clause	Requirement	Result		Remark
		Pass	Fail	
<b>10 Marking and Labeling</b>				
10.1.1	<p><u>Warnings on Product:</u>                      Each clothing storage unit shall be permanently marked in at least one place with the warnings from this section. The warnings shall be in a conspicuous location when in use. The warnings shall be applied on one surface, not wrapped or folded around or over corners.</p>	X		
10.1.1.1	<p><u>Warnings on Product:</u>                      The warnings shall be considered conspicuous when in use when at least one of the following conditions is met:</p> <p>(1) The warnings are inside a drawer box on a drawer side with the top of the signal word panel 0.5 in. (12.7 mm) or less from the top of the drawer side and the border or edge of the label 3 in. (76 mm) or less from the back of the drawer front; they are not required to be visible on all drawers. It is permissible for the warnings to be on either drawer side.</p> <p>(2) The warnings are visible anywhere on the open door or on the cabinet side adjacent to the door no more than 1 in. (25 mm) from the doors closed position or the structure of the unit, whichever is farther from the front, when any hinged door, not each door, is open; they are not required to be visible behind all doors.</p> <p>(3) The warnings are visible on the cabinet side adjacent to the door no more than 1 in. from the door's closed position when any sliding door, not each door, is fully open, or the structure of the unit near the door, whichever is farther from the front. If doors have different distances from the front, this dimension shall apply to the farthest back door; they are not required to be visible behind all doors</p> <p>(4) The warnings from 10.2.3.1 and 10.2.3.3 and the symbol from Fig. 20 shall meet Condition 1 and contain language directing the user to the bottom of the same drawer and the full warning shall be on the inside face of the drawer bottom</p> <div style="text-align: center;">  <p>FIG. 20 Child Climbing Prohibition Symbol</p> </div>	X		

**LAB LOCATION:** DONGGUAN  
**REPORT NUMBER:** EFW724041109-H-01

**ISSUE DATE:** May 15 2024  
**PAGE:** 10 of 14

Clause	Requirement	Result		Remark
		Pass	Fail	
10.1.1.2	<u>Warnings on Product:</u> For units shipped requiring consumer assembly, it is permissible for the warnings to be on parts that can be installed in other locations; the location shall be considered acceptable if it would meet these location requirements in any possible location even if it does not meet them in all locations. For example, if a drawer side can be installed as the left or right side but the conditions in 10.1.1.1(1) are met, only when installed on the right it is acceptable	X		
10.2.1	<u>Warnings Format and Content:</u> The warnings shall be formatted in a manner consistent with ANSI Z535.4	X		
10.2.2	<u>Warnings Format and Content:</u> The signal word panel shall include the Safety Alert Symbol “ $\Delta$ ” and state “WARNING”.	X		
10.2.2.1	<u>Warnings Format and Content:</u> “WARNING” shall be in all caps, bold face type not less than 0.15 in. (3.8 mm) capital letter height in a sans serif font. The letter color shall be safety black on a safety orange or safety white background, or safety white on a safety black background.	X		
10.2.2.2	<u>Warnings Format and Content:</u> The Safety Alert Symbol is composed of an equilateral triangle surrounding an exclamation mark. It shall be presented in one of five color formats when used with the WARNING signal word: A safety black triangle with a safety orange exclamation mark, or; (1) A safety yellow triangle with a safety black border and safety black exclamation mark—to allow consistency with certain ISO standards, or; (2) A safety yellow triangle with a safety black exclamation mark and a yellow border around a safety black band—to allow consistency with certain ISO standards, or; (3) A safety black triangle with a safety white exclamation mark—for black and white only formats, or; (4) A safety white triangle with a safety black exclamation mark—for black and white only formats.	X		
10.2.3	<u>Warnings Format and Content:</u> In the following sections, the plain type is descriptive information; bold type is used for the required warning statements. The warning statements, unless otherwise noted, shall be included as stated. All text shall be a sans serif font, not less than 0.1 in. (2.5 mm) capital letter height. The text shall be safety black letters on a safety white background or the letters shall contrast the background.	X		

**LAB LOCATION:** DONGGUAN  
**REPORT NUMBER:** EFW724041109-H-01

**ISSUE DATE:** May 15 2024  
**PAGE:** 11 of 14

Clause	Requirement	Result		Remark
		Pass	Fail	
10.2.3.1	<u>Warnings Format and Content:</u> The warning message panel shall begin with the following statement in bold face type. Children have died from furniture tipover. To reduce the risk of furniture tipover:	X		
10.2.3.2	<u>Warnings Format and Content:</u> The warning message panel shall include the following statements, preceded by a bullet point, in the order given.	X		
10.2.3.3	<u>Warnings Format and Content:</u> ALWAYS install anti-tip device provided.	X		
10.2.3.4	<u>Warnings Format and Content:</u> Television use shall be addressed in the warnings by following either 10.2.3.4(1) or 10.2.3.4(2). (1) For clothing storage units that are not designed and intended by the manufacturer to be used with a TV shall state: NEVER put a TV on this product. (2) For clothing storage units that are designed and intended by the manufacturer to be used with a TV, the warning shall address TV use. This may be done within the other warnings as shown in the examples or separately to comply with other standards. In either case, all warnings must be conspicuous as defined in 10.1.1.1. See Appendix X1 for reference.	X		
10.2.3.5	<u>Warnings Format and Content:</u> NEVER allow children to stand, climb, or hang on any drawers, doors, or shelves. It is permissible to exclude any feature not included on the unit.	X		
10.2.3.6	<u>Warnings Format and Content:</u> NEVER open more than one drawer at a time. It is permissible to exclude any feature not included on the unit.	X		
10.2.3.7	<u>Warnings Format and Content:</u> When the unit includes interlocking drawers: DO NOT defeat or remove the drawer interlock system; it is an important stability and safety system. Units that do not include interlocking drawers shall not use this statement. It is permissible to remove "drawer," add the appropriate parts and features to this statement, or to address any specific use characteristics of the interlock system.	--	--	NA
10.2.3.8	<u>Warnings Format and Content:</u> Place heaviest items in the lowest drawers. It is permissible to change drawers to a term/location better matching the unit.	X		

**LAB LOCATION:** DONGGUAN  
**REPORT NUMBER:** EFW724041109-H-01

**ISSUE DATE:** May 15 2024  
**PAGE:** 12 of 14

Clause	Requirement	Result		Remark
		Pass	Fail	
10.2.3.9	<p><u>Warnings Format and Content:</u>                      The following statement is required below all other text, in italic letters: This is a permanent label. Do not remove! Alternatively, the following shall be used when markings other than a label are used and may be used with any marking type: This warning is permanent. Do not remove! The statement may not be larger type than any other wording on the warning.</p>	X		
10.2.3.10	<p><u>Warnings Format and Content:</u>                      For units with interlock systems described in 4.6.1.3(2), a warning addressing: DO NOT remove the interlock system except for maintenance as shown. NEVER use the unit without the interlock installed following the instructions. shall be added to each drawer in a location near the interlock hardware; instructions shall be shown or a location with instructions shall be referenced</p> <div style="border: 1px solid black; padding: 5px; margin: 10px 0;"> <p style="text-align: center; font-weight: bold; color: red;">▲ WARNING</p> <div style="display: flex; justify-content: space-between;"> <div style="width: 45%;"> <p>Children have died from furniture tipover. To reduce the risk of furniture tipover:</p> <ul style="list-style-type: none"> <li>-NEVER install AFT-to-device provided.</li> <li>-NEVER put a TV on this product.</li> <li>-NEVER allow children to stand, climb or hang on drawers, doors, or shelves.</li> <li>-NEVER open more than one drawer at a time.</li> <li>-DO NOT defeat or remove the drawer interlock system; it is an important stability and safety system.</li> <li>-Place heaviest items in the lowest drawers.</li> </ul> <p style="font-size: small;">This is a permanent label. Do not remove!</p> </div> <div style="width: 45%;"> <p>DO NOT remove the interlock system except for maintenance as shown. NEVER use the unit without the interlock installed following the instructions.</p> <p style="font-size: small;">System Specific Instructions for interlock installation.                      System Specific Instructions for interlock installation.                      System Specific Instructions for interlock installation.</p> </div> </div> </div> <p style="font-size: x-small;">Note 1—Warnings are not shown to scale.                      FIG. 19 Example Warning Billboarded for Use with Interlocks Requiring in Unit Warnings</p>	--	--	NA
10.2.4	<p><u>Warnings Format and Content:</u>                      Each safety symbol panel shall measure at least 1.25 in. by 1.25 in. (31.8 mm by 31.8 mm); each safety symbol shall measure at least 1 in. by 1 in. (25.4 mm by 25.4 mm). Each symbol shall be safety black with either a safety black or safety red prohibition symbol or the symbol shall contrast with the background. The safety symbol panel for each symbol shall be bounded on all sides with a safety black line or the line shall contrast with the background.</p>	X		
10.2.4.1	<p><u>Warnings Format and Content:</u>                      The child climbing prohibition symbol shown in Fig. shall be used on all warning labels.</p> <div style="text-align: center; margin: 10px 0;"> </div> <p style="font-size: x-small; text-align: center;">FIG. 20 Child Climbing Prohibition Symbol</p>	X		
10.2.4.2	<p><u>Warnings Format and Content:</u>                      The TV prohibition symbol shown in Fig. 21 shall be used on units that include the warning in 10.2.3.4(1)</p>	X		

**LAB LOCATION:** DONGGUAN  
**REPORT NUMBER:** EFW724041109-H-01

**ISSUE DATE:** May 15 2024  
**PAGE:** 13 of 14

Clause	Requirement	Result		Remark
		Pass	Fail	
10.2.5	<u>Warnings Format and Content:</u> The contents of the warnings shall not be modified except as specifically indicated above and/or to include languages other than English.	X		
10.2.6	<u>Warnings Format and Content:</u> The warnings shall be permanent when tested	X		

Note: NA = Not Applicable NR = Not Requested NT = Not Tested

**Exhibit:**

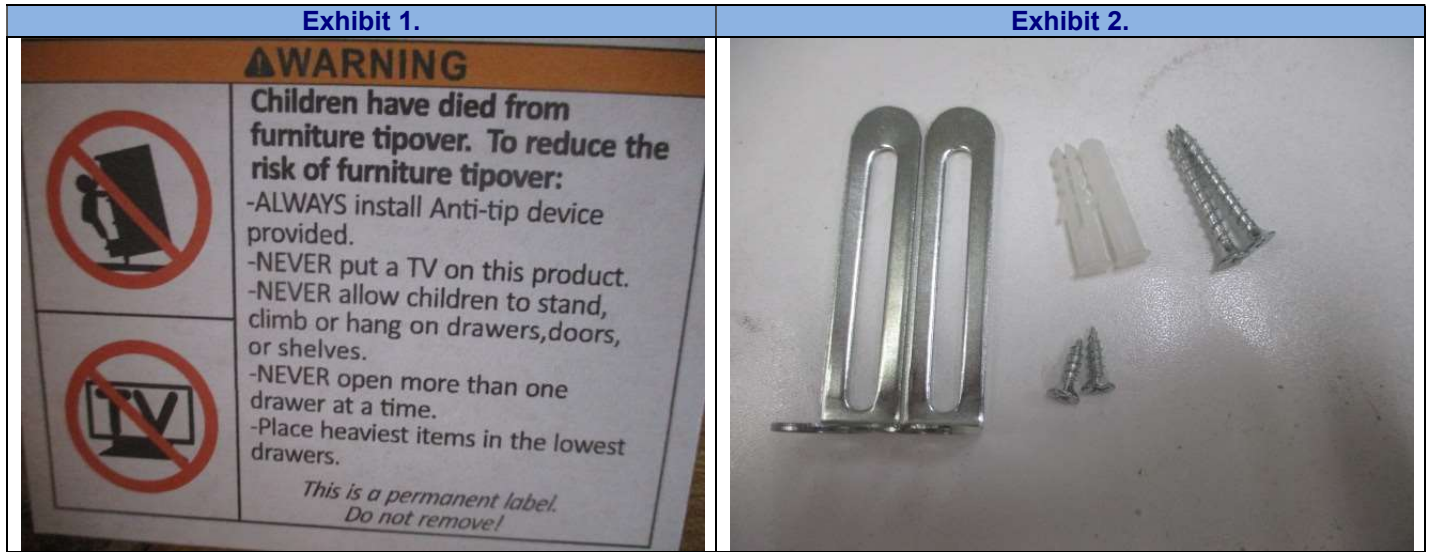

**LAB LOCATION:** DONGGUAN  
**REPORT NUMBER:** EFW724041109-H-01

**ISSUE DATE:** May 15 2024  
**PAGE:** 14 of 14

**NOTE:**

Test uncertainties not reported are at client's disposal, for those in which it is possible to evaluate or estimate the test uncertainty. The statement of conformity is based on a 95% coverage probability for the expanded uncertainty of the measured result (guard band):

## Rule 1:

For any requirement state to be "Maximum"

PASS - The measured result is below a specification limit minus guard band.

INCONCLUSIVE - The measured result is inside the guard band and below the specification limit and the measured result is above the specification limit but below the specification limit added to the guard band.

FAIL - The measured result is above a specification limit added to the guard band.

DATA - There is no specification limit required which is not possible to state the conformity.

## Rule 2:

For any requirement state to be "Minimum"

PASS - The measured result is above a specification limit plus guard band.

INCONCLUSIVE - The measured result is inside the guard band and above the specification limit and the measured result is below the specification limit but above the specification limit added to the guard band.

FAIL - The measured result is below a specification limit minus guard band.

DATA - There is no specification limit required which is not possible to state the conformity.

## Rule 3:

For any requirement state to be "a range (Between Upper to Lower specification limit)"

PASS - The measured result is within a range of upper and lower acceptance limit.

INCONCLUSIVE - The measured result is inside the guard band at either side of specification limits

FAIL - The measured result is outside a specification limit minus/added to the guard band.

DATA - There is no specification limit required which is not possible to state the conformity.

## Rule 4:

For any test based on subjective grading of results by using 9-point scale

PASS - The measured result is above specification limit.

FAIL - The measured result is below a specification limit.

DATA - There is no specification limit required which is not possible to state the conformity.

**If there is question or concern regarding the above results, please contact the appropriate lab person below:**

**Contact:** Qiu Dan, Vanna

**TEL:** (86)769 8112 0818 Ext.707

**Email:** [Vanna.Qiu@cpt.eurofinscn.com](mailto:Vanna.Qiu@cpt.eurofinscn.com)

*This test report is governed by the Terms and Conditions, available on request or attached to the end of this test report. Attention is especially drawn to the limitations of liability, indemnification and jurisdictional provisions defined therein. This report is issued strictly based on the testing of the samples submitted by you. The test results in this report refer only to the sample(s) actually tested and do not refer or be deemed to refer to any bulk production from which such sample(s) may be said to have been obtained. In the event that Modern Testing Services (Dongguan) Limited ("ERF") was requested to survey and test any bulk production quantity of samples, ERF, in the absence of any contrary written instructions, performed random sampling of bulk production for testing purposes. Variations in the conditions under which samples are stored, transported, etc., may lead to variations in the test results. ERF cannot anticipate and shall not be held responsible for variations in test results that may be due to factors beyond ERF's control, such as, sample cross-contamination, evaporation of volatile substances due to storage temperature, humidity, etc. This report does not constitute a recommendation, actual or implied, for any specific course of action. Other than the expressed warranties made in the Terms and Conditions of the ERF Test Request Form, ERF makes no warranties or representations either express or implied with respect to this report. In no circumstances whatsoever shall ERF be liable for any consequential, special or incidental damages arising out of, or in connection with this report.*