

PART LIST



Rear wheel



Mainframe



Knee pad



Bag

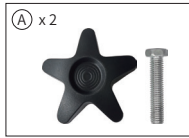

(A) x2
Star bolt / Screw

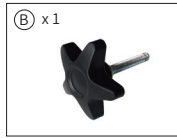

(B) x1
Star screw



(C) x2
Bag screw

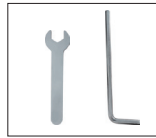

Installation tool

1 STEP

ROLLATORS POLE INSTALLATION

Open the mainframe and lock the lever
If you find the frame is unsteady, please tighten the screw



2 STEP

REAR WHEELS INSTALLATION

1. Insert the rear wheels into the mainframe and make sure the holes are aligned
2. Insert the screw into the hole and secure the "star bolt"

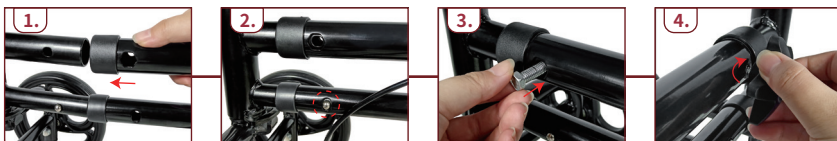

3 STEP

LIFTING LEVER INSTALLATION

1. Insert the lifting lever into the mainframe
2. Adjusting the suitable height, then make sure the holes are aligned
3. Insert the star bolt into the hole and tighten it
4. Attach the Card buckle to the lifting rod



4 STEP

KNEE PAD INSTALLATION

1. Insert the knee pad into the tube
2. Adjusting the suitable height, then make sure the holes are aligned
3. Insert the screw into the hole and secure the star bolt



5 STEP

BAG INSTALLATION

Make sure the holes are aligned, then insert the screw into the hole and secure the nut with a tool,

