

ASSEMBLY INSTRUCTION

ITEM: WF311245/WF311246

Important note:

1. Place all wooden parts on a clean and smooth surface such as a rug or carpet to avoid scratching the parts.
2. Kindly follow the assembly instructions step by step.
3. Do not tighten all screws and bolts until the table is fully assembled.
4. Unscrew the protective plastique supports from the metal insert of the table legs before assembly.

PARTS IDENTIFICATION

A Table Top

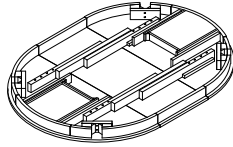

1pc

B Table Leg

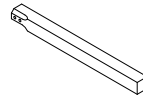

4pcs

HARDWARE IDENTIFICATION

1 Bolt

Ø5/16"x60mm



8pcs

2 Spring Washer

Ø5/16"x13mm



8pcs

3 Flat Washer

Ø5/16"x19mm



8pcs

4 Allen Key

M4

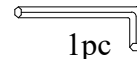

1pc

STEP 1

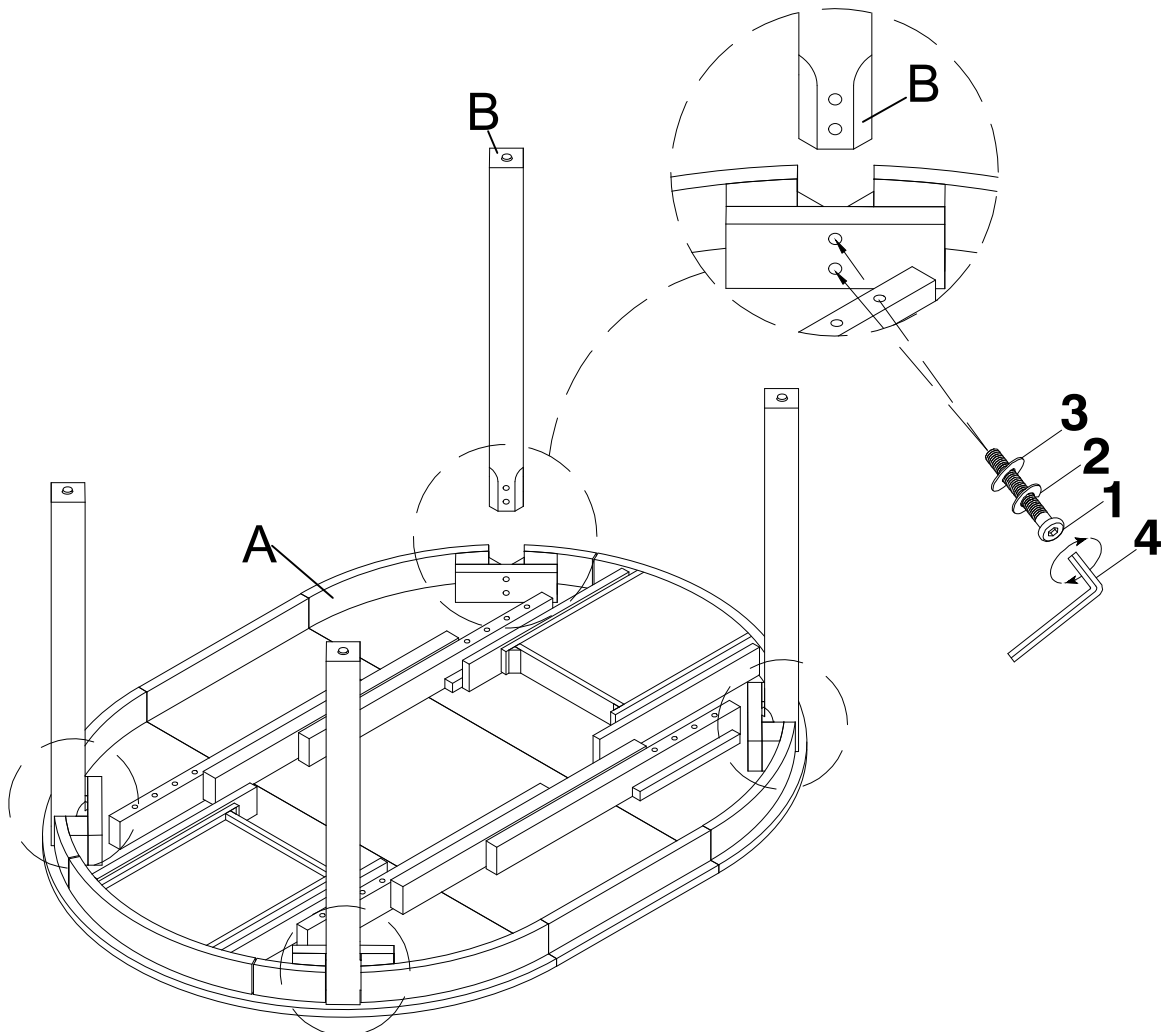

ASSEMBLY INSTRUCTION
ITEM: WF311245/WF311246

STEP 2

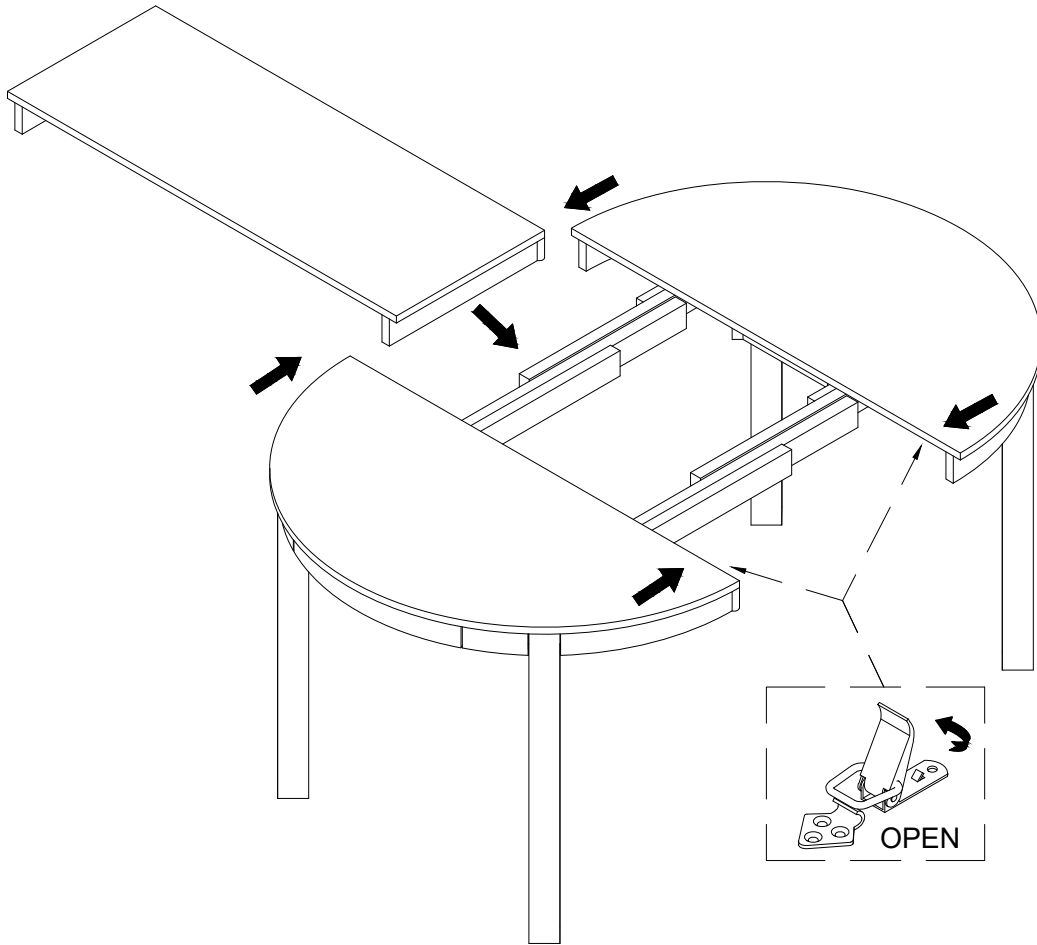

COMPLETE

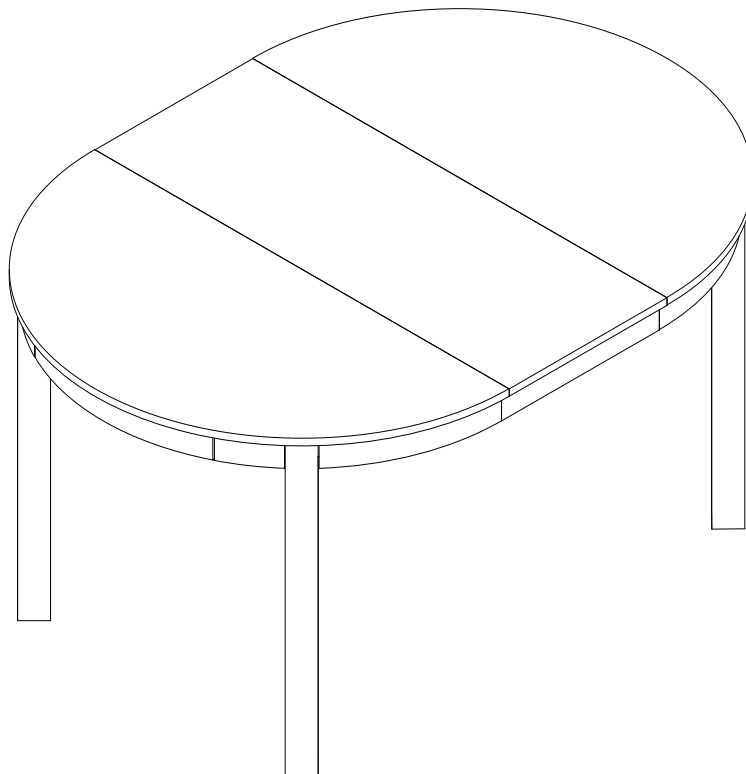

ASSEMBLY INSTRUCTION

ITEM: WF311247

Important note:

1. Place all wooden parts on a clean and smooth surface such as a rug or carpet to avoid scratching the parts.
2. Kindly follow the assembly instructions step by step.
3. Do not tighten all screws and bolts until the table is fully assembled.
4. Unscrew the protective plastique supports from the metal insert of the legs before assembly.

PARTS IDENTIFICATION

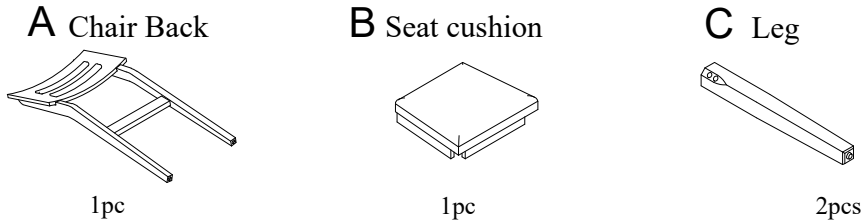

HARDWARE IDENTIFICATION

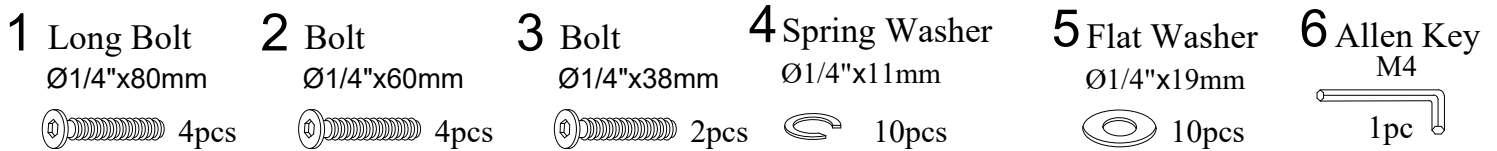

STEP 1

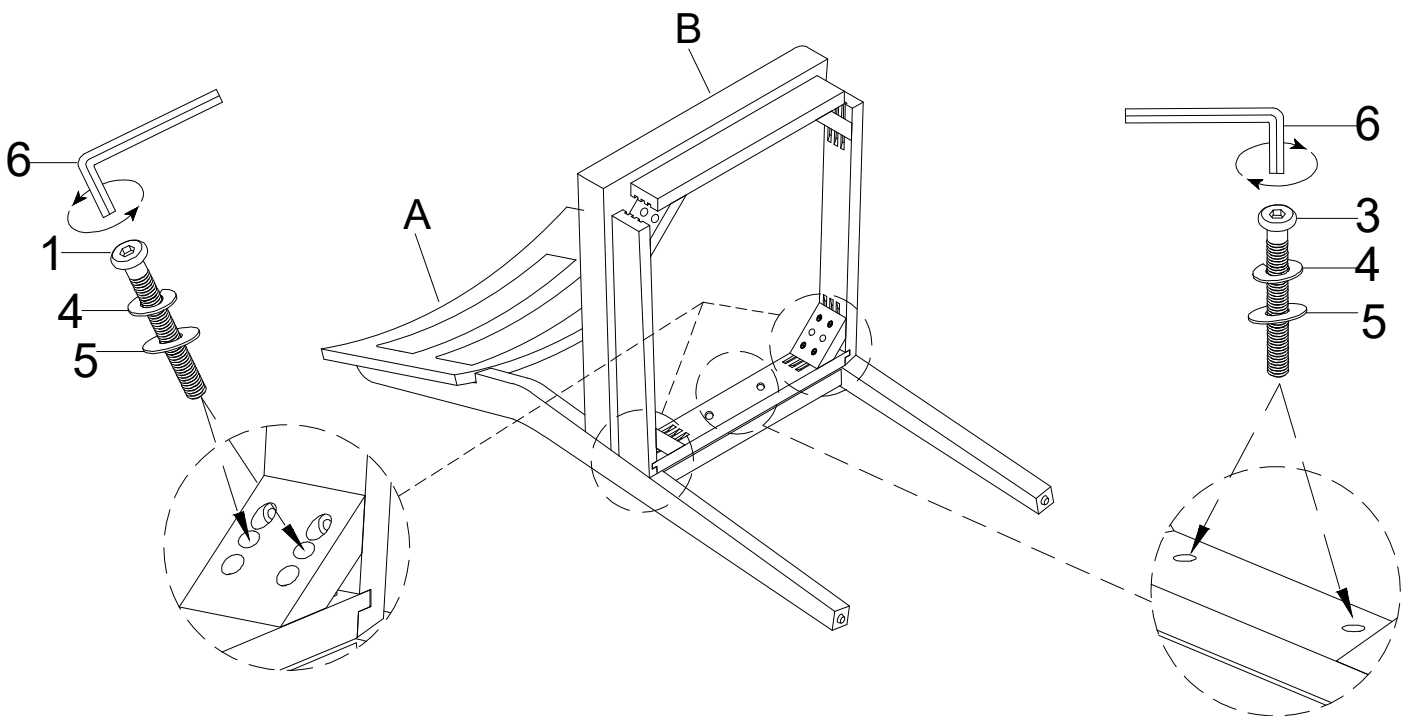

ASSEMBLY INSTRUCTION
ITEM: WF311247

STEP 2

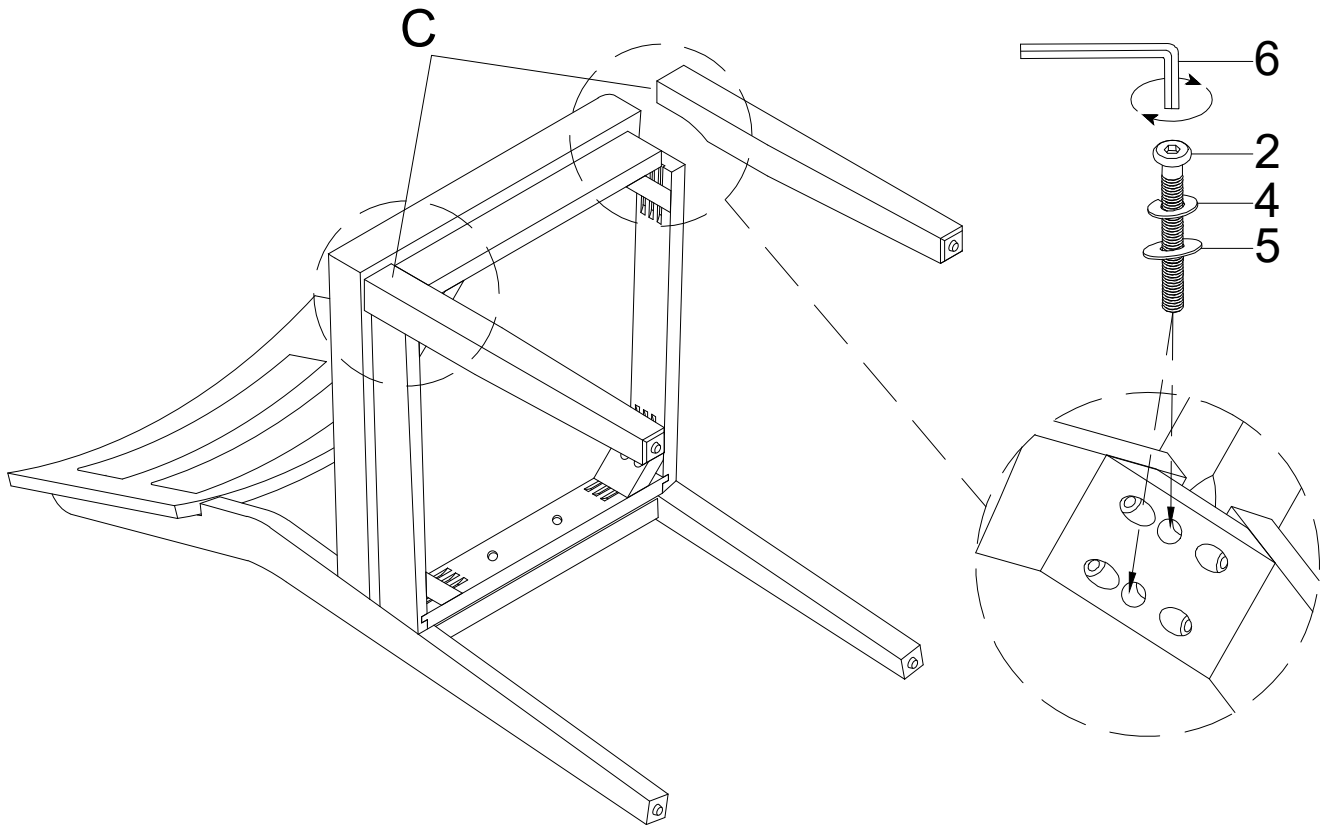

COMPLETE

