

Assembly Instruction

Please check that you have all the parts listed before you start assembling,if you do find that something is missing,do not continue assembly,please contact us immediately.

NOTE:Please do not completely tighten all the hardware until the entire assembly is complete!

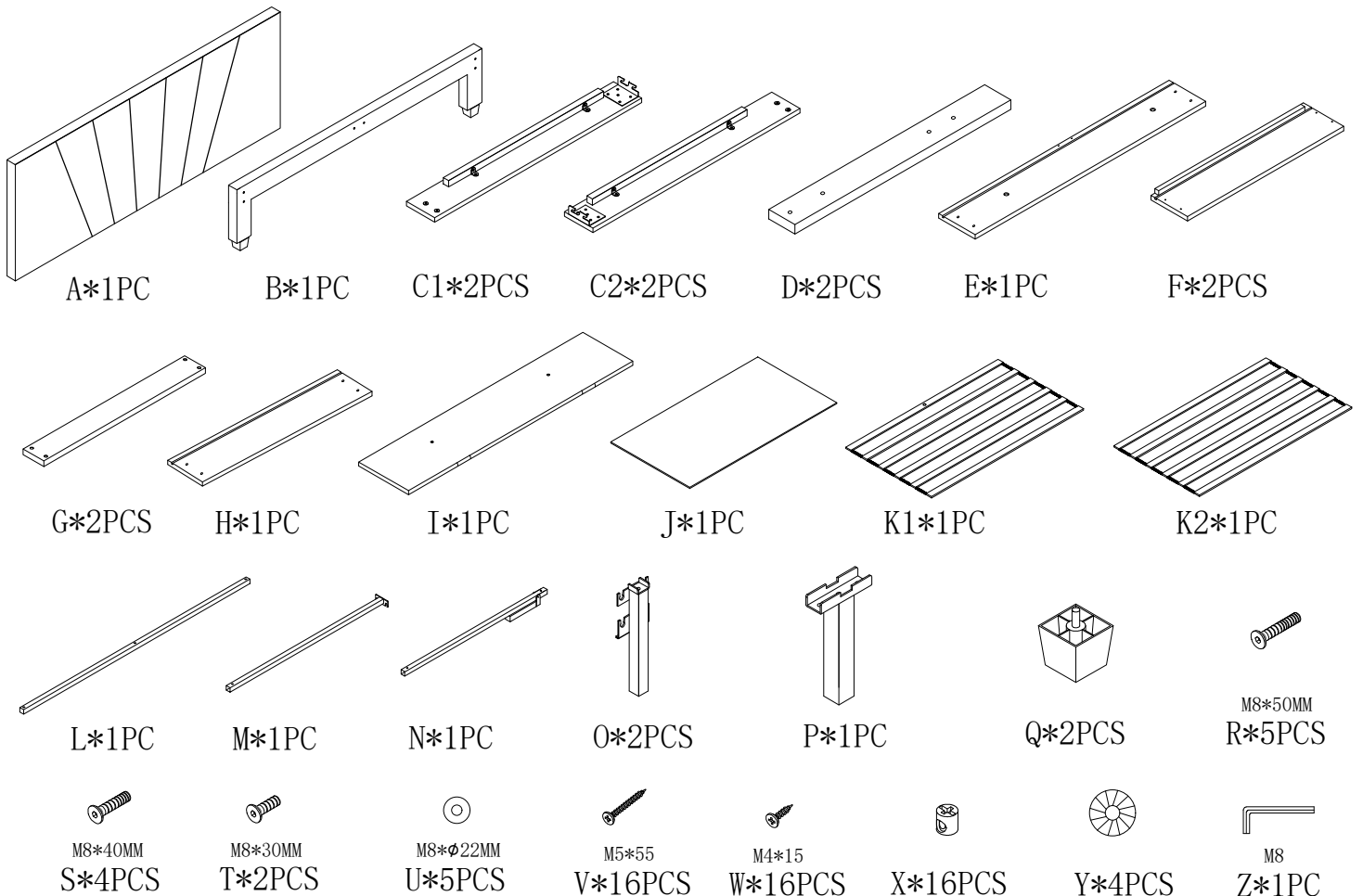
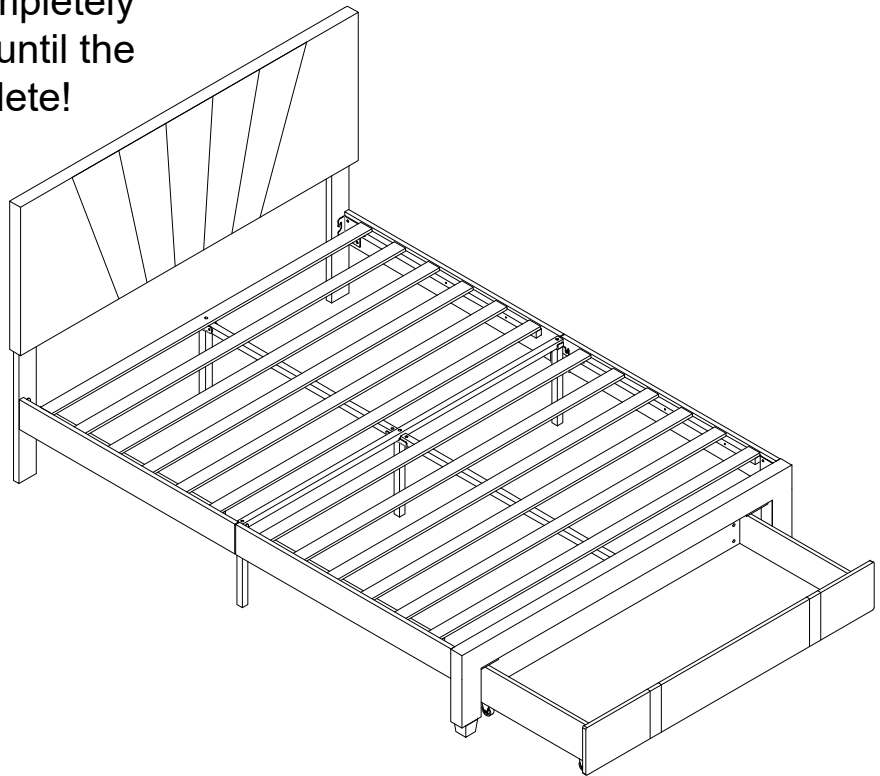

step1

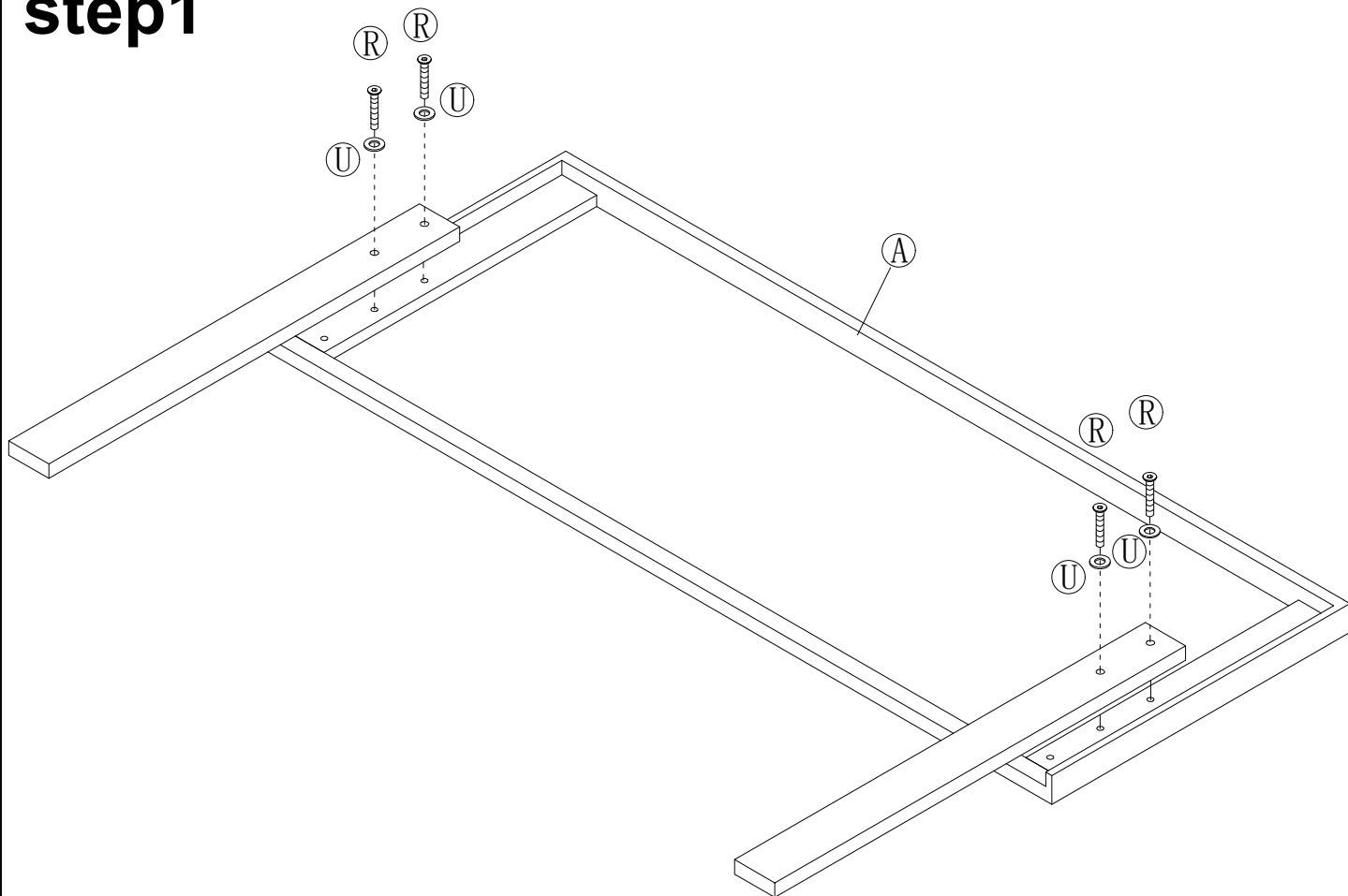

step2

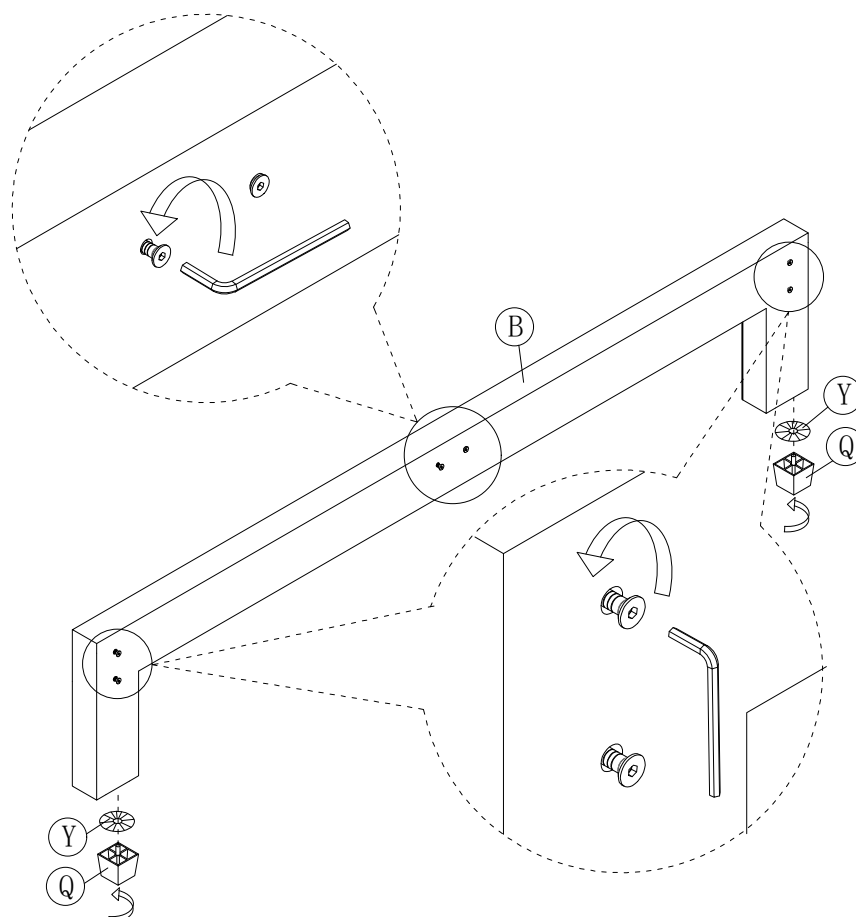

Loosen the pre locked screws and lock it.

step3

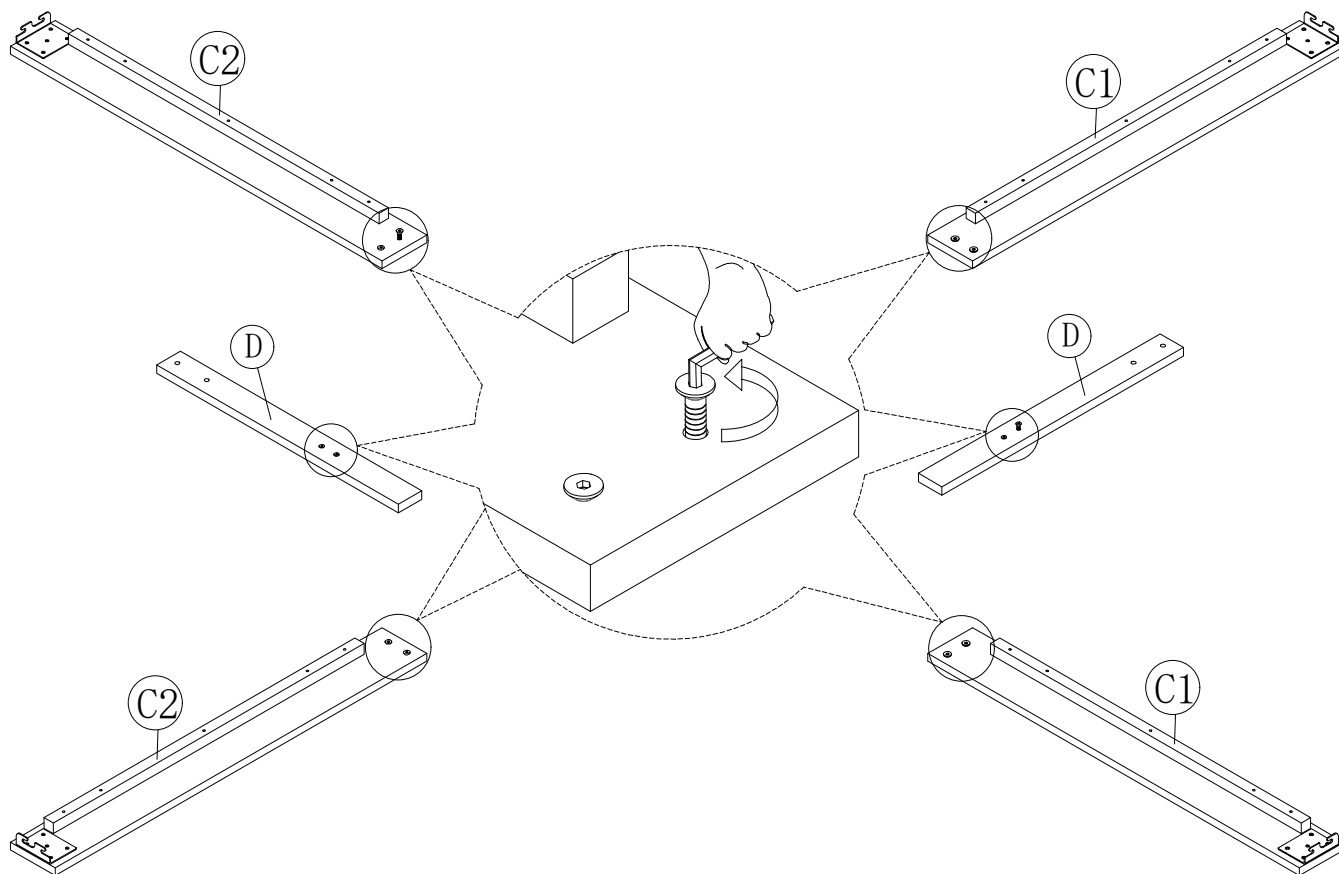

Loosen the pre locked screws.

step4

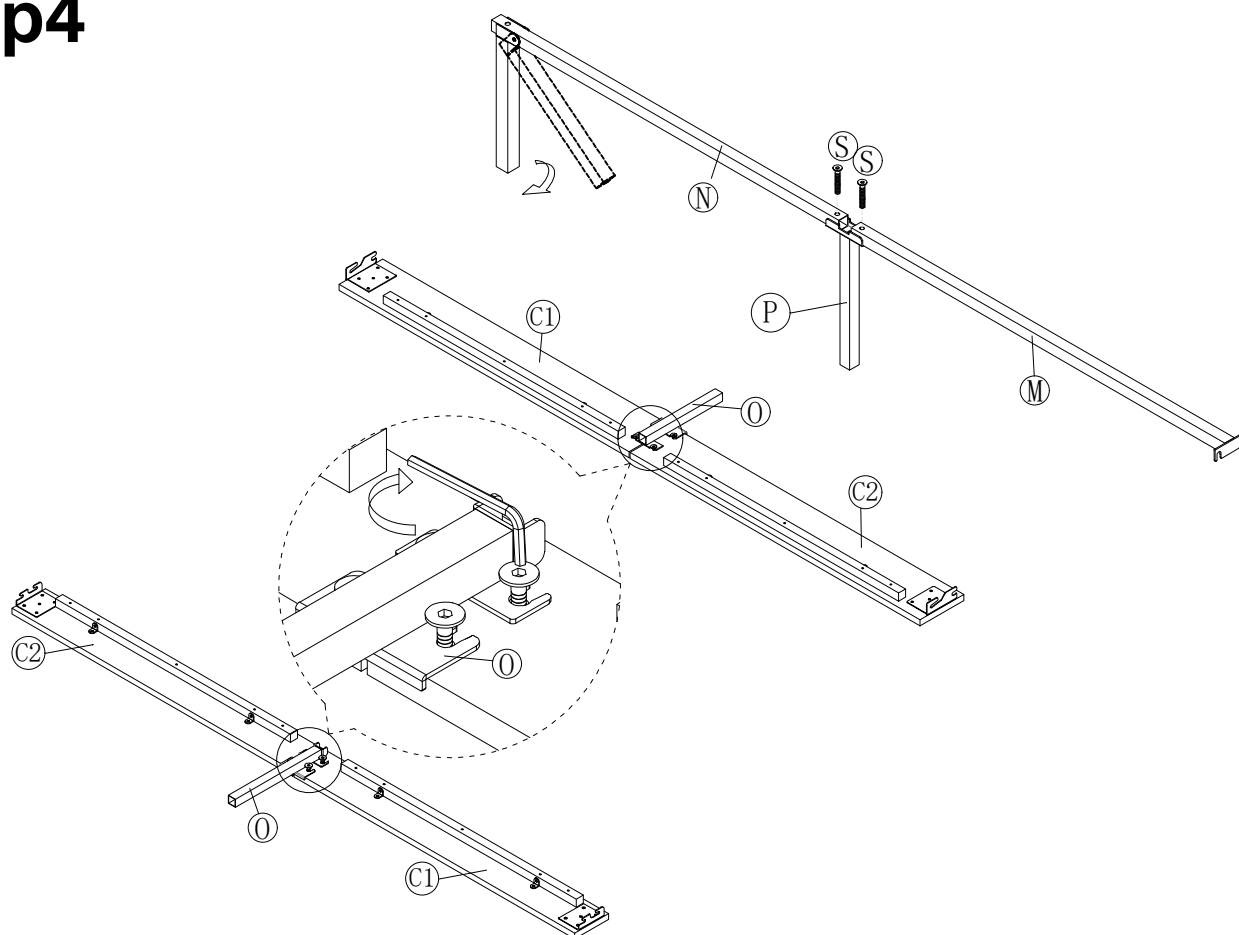

Put the part "O" on part "C1" and part "C2".

step5

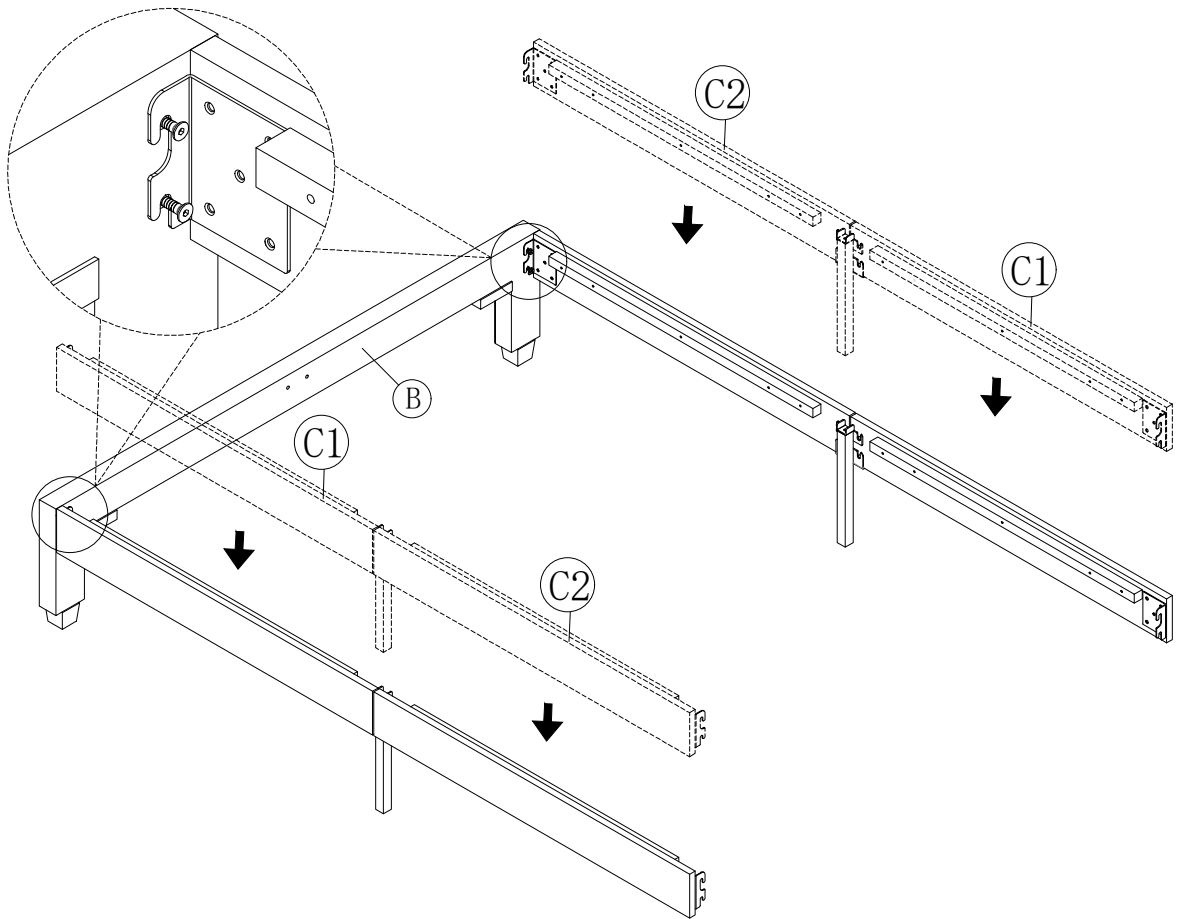

Put the part "C1"and"C2"on part "B".

step6

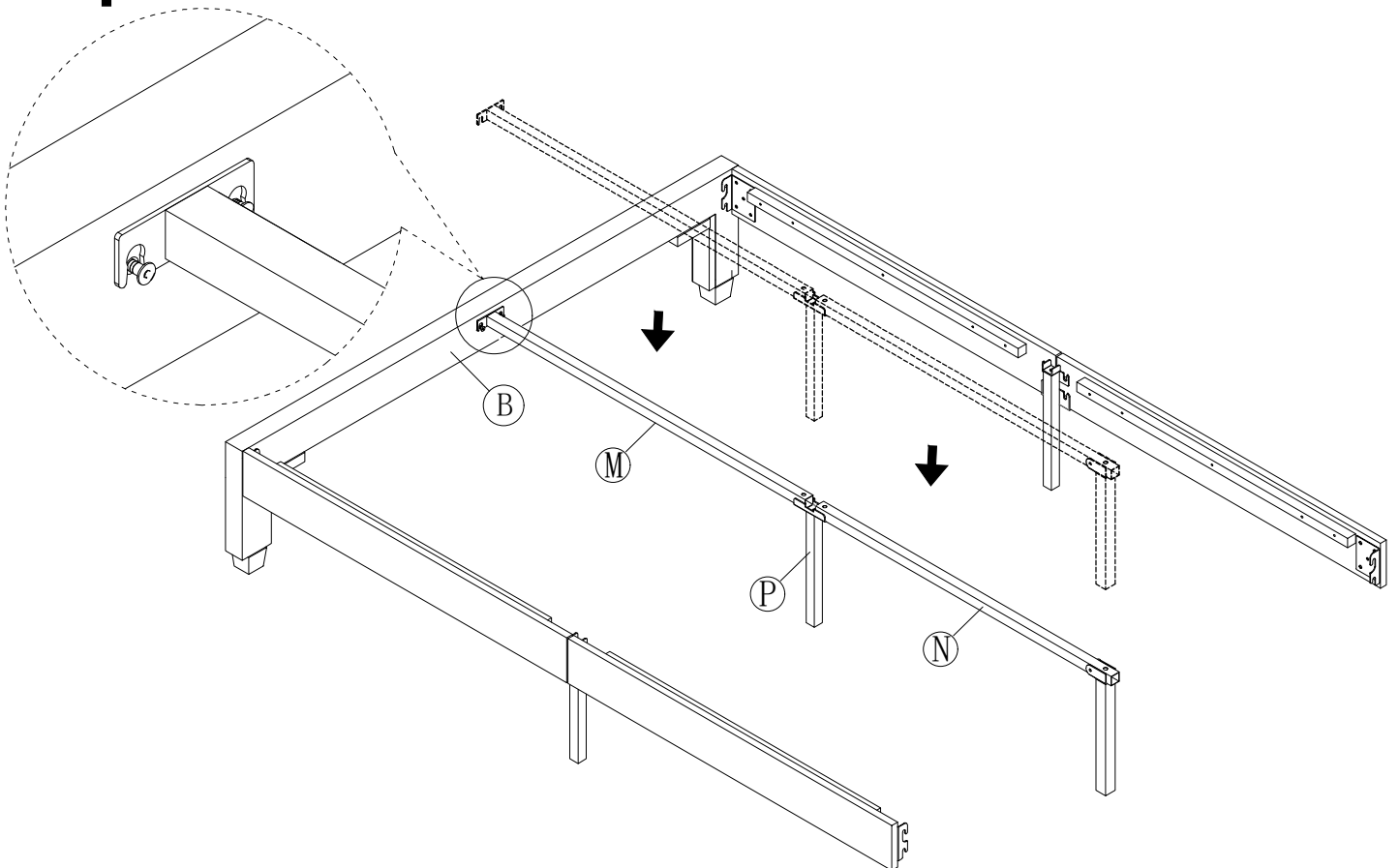

Put the part "M"on part "B".

step7

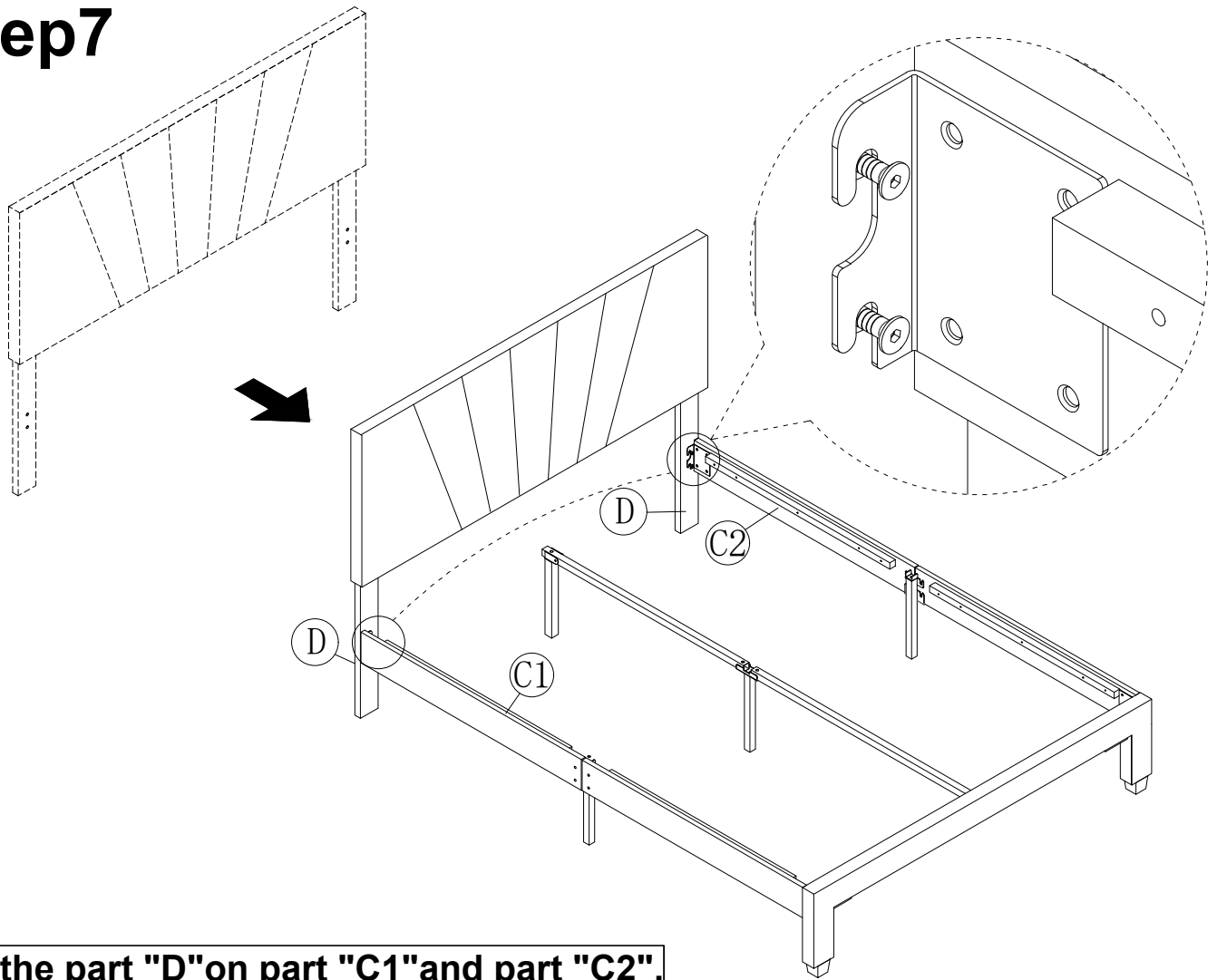

Put the part "D" on part "C1" and part "C2".

step8

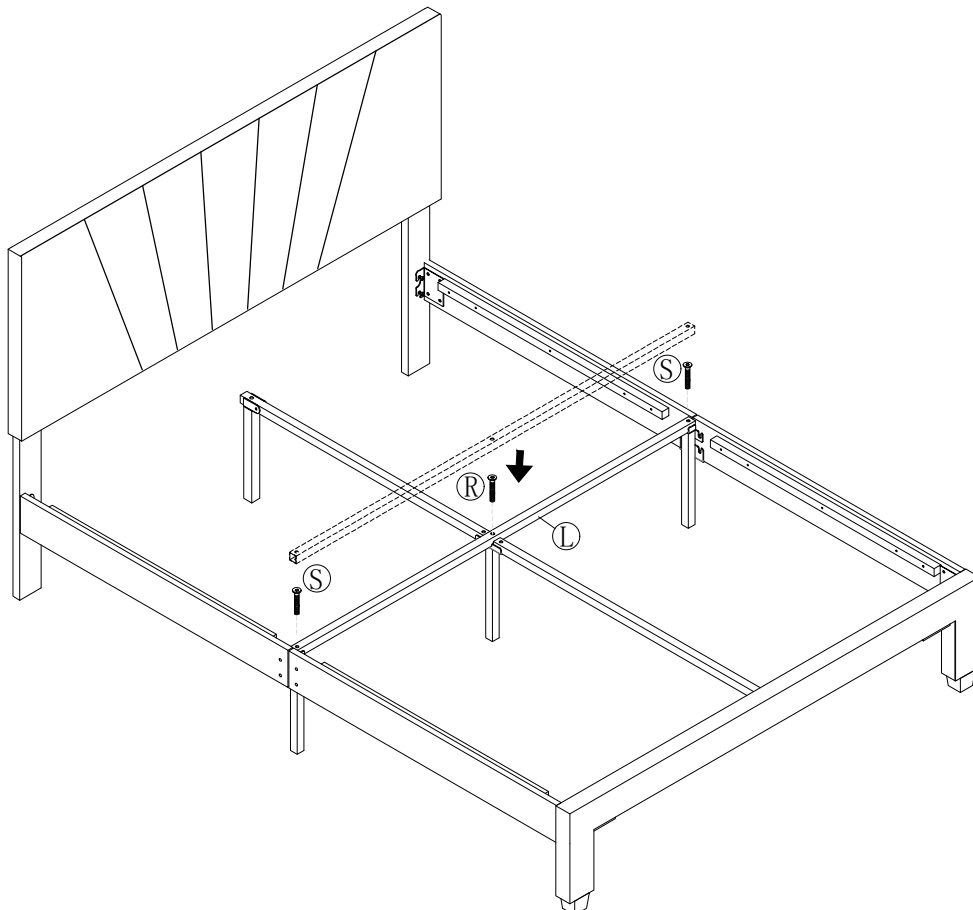

Then tighten all the pre -locked screws.

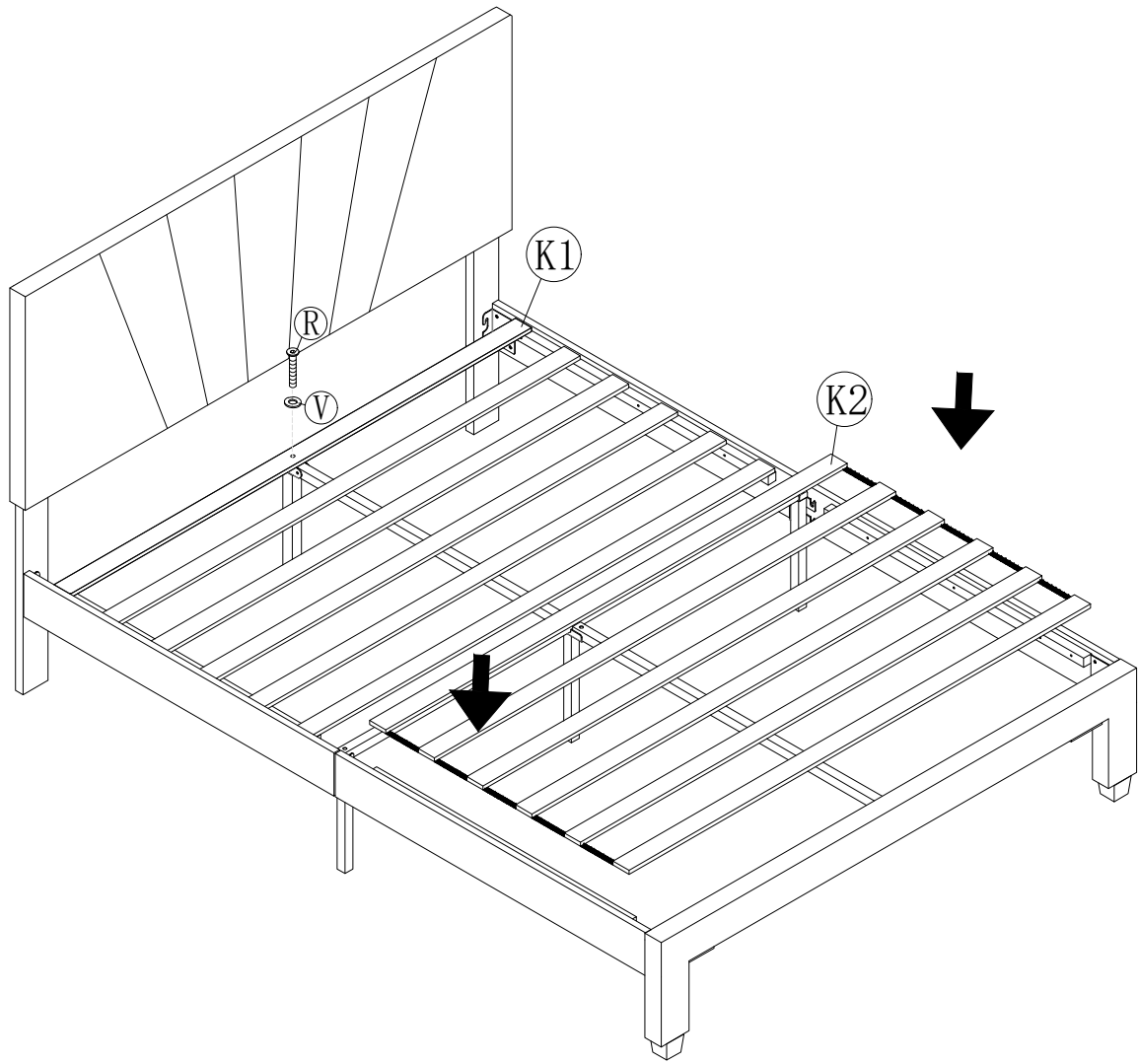

step9

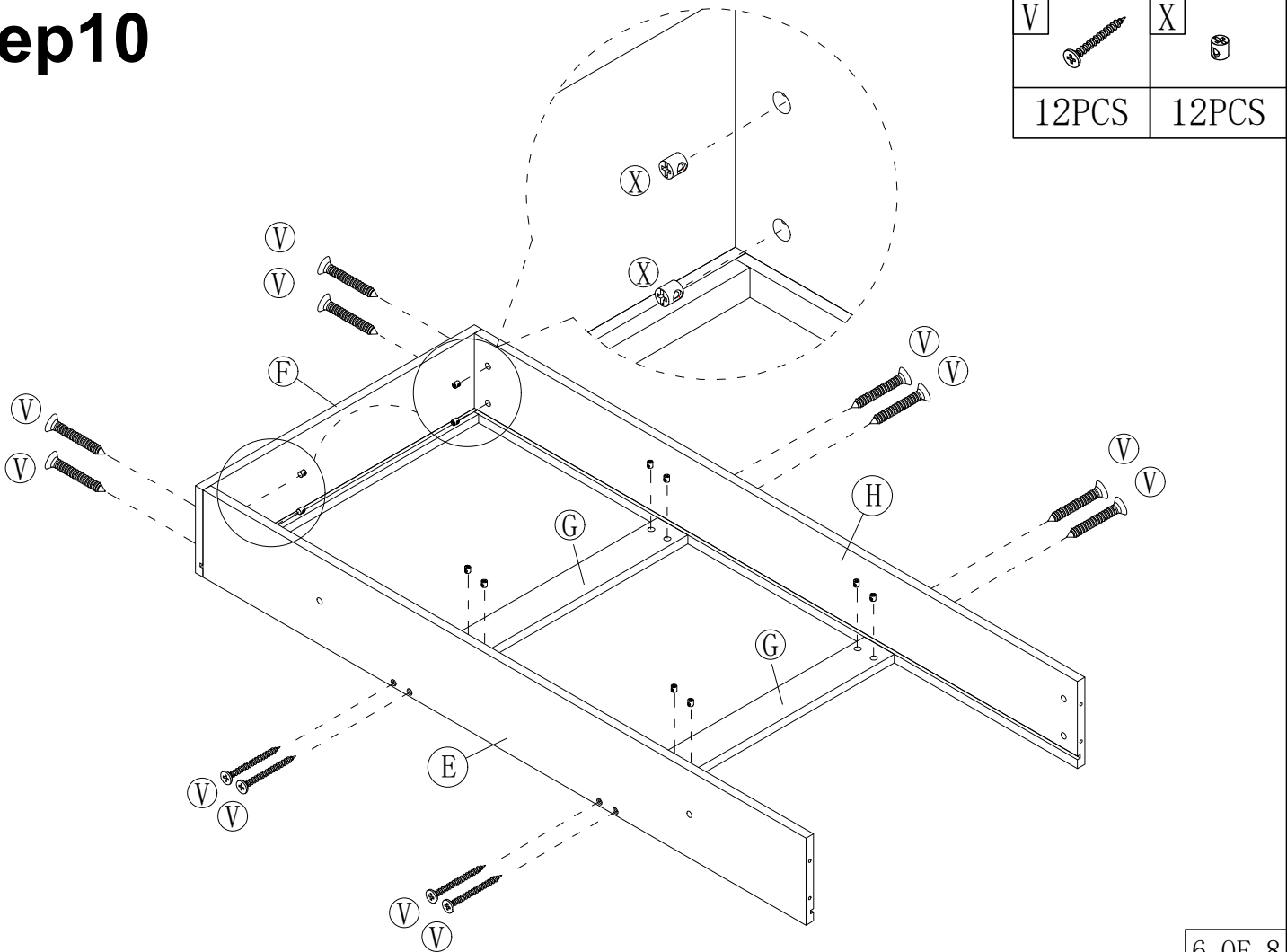

step10



step11

V		X	
4PCS		4PCS	

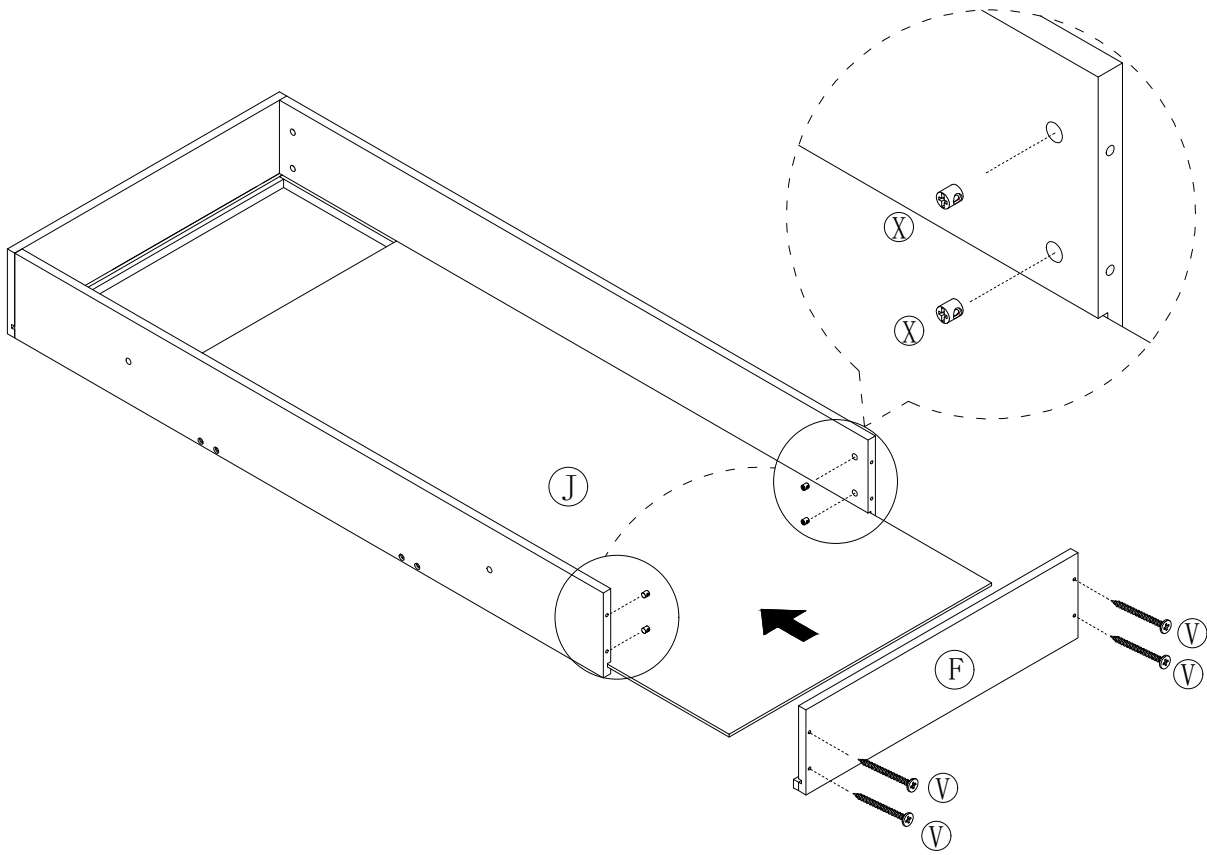

step12

W	
16PCS	

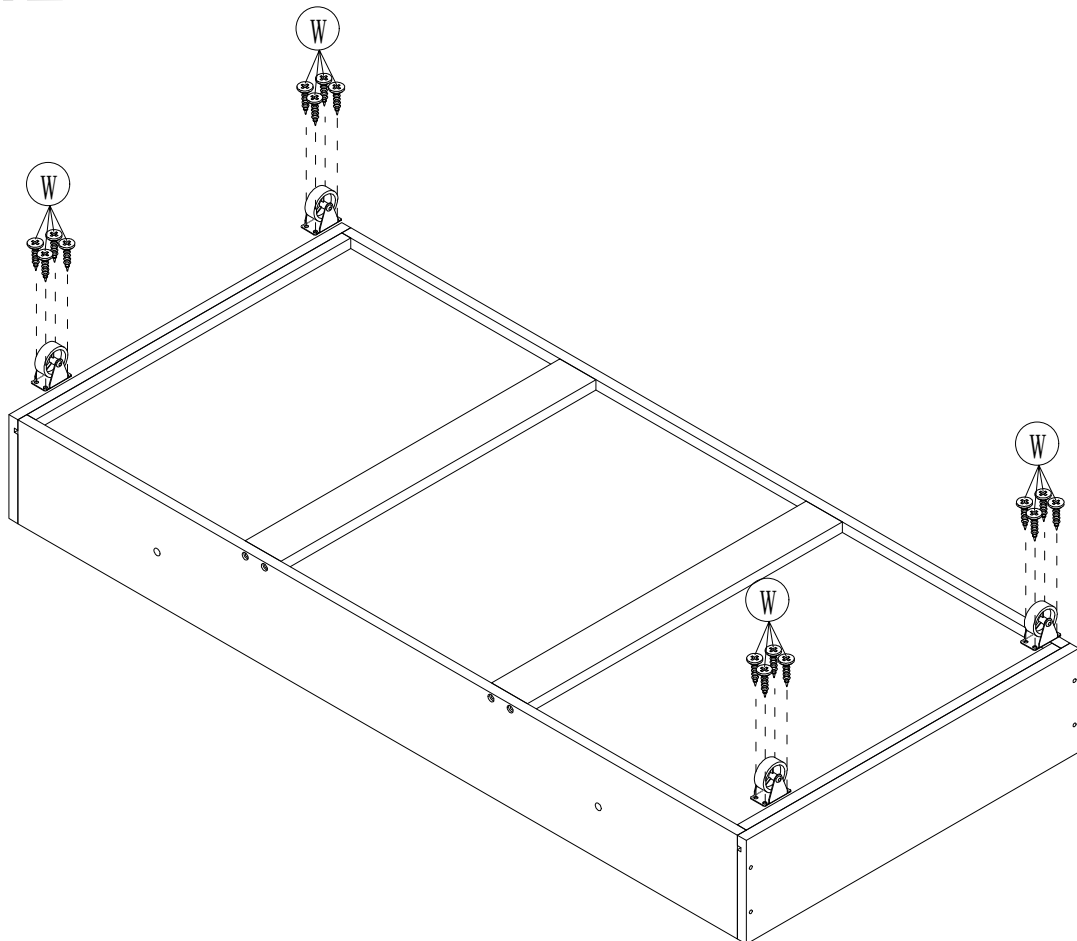

step13

T



2PCS

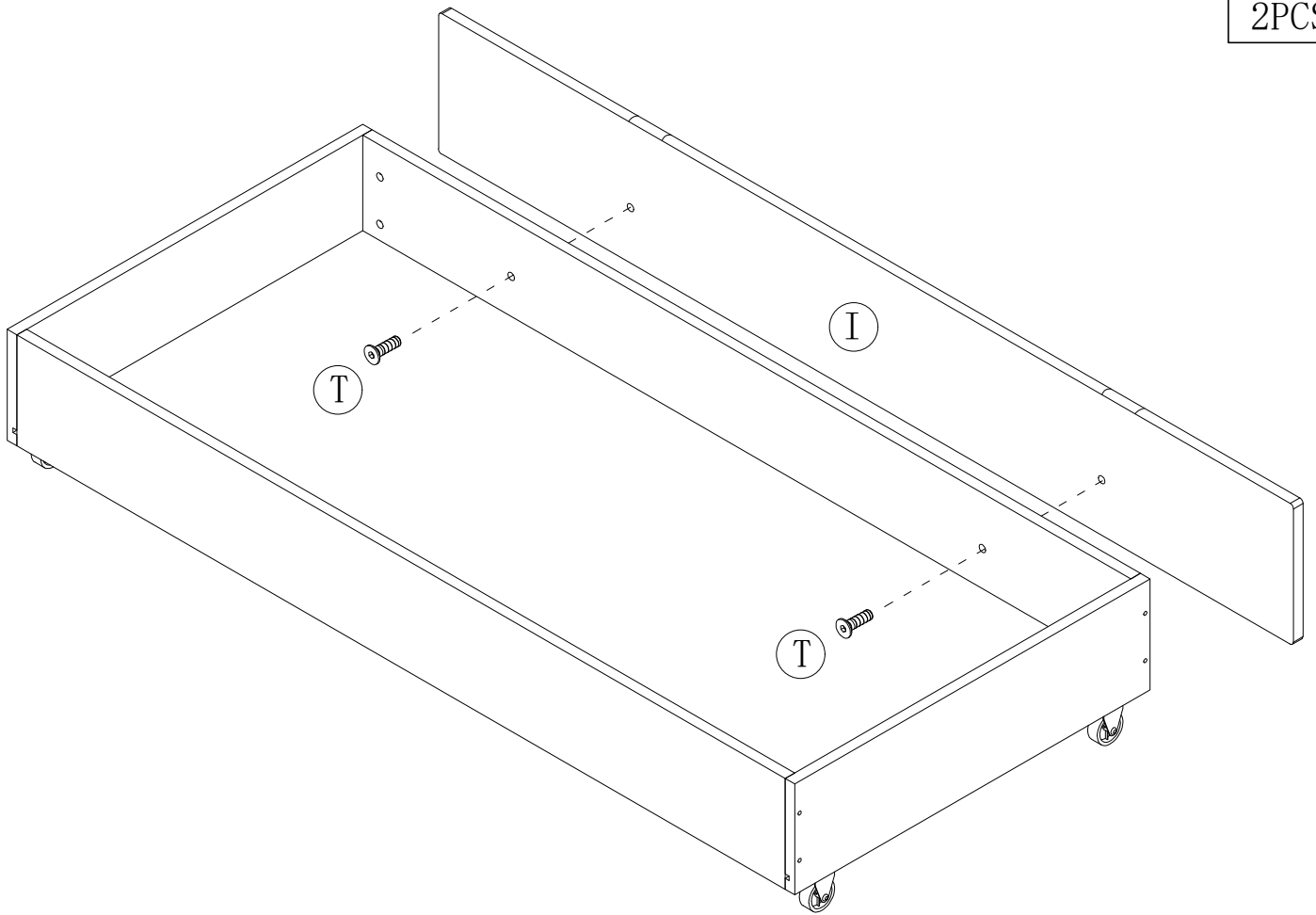

step14

