

# ASSEMBLY INSTRUCTIONS

## DINING TABLE

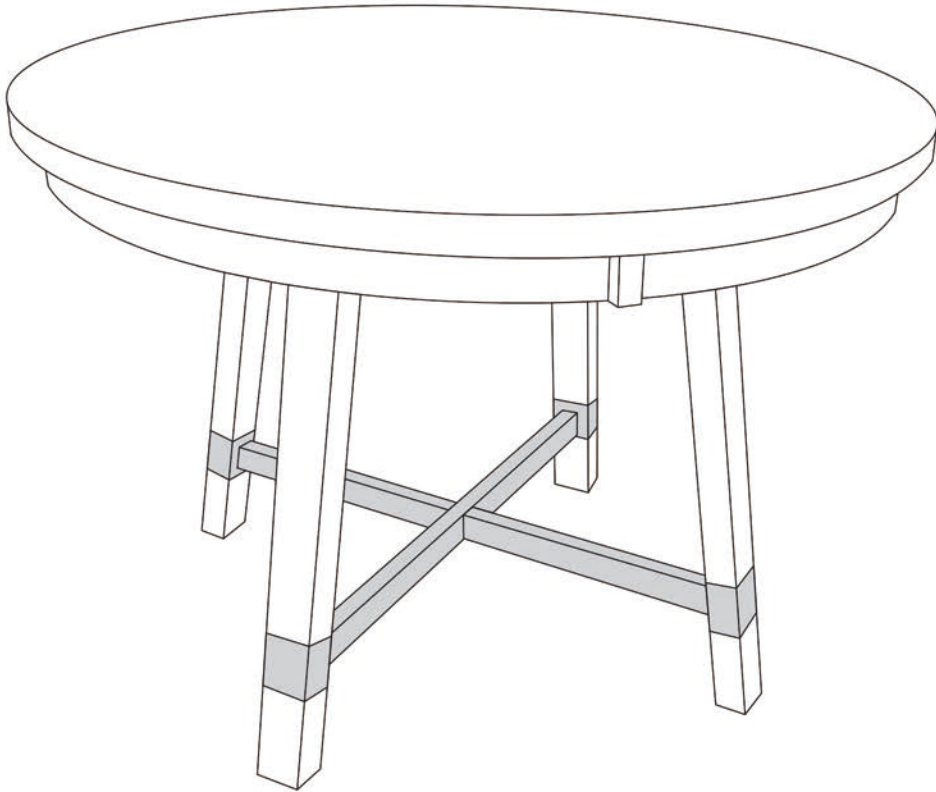

WF309185

### IMPORTANT NOTE:

- PLACE ALL PARTS ON A CLEAN AND SMOOTH SURFACE SUCH AS A RUG OR CARPET TO AVOID THE PARTS FROM BEING SCRATCHED.
- BEFORE YOU BEGIN, KINDLY FOLLOW THE ASSEMBLY INSTRUCTIONS STEP BY STEP.
- DO NOT TIGHTEN ALL SCREWS AND BOLTS UNTIL THE TABLE IS FULLY SET-UP.

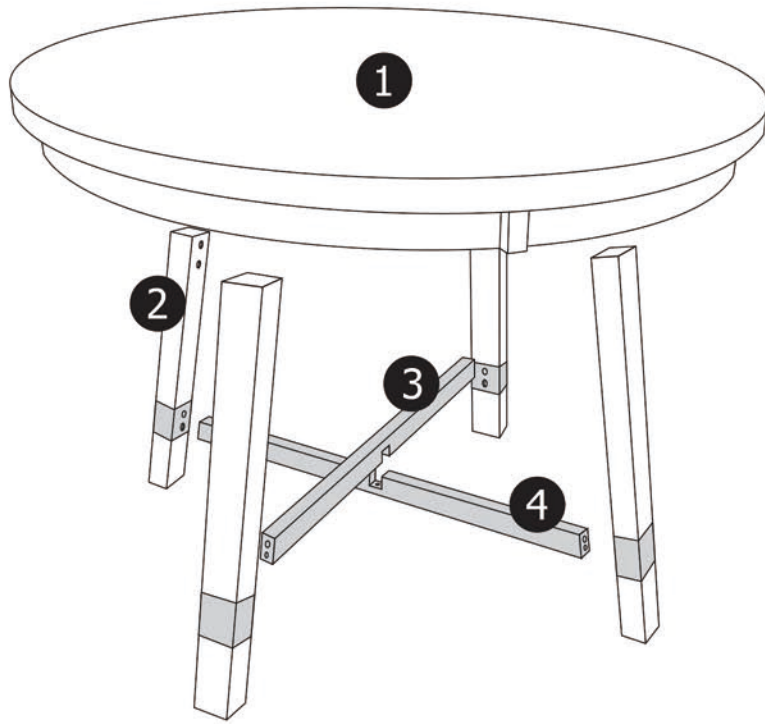

WF309185

CARTON CONTENT:

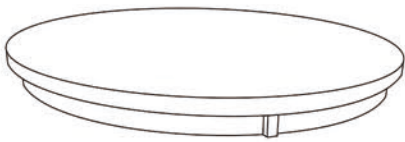

1 x 1

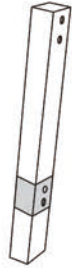

2 x 4

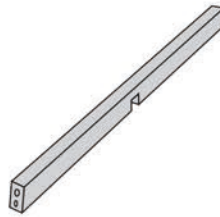

3 x 1

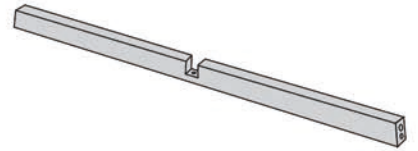

4 x 1

TABLE PART LISTS

NO.	DESCRIPTION	SKETCH	QTY
1	TABLE TOP		1PC
2	LEG		4PCS
3	UPPER STRETCHER		1PC
4	BOTTOM STRETCHER		1PC

TABLE HARDWARE LISTS

NO.	DESCRIPTION	SKETCH	QTY
A	JCBC SCREW M6 X 60MM		12PCS
B	JCBC SCREW M6 X 30MM		1PC
C	SPRING WASHER M6 X 18MM		8PCS
D	FLAT WASHER M6 X 18MM		8PCS
E	SPRING WASHER M6 X 13MM		1PC
F	FLAT WASHER M6 X 13MM		1PC
G	WOOD DOWEL 12 X 40MM		4PCS
H	LEG ADJUSTER		4PCS
I	ALLEN KEY M4 X 65		1PC

### STEP 1

Place the Table Top (1) on a flat & soft surface to prevent scratches.

Then, attach the Leg (2) to the Table Top (1).

Secure the 4 legs using JCBC screw M6 x 60mm (A), spring washer (C) & flat washer (D). Tighten up with Allen Key (I).

**PLEASE DO NOT FULLY TIGHTEN THE SCREWS UNTIL FINAL STEP.**

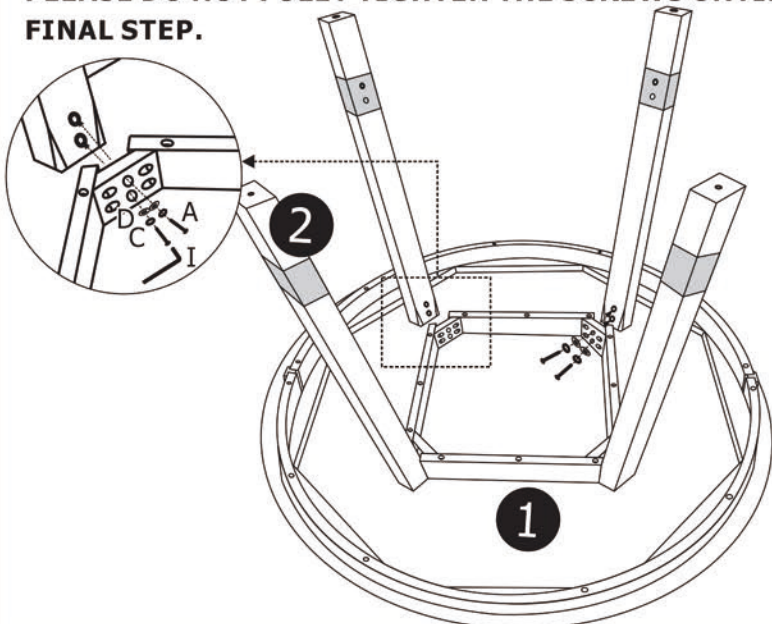

### STEP 4

Secure the center of the two Stretcher (3 & 4) using JCBC screw M6 x 30mm(B), Spring washer (E) & Flat washer (F). Tighten up with Allen Key (I).

**FULLY TIGHTEN UP ALL THE SCREWS AT THIS TIME.**

Finally, fix the Leg adjuster (H) to the Leg Frame (2) and twist it to balance the leg frame to the floor.

Turn the table back onto its legs - You will need two people to do this.

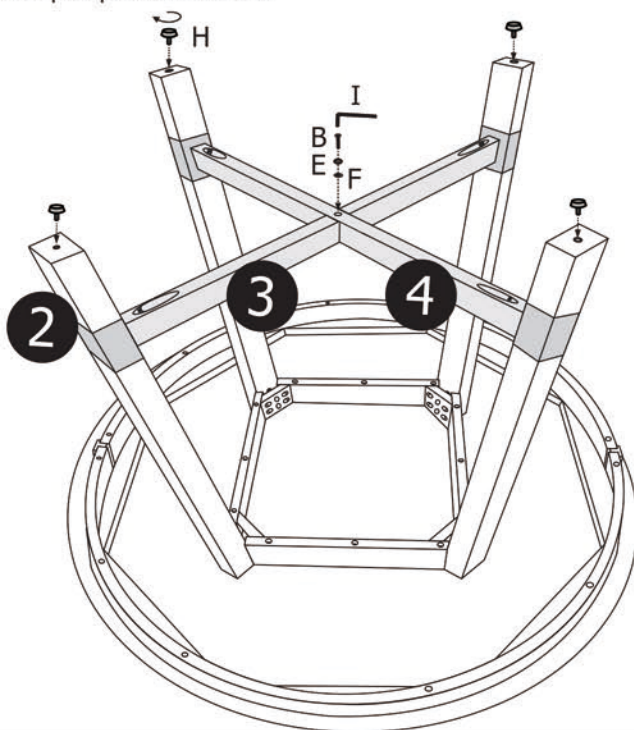

### STEP 2

Insert the wooden dowel (G) to the Stretcher (3 & 4) and slightly tap with rubber mallet.

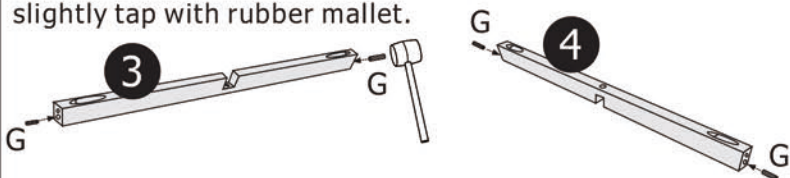

### STEP 3

Attach the Stretcher (3 & 4) to the assembled Leg (2) using JCBC screw M6 x 60mm(A). Tighten up with Allen Key (I).

**PLEASE DO NOT FULLY TIGHTEN THE SCREWS UNTIL FINAL STEP.**

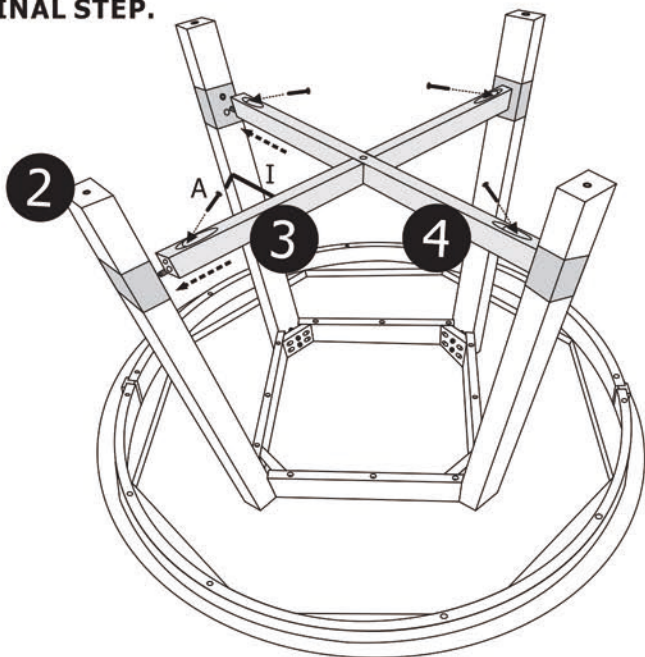

**ASSEMBLY COMPLETE!**





# ASSEMBLY INSTRUCTIONS

## DINING CHAIR

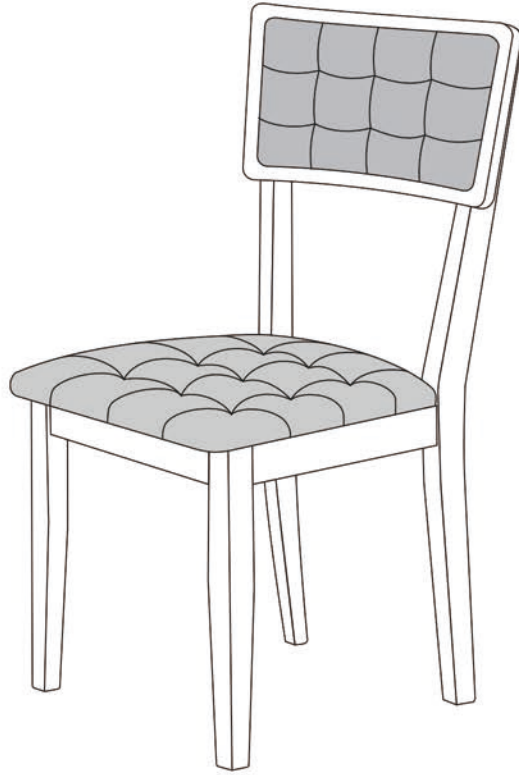

WF309186

### **IMPORTANT NOTE:**

- PLACE ALL PARTS ON A CLEAN AND SMOOTH SURFACE SUCH AS A RUG OR CARPET TO AVOID THE PARTS FROM BEING SCRATCHED.
- BEFORE YOU BEGIN, KINDLY FOLLOW THE ASSEMBLY INSTRUCTIONS STEP BY STEP.
- DO NOT TIGHTEN ALL SCREWS AND BOLTS UNTIL THE CHAIR IS FULLY SET-UP.

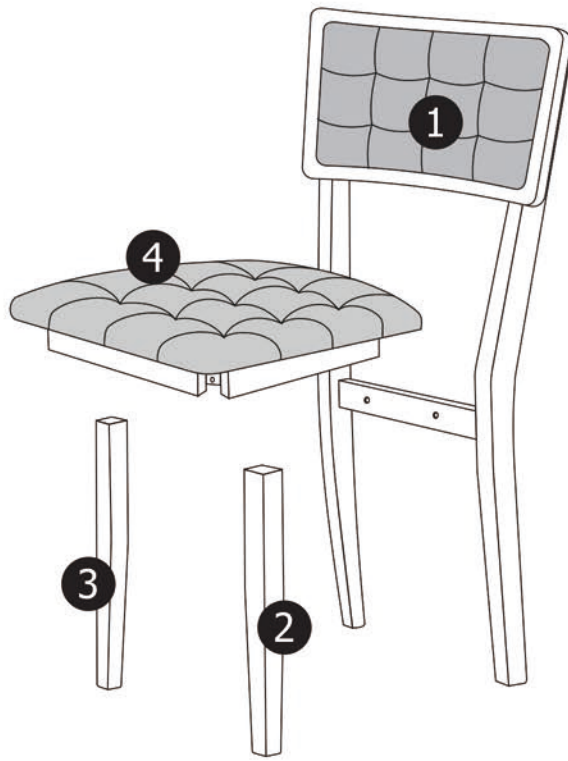

WF309186

**CARTON CONTENT:**



① x 4



② x 4



③ x 4

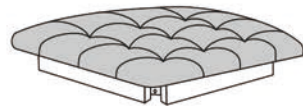

④ x 4

**CHAIR PART LISTS**

NO.	DESCRIPTION	SKETCH	QTY
1	CHAIR BACK		4PCS
2	FRONT LEG (R)		4PCS
3	FRONT LEG (L)		4PCS
4	BOX SEAT		4PCS

**CHAIR HARDWARE LISTS**

NO.	DESCRIPTION	SKETCH	QTY
A	JCBC SCREW M6 X 70MM		16PCS
B	JCBC SCREW M6 X 60MM		16PCS
C	JCBC SCREW M6 X 35MM		8PCS
D	SPRING WASHER M6 X 13.5MM		40PCS
E	FLAT WASHER M6 X 18MM		40PCS
F	ALLEN KEY M4 X 25 X 65		1PC

### STEP 1

Place the Chair Back(1) on a flat & soft surface to prevent scratches.

Attach the Box Seat (4) to the Chair Back(1).

Secure from the center using flat washer(E), spring washer(D) & JCBC screw M6 x 35mm(C).

Secure the 2 corners using flat washer(E), spring washer(D) & JCBC screw M6 x 70mm(A). Tighten up with Allen Key(F).

**PLEASE DO NOT FULLY TIGHTEN THE SCREWS UNTIL FINAL STEP.**

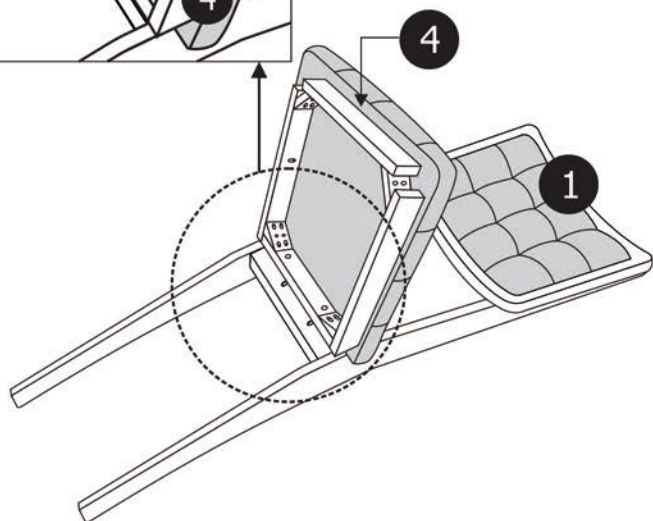
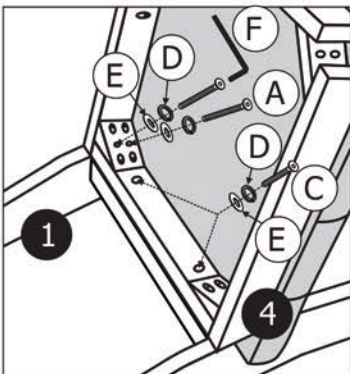

### STEP 2

Attach Front Legs(2 & 3) to the assembled chair back (1) with box seat(4) by using flat washer(E), spring washer(D) and JCBC screw M6 x 60mm(B). Only **SLIGHTLY** tighten by Allen Key(F) to ensure they are not falls out.

Then make sure all the legs are level. Once level, tighten all the screws securely at this stage.

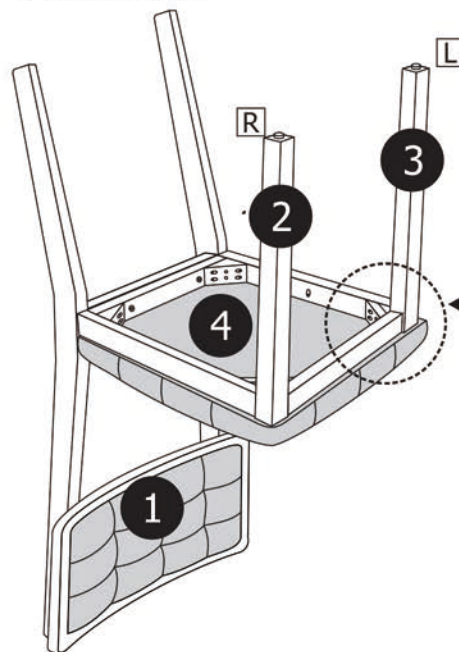
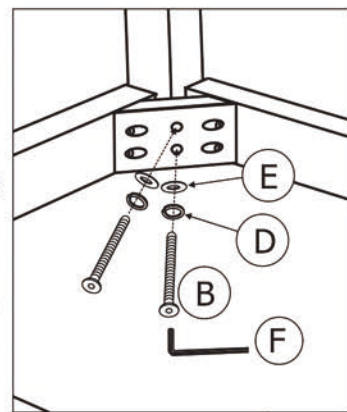

**ASSEMBLY COMPLETE!**

