

Instruction manual

B01 SERIES

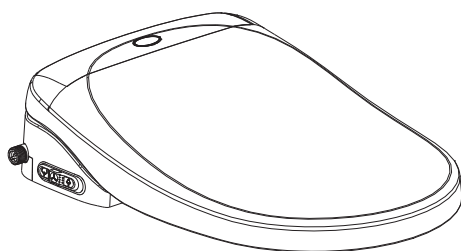

Smart Toilet Seat

Contents

Safety precautions	1-3
Components	4
Specifications	5
Product diagram	6
Power and water connections.....	6
Product functions.....	7
Installation.....	8-9
Components	10-11
Remote control functions	12-13
Side push button instructions.....	14
Remote control installation instructions	15
Removal and maintenance.....	16
Cleaning	17
Nozzle cleaning.....	18
Troubleshooting and alarm maintenance.....	19-20
Maintenance service sheet.....	21



Safety precautions

To prevent damage to the unit and possible injury to users, please follow the safety warnings. Please be sure to carefully read through the user's manual before installation. Keep the user's manual after installation to refer to for troubleshooting advice.

Symbols and meanings

 WARNING	Could result in serious injury or death.
---	--

The following symbols are used to indicate important safety precautions when using the product.

	Prohibited.
	Pay close attention; caution.



WARNING



Prohibited

Stop using the product immediately if you observe:

Smoke

Unusual sound or odor

Leakage, breakage or other damage

Blocked toilet pan

Continued use under these conditions could cause electrical shock, injury, or water leakage.

Do not clean the smart bidet with heavy chemical cleaning agents such as paint thinner, gasoline, putty powder, nylon brush, etc.

Otherwise, it could trigger a chemical reaction, cause leakage, damage to the product or personal injury.

A loose electrical connection could cause electric shock or a fire.

Do not operate the product or handle the plug with wet hands. This may result in electrical shock or a fire.

Handling the plug during thunderstorms and lightning may cause electrical shock.

Make certain to use the proper voltage. Overloading circuits could overheat and cause a fire.

Do not pour liquids onto the electrical components while it is plugged in as this could result in electrical shock or a fire.

Do not stand or place heavy objects on the product, as it can cause damage.

Do not attempt to disassemble or repair this product yourself. It needs to be taken for professional repair. Otherwise, it may result in damage to the product.

If the electrical plug or line is damaged, unplug the product. Do not attempt to fix the outlet and consult a professional.

Do not block the air openings of the product. Keep the air openings free of lint, hair, and the like.

Do not use while bathing.



WARNING



Caution

Make sure the product is installed in a well-ventilated area. Excess humidity and moisture could cause electrical shock or fire.

Disconnect the power supply before removing this product from the toilet to prevent electrical shock or fire.

To prevent electrical shock or fire, disconnect the power supply before cleaning the product and do not apply water directly to it.

Do not expose the product to direct sunlight.

Persons with special health conditions should only use this product with the permission of their doctor. In some instances, supervision or assistance may be necessary when using the product.

Do not use industrial water, wastewater, seawater, reclaimed water and other sewage water. This could cause skin inflammation or other conditions.

Persons (including children) with physical, perceptual, intellectual disabilities or other conditions, need to use the product under the guidance or supervision of someone else, or they may experience electric shock, injury or fire.

All electrical cords and plugs must be waterproof.

The electrical plug must be located more than 0.5m above the floor and away from the bathtub and shower. Otherwise, it could cause electrical shock or a fire.

When replacing an existing bidet toilet seat, remove the old hose assemblies and replace them with the included hose assemblies. Do not reuse the old hose assemblies to avoid safety related problems.

Do not allow children to play with this product. Children must have adult supervision when using the product.

The grounding wire must conform to local codes and must use a three-pronged grounding plug for use.

Components

SMART TOILET SEAT

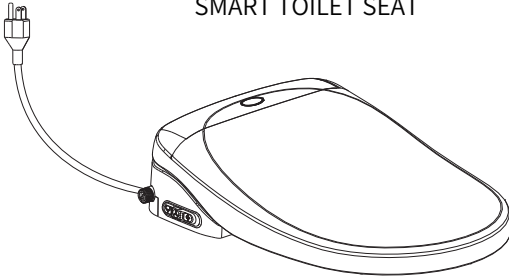

REMOTE CONTROL



REMOTE EXPANSION SCREW GROUP (EACH 2pcs)



REMOTE CONTROL HOLDER

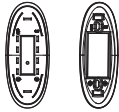

DOUBLE-FACED ADHESIVE TAPE



FAST MOUNTING PLATE

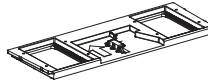

EXPANSION SCREW COMPONENT (EACH 2pcs)

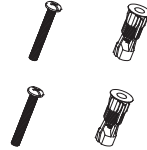

ADJUSTMENT SHEET (2pcs)

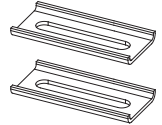

USER'S MANUAL

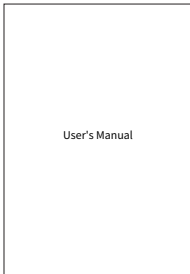

INLET HOSE



T-JUNCTION COMPONENT



Specifications

Rated voltage and rated frequency		110V~ 60Hz			
Length of wire		About 1.5m			
Washing equipment	Water yield	Posterior cleaning	About 0.4 - 0.7L/min(hydraulic pressure of 0.2Mpa)		
		Feminine cleaning			
	Swing cleaning		Swing cleaning back and forth		
	Massage cleaning		Interval cleaning. Powerful cleaning		
	The adjustment of the water gear and nozzle place		5 settings		
	Effluent-water temperature range		About 35°C - 42°C / 95°F - 107.6°F (Top Gear)		
	Safety device		Prevents the circuit from overheating Temperature control switch & Temperature fuse		
Drying device	Drying temperature control		About 32°C - 57°C / 89.6°F - 134.6°F (Top Gear)		
	Safety device		Temperature control switch & Temperature fuse		
Seat cover	Temperature range		About 30°C - 42°C / 86°F - 107.6°F (3 settings)		
	Soft-close control for seat cover		Damper device		
	Safety device		Temperature sensor & Temperature control switch & Temperature fuse		
Self-cleaning	Antibacterial seat cover/ nozzle		Made from anti-bacteria plastic		
	Self-cleaning nozzle		Self-cleaning		
Deodorization	Odor control		Activated carbon deodorant		
Rated power	980W		Maximum power	1600W	Waterproofing grade IPX4
Temperature of water supply	4°C - 35°C / 39.2°F - 95°F		Ambient temperature		3°C - 40°C / 37.4°F - 104°F
Water pressure	0.07MPa (Dynamic) ~0.75MPa (Static)				

※1: Rated power: Water pressure is 0.18MPa + 0.02MPa under an ambient temperature of 23°C±2°C (73.4°F±35.6°F), and the condition of 15°C±0.5°C (59°F±32.9°F) water-inflow temperature. Increase the water quantity, the seat temperature and the water temperature, to start the posterior cleaning on the average setting.

※2: Maximum power: Water pressure is 0.18MPa+0.02MPa under an ambient temperature of 23°C±2°C (73.4°F±35.6°F), and the condition of 5°C±1°C (41°F±33.8°F) water-inflow temperature. Increase the water quantity, the seat temperature and the water temperature in turn, to start the feminine cleaning on the average setting.

Product diagram

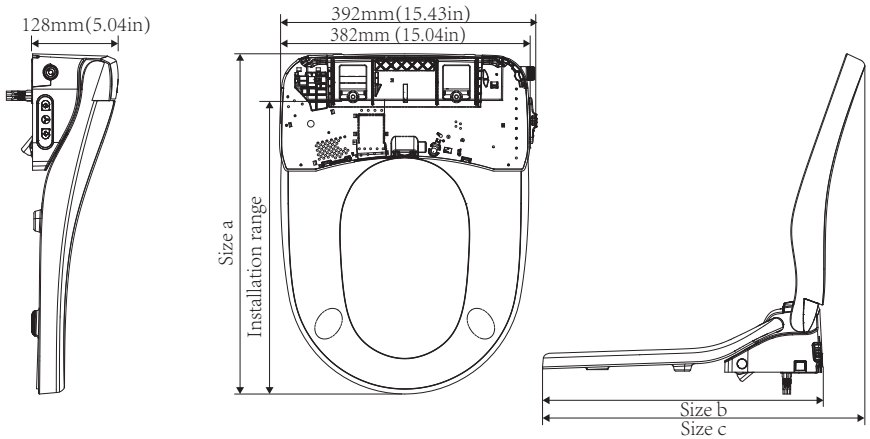

Model	Size a	Installation range	Size b	Size c
①	518mm(20.39in)	452-496mm(17.79-19.53in)	510mm(20.08in)	563mm(22.16in)
②	490mm(19.29in)	424-468mm(16.69-18.42in)	482mm(18.97in)	513mm(20.19in)

The power outlet and the water inflow connection (Caution)

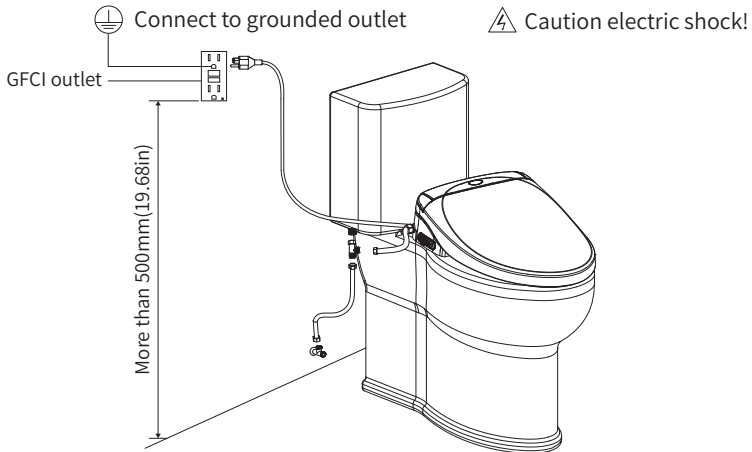

- ※ If the power cord is not long enough, please do not use a extension cord.
- ※ Only for reference. Bathroom sizes and configurations may vary.

Product Functions

Cleansing functions

Posterior cleaning	Rear cleaning
Feminine cleaning	Front cleaning
Spray position adjusting	Adjust the nozzle position to expand the areas being cleaned
Water flow adjusting	Adjusts water flow
Massage cleaning	Variable intensity of the water spray for massaging action
Swing cleaning	Swings back and forth to cleanse most area

Comfort functions

Seat heated	Heats seat and maintains temperature
Dry	Dries cleaned areas with warm air
Temperature adjusting	Adjusts temperature of water, seat and warm air for drying
Deodorization	Auto-deodorizes after user is seated
Seat sensor	Enables cleaning functions after user is seated
Soft close function	Soft-close toilet seat and lid
LED night light	On-and-off sensor adjusts brightness
Prevent low temperature scald	The seat temperature will automatically decrease after the user is seated for 15 min.

Cleaning functions

Antibacterial	The cover and seats are antibacterial
Nozzle cleaning	Nozzle will be cleaned when it is pulled out or retracted
Water emission	Drain the remaining water in the toilet to make the water cleaner

Functions may not be the same for all models.

Installation

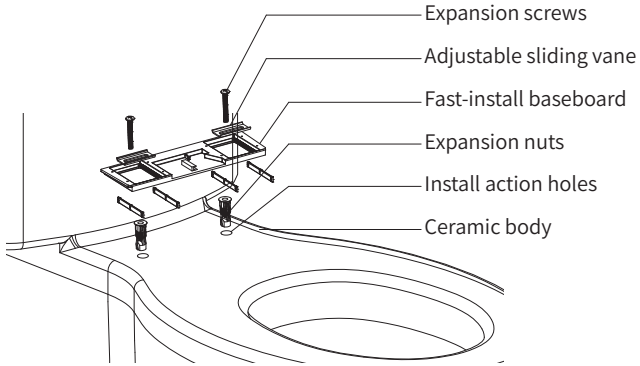

【Tips】

1. Put expansion nuts into installation holes
2. Put fast-install baseboard on installation holes
3. Put adjustable sliding vane on fast-install baseboard
4. Fix adjustable sliding vane and baseboard to ceramic body through expansion screws

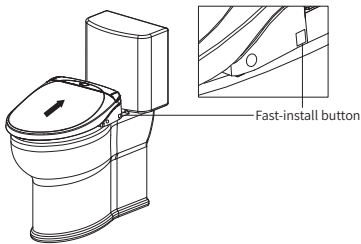
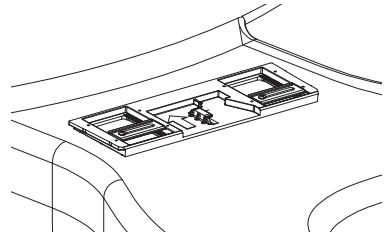

Put the cover seat in the direction of the fast-install baseboard, and push the cover seat as the arrow shown. The seat is properly installed after a "click" sound.

Tips for installation of fast baseboard

1. Install the baseboard and cover seat slightly loosened so as to adjust the position.
2. Take out the cover seat after pressing the button again.
3. Fix the baseboard, then install the cover seat.

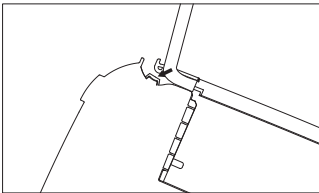

Press the arrow to indicate the fixed power line

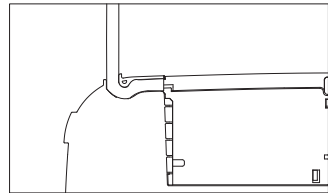

Water supply connection instructions

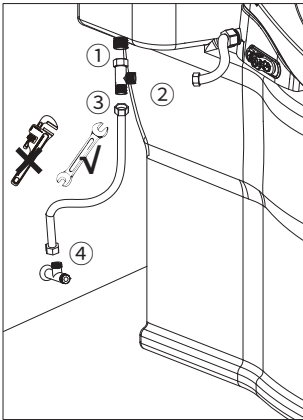
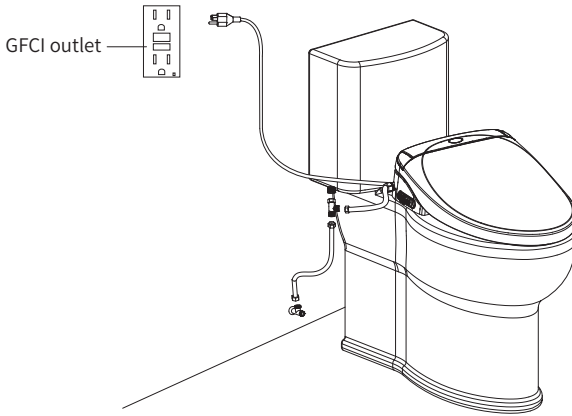

Note: Turn off shutoff valve and drain the water tank before removing valves to prevent water spillage.

- ① Connect the T-connector to the toilet inlet valve.
- ② Connect the included braided hose to the product.
- ③ Connect the original hose to the T-connector.
- ④ Connect the original hose to the inlet valve.

※ WARM PROMPT

This product has been tested with water. It is normal if a small amount of water drips out of the product when it is removed from the packaging.

Components

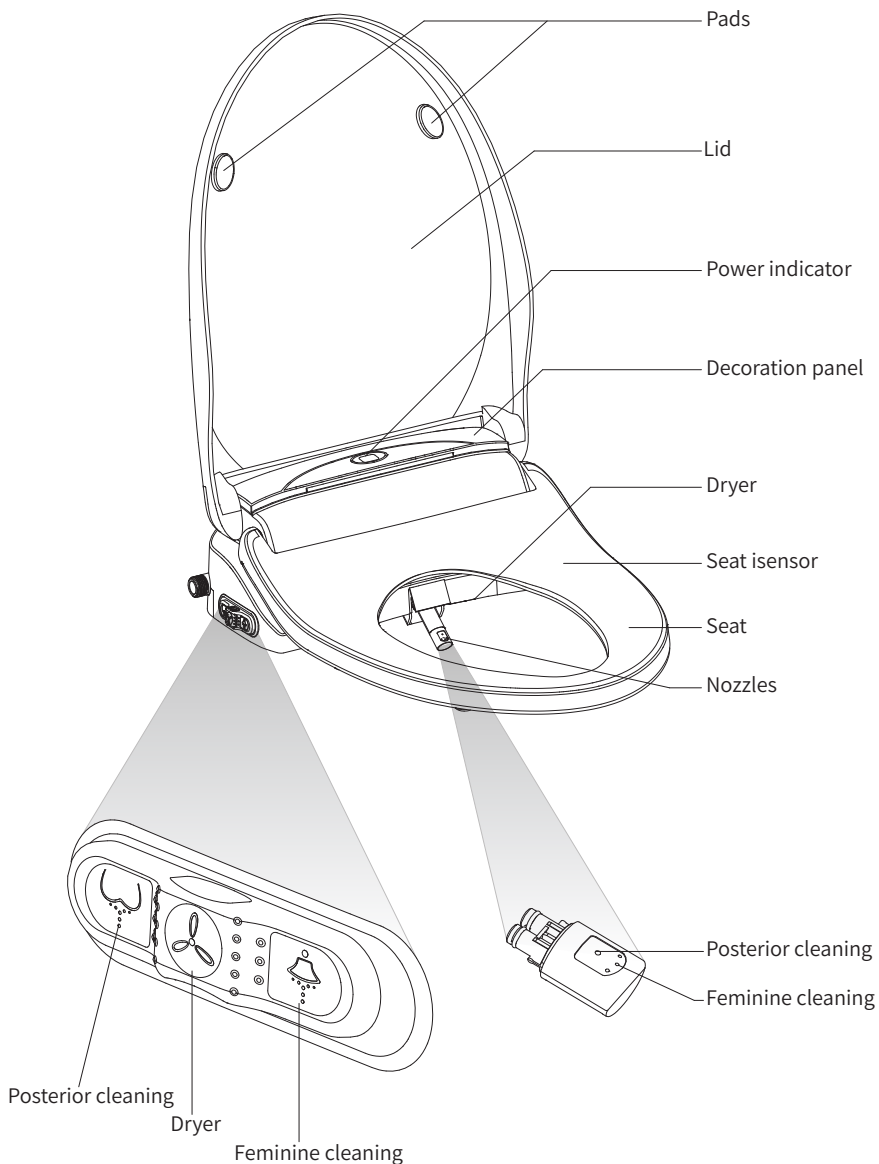

Components

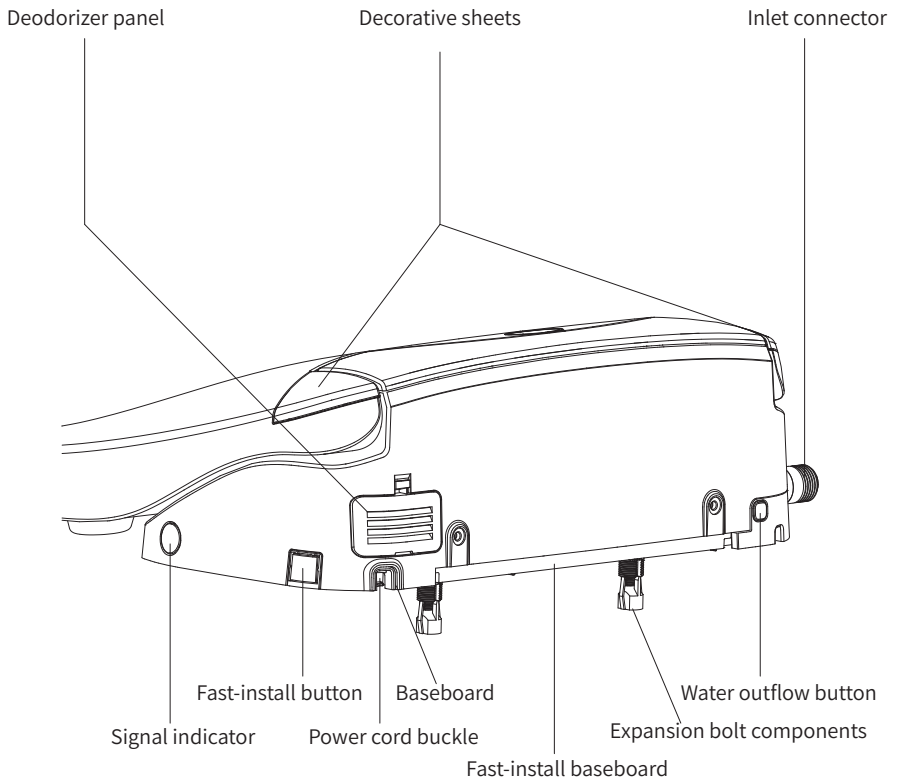

Remote control functions

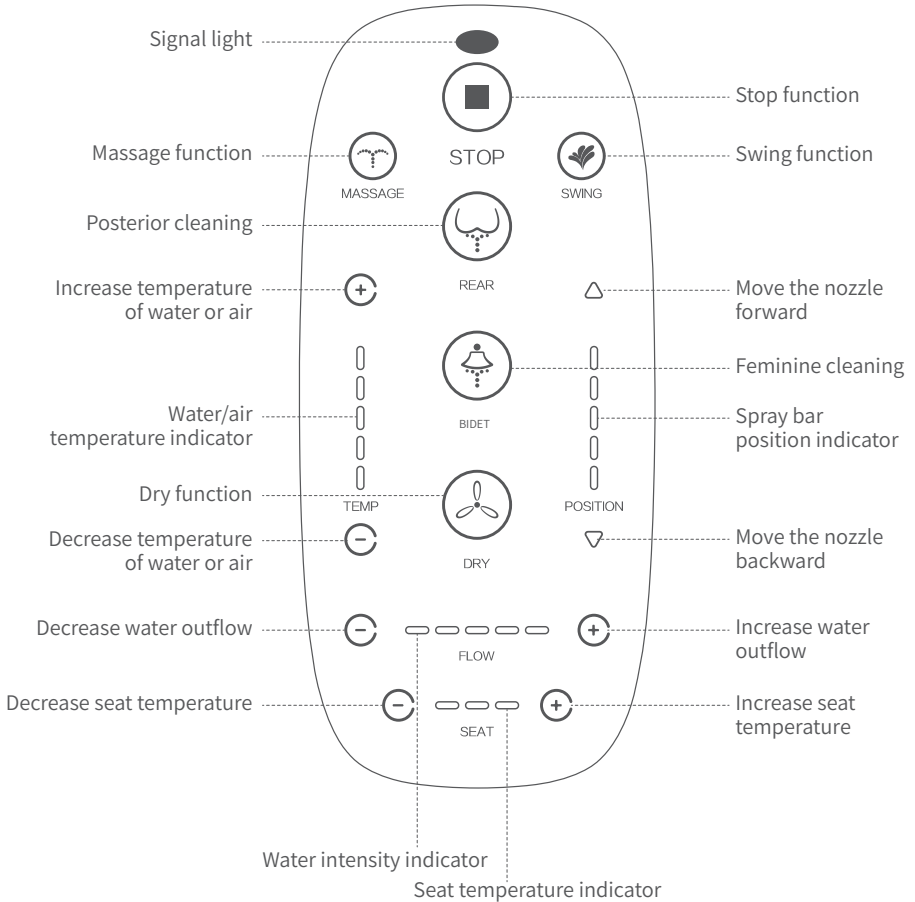

Remote control functions



Stop

- ▶ Press the button; turns all functions off.
- ▶ Atmosphere light will be turned off or on by holding the "stop" button more than 2 sec. (Some models do not have this function).



Posterior cleaning

- ▶ Press the button; posterior cleaning function will start after a beep. The function turns off after 2 min. or by pressing the stop button.
- ▶ Function will stop if user leaves.



Feminine cleaning

- ▶ Press the button; bidet function will start after a beep. The function turns off after 2 min. or by pressing the stop button.
- ▶ Function will stop if user leaves.



Drying

- ▶ Press the button; drying function will start after a beep. The function automatically turns off after 2 min. or by pressing the stop button.
- ▶ Function will stop if user leaves.



Massage

- ▶ During Posterior/Feminine Cleaning Mode, press the "Massage" button. Function will start after a beep.
 1. Interval massage mode: The nozzle sprays with varying pressure.
 2. Powerful massage mode: The nozzle sprays pressurized water.Remark: The massage cycle order is interval massage > powerful massage > regular cleaning.



Swing

- ▶ During Posterior/Feminine Cleaning Mode, press the "Swing" button. Function will start after a beep. During swing function, the nozzle will oscillate back and forth. Press the "swing" button again to stop swing function. Pressing the "stop" button will stop all cleaning functions.



Water temperature setting

There are 5 settings. When the rear mode or bidet mode is turned on, the starting position is the third setting. Press the "+" button to increase water temperature. Press the "-" button to decrease water temperature. The indicator light corresponds to the setting.

Dryer temperature setting

There are 5 settings. When the rear mode or bidet mode is turned on, the starting position is the third setting. Press the "+" button to increase dryer temperature. Press the "-" button to decrease dryer temperature. The indicator light corresponds to the setting.



Spray position setting

There are 5 settings. When the rear mode or bidet mode is turned on, the starting position is the third setting. Press the "+" button to move the nozzle forward. Press the "-" button to move the nozzle backwards. The indicator light corresponds to the setting.

Remote control functions

Adjust water flow



► There are 5 settings. When the rear mode or bidet mode is turned on, the starting position is the third setting. Press the "+" button to increase water intensity. Press the "-" button to decrease water intensity. The indicator light corresponds to the setting.

Adjust seat temperature



► There are 3 settings. When the rear mode or bidet mode is turned on, the starting position is the second setting. Press the "+" button to increase seat temperature. Press the "-" button to decrease seat temperature. The indicator light corresponds to the setting.

※ Note

Adjust the seat temperature to room temperature or low temperature.

To prevent scalding, the seat temperature will automatically decrease after 15 min. of use.

Side push button instructions

Posterior & Feminine cleaning function instructions:

- Function 1: Press Posterior/Feminine cleaning button to start the rear and front cleaning.
- Function 2: When the posterior cleaning or feminine cleaning function is on, press the button again to stop cleaning.
- Function 3: Hold the Posterior/Feminine cleaning button for approximately 2 seconds to start function. The cycle will consist: swing Posterior/Feminine cleaning for 30 sec.; massage function for 60 sec.; drying for 2 min.

Note: For faster access to swing or massage mode, the remote control can be used.

Press the posterior cleaning button more than 5 sec. to turn off/on LED.

Dry function instructions:

- Function 1: Press the Dry button to start the drying function.
- Function 2: Press the button again to stop drying function.

Push button function instruction:

- Function 1: Under posterior/feminine cleaning mode, slide the side button to adjust the position of the nozzle. (Total of 5 settings. Default is the third gear.)
- Function 2: Under posterior/feminine cleaning mode, slide the side button to adjust volume of water. (Total of 5 settings. Default is the third gear.)

Remark: To switch between the above two functions, hold the dry button for approximately 2 seconds. The switch is complete after a beep.

Function 3: Under the dry mode, slide the side button to adjust the temperature (Total of 5 settings. Default is the third setting)

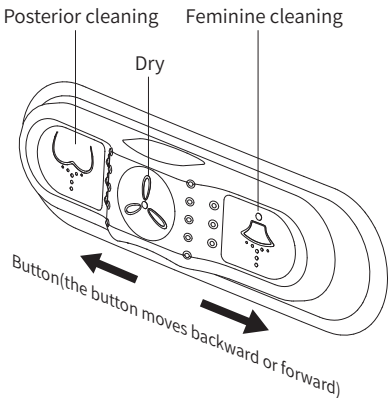

※ If the beep sounds twice, it means that the cycle is complete.

Remote control installation instructions

Method 1 ① Install the remote control fixing panel with a magnet on the remote control fixed seat and lock tightly.

Note: Pay attention to the polarity when installing the magnet. Place the larger side of the magnet hole outside the fixed panel, and enclose the small hole surface inside the fixed panel, as shown in FIGURE 1 below.

- ② Put the double sided-tape on the remote control fixed seat.
- ③ Clean dust, grease, water droplets on the walls and wipe them clean.
- ④ Press the remote control fixed seat with double-sided tape on it. Press it evenly for 3 to 5 min.

Attach the remote control fixed seat to the wall.

Note: The method is applicable to glazed tiles, glass and smooth walls.

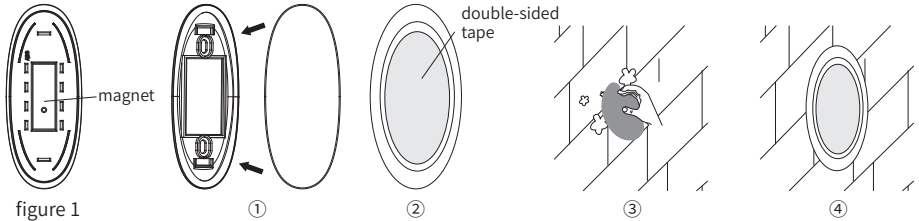

Method 2 ① Drill a hole of 46mm~52mm(1.81in~2.05in) length and 22mm(0.86in) depth on the wall with a 6mm(0.24in) diameter drill. Have a user sit on the seat to check the position of the hole in the wall. The user should be able to access the remote control while seated.

② After installing the expansion plug in the wall, align the fixing hole of the remote control at the expansion plug and then lock the bolt. Install the remote control fixing panel with a magnet on the remote control fixed seat and lock tightly.

Note: Pay attention to the polarity when installing the magnet. Place the larger side of the magnet hole outside the fixed panel, and enclose the small hole surface inside the fixed panel, as shown in the below figure 2.

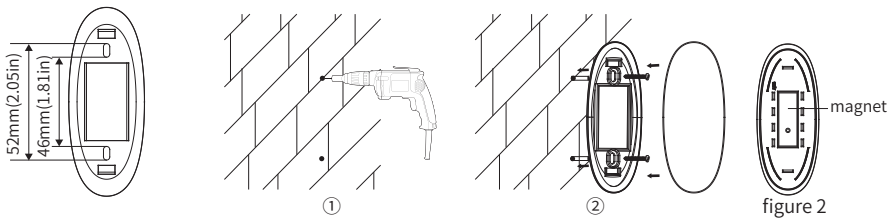

Put the remote control on the fixed base after installing the battery, and the remote control will affix to the base automatically.

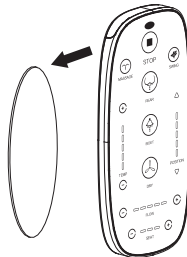

Note: ※Place the remote control on its base when not in use.

※The remote control falling can damage it.

※Do not spill water on the remote control or drop it in water.

Removal & Maintenance

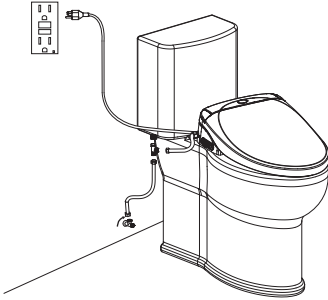

- ① Unplug the product and turn off the shutoff valve. Remove the braided hose and drain excess water.

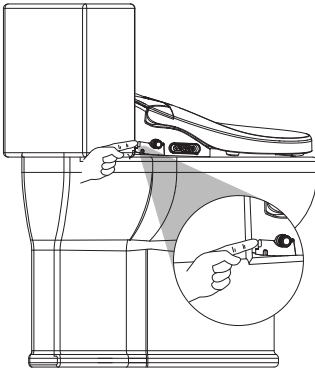

- ② Press the water outflow button to drain water out of toilet.

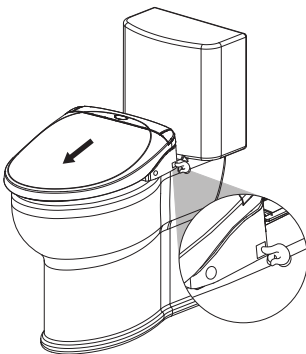

- ③ Press fast-install button. Remove the cover seat from toilet.

※ WARM PROMPT
Please check and test before using the product again.

Cleaning

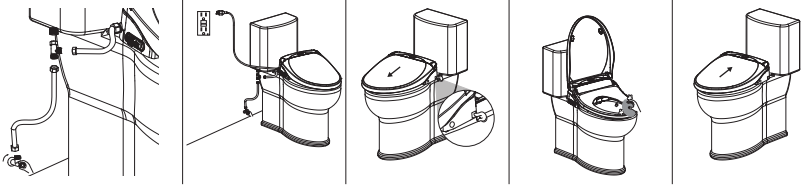

- ① Close the water shutoff valve.
- ② Unplug the product and unscrew the braided hose.
- ③ Press the quick installation button and take off the seat cover.
- ④ Wipe the seat cover with a sponge or a smooth cloth. Only use natural cleaning substances.
- ⑤ Install the seat cover.

Cleaning the water filter

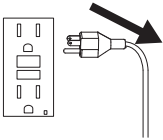

- ① Unplug the product.

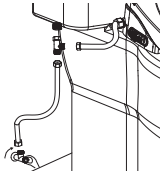

- ② Shutoff water supply.

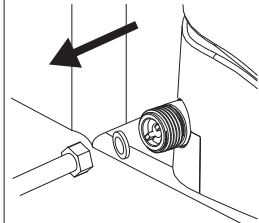

- ③ Remove the water-inflow filter.

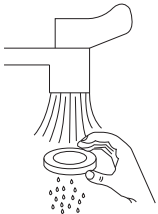

- ④ Clean the water-inflow filter screen.

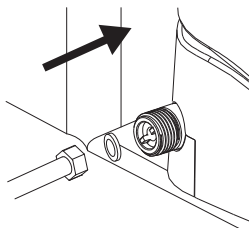

- ⑤ Install the water-inflow filter screen.

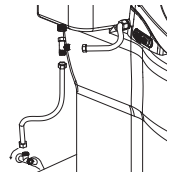

- ⑥ Turn on water supply.

Nozzle cleaning

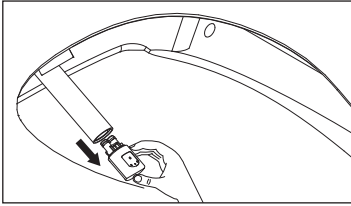

- ① Press the Posterior and Bidet Button simultaneously for approximately 2 seconds for the nozzle to extend out. Remove the nozzle

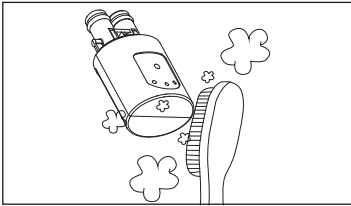

- ② Scrub the nozzle and spray rod with a toothbrush, sponge, or smooth cloth with soap or mild detergent.

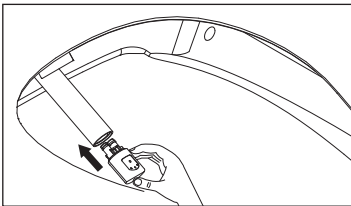

- ③ After reattaching the nozzle, press the Stop, Posterior, or Bidet Button for approximately 2 seconds. The nozzle will automatically retract into the product.

※ WARM PROMPT

Do not use hydrogen chloride cleaning agents, diluent, pesticides and other non-organic detergents to clean the product, and do not use sandpaper or rough cloth to scrub it.

Common troubleshooting

Phenomenon	Reasons	Measures
The product doesn't work	Check to see if the power supply is plugged in or the leakage protector is disconnected	Switch the power supply on
No response when pressing the posterior, bidet, or drying button	No water outflow from nozzle or the water yield is very small	Please press the stop button and wait for the water supply
		Please open the water-inflow valve if it is closed
	The seating sensor does not recognize that someone is on the product	Please clean or replace the filter (optional feature) device if it is blocked
The cleaning stops suddenly	After a mode is selected, the product goes through its selected mode for 2 min. before automatically stopping.	This is correct operation. To continue cleaning, select a new mode
The nozzle stops suddenly	If the user moves too fast or leaves the seat, the seat sensor cannot detect the motion.	Ensure that the seat sensor is covered and continue
Low water pressure when posterior cleaning or feminine cleaning	Filter (optional feature) may be blocked	Clean the filter screen or replace the filter
	The water-inflow hose may be leaking	Check the hose and tighten it
Deodorizer does not activate	The seating sensor does not recognize that someone is on the product	Please sit in a manner that covers the sensor
	Activated carbon filter(optional feature) block or spacer may be blocked	Remove the deodorizing window to clean or replace the carbon filter
Deodorant function continues to work after user leaves	The deodorant function will be continue to work for 20 sec. in order to remove the residual odor after the user leaves	This is correct operation
The toilet seat can't be heated	The seating sensor does not recognize that someone is on the product	Please sit in a manner that covers the sensor
	The seat temperature is set lower than desired	Adjust the seat temperature with the remote control
Cold water of posterior cleaning and feminine cleaning	The water temperature is set lower than desired	Adjust the water temperature with the remote control
The drying temperature is not high enough	The dryer temperature is set lower than desired	Adjust the drying temperature with remote control

Troubleshooting and alarm maintenance

Problem	Possible causes	Actions
If the power light flashes 1 time as it lights for 2 sec.	The inlet water temperature sensor is faulty or there is a broken circuit.	You should cut off the power supply immediately and stop using the product, then contact the local dealer or call service hotline.
If the power light flashes 2 times as it lights for 2 sec.	The outlet water temperature sensor is faulty or there is a broken circuit.	
If the power light flashes 3 times as it lights for 2 sec.	The drying fan temperature sensor is faulty or there is a broken circuit.	
If the power light flashes 4 times as it lights for 2 sec.	The seat temperature sensor is faulty or there is a broken circuit.	
If the power light flashes 7 times as it lights for 2 sec.	The dryer fan may be faulty.	
When the product is in use, the leakage protection switch on the power supply trips from time to time	Leakage beyond a normal range has been detected.	

※ WARM PROMPT

Please read the above troubleshooting and follow the instructions.

Maintenance Service Sheet

Product		Product code	
The selling store		Purchase date	
Province	City	Dealer (signature) :	
Maintenance content			
<p>Free maintain regulation:</p> <p>1、Free maintenance is provided when you use it properly in accordance with instructions and under warranty.</p> <p>2、Please contact the dealer or the company if the fault occurs under warranty.</p> <p>3、The following situations is chargeable for maintenance under warranty:</p> <p>① Faults or damages caused by the improper operation, repair or reinstall.</p> <p>② Faults or damages caused by forced movement after the product is installed.</p> <p>③ Faults or damages caused by earthquakes, fires, floods, lightning strikes, corrosive liquids, abnormal voltages and other natural disasters.</p> <p>④ Faults or damages caused by other approaches which are not for family-use.</p> <p>⑤ Fail to provide the maintenance-service sheet.</p> <p>⑥ There is no detailed records or there are modified records on the maintenance-service sheet.</p> <p>4、This maintenance-service sheet is valid.</p> <p>5、This maintenance-service sheet is unrepeatable, please safe keep it.</p> <p>6、The customer can go to the local repair network or sent the products back to the company for free repair within two years from the purchase date.</p>			
<p>Executive standard: CONFORMS TO UL STD. 1431 ASME A112.4.2-2021</p> <p>Warranty period: within two years from the purchase date</p>			

- Due to the constant improvement about our products, we will keep the final interpretation of products change.
- If the products you bought exist differences from the instruction, please in kind prevail.



NOTE: This equipment has been tested and found to comply with the limits for a Class B digital device, pursuant to Part 15 of the FCC Rules. These limits are designed to provide reasonable protection against harmful interference in a residential installation. This equipment generates uses and can radiate radio frequency energy and, if not installed and used in accordance with the instructions, may cause harmful interference to radio communications.

However, there is no guarantee that interference will not occur in a particular installation. If this equipment does cause harmful interference to radio or television reception, which can be determined by turning the equipment off and on, the user is encouraged to try to correct the interference by one or more of the following measures:

- Reorient or relocate the receiving antenna.
- Increase the separation between the equipment and receiver.
- Connect the equipment into an outlet on a circuit different from that to which the receiver is connected.
- Consult the dealer or an experienced radio/TV technician for help.

Made in China
52211772-01 V1.0

KELISS TRADING CO., LTD

ADD:RM4, 16/F, HO KING COMM CTR,
2-16 FAYUEN ST, MONGKOK KOWLOON,
HONG KONG