

# ***Mankeel***

**W7 Sea Scooter**

\*Please read and follow the instructions of this product carefully

User Manual v1.0



## General

Mankeel W7 is an innovative dual propeller sea scooter. Everyone is curious about the underwater world. The unique aircraft design and fashionable streamlining design, strong power and step-less speed control bring you a new experience of diving.

Except for the powerful features, Mankeel W7 also has surprisingly user-friendly details, including child safety locks, easy-to-change waterproof batteries, and adjustable speed levels. Colorful body with an action camera mount, capture and share the exciting underwater moments at any time. Press to go, release to stop, Mankeel W7 takes you to a brand new underwater world!

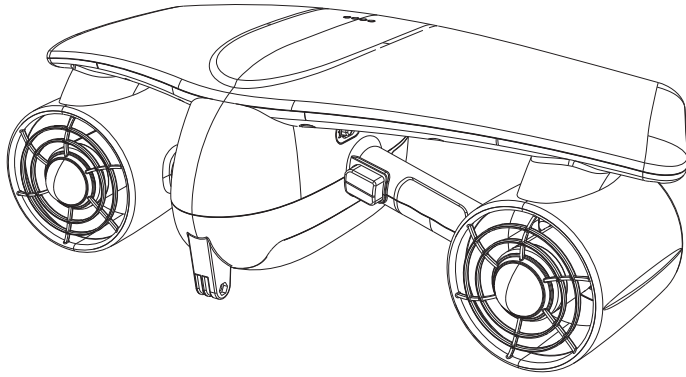

### A standard package includes:

Mankeel W7 Machine\*1

Battery\*1

Battery Charger\*1

User Manual\*1

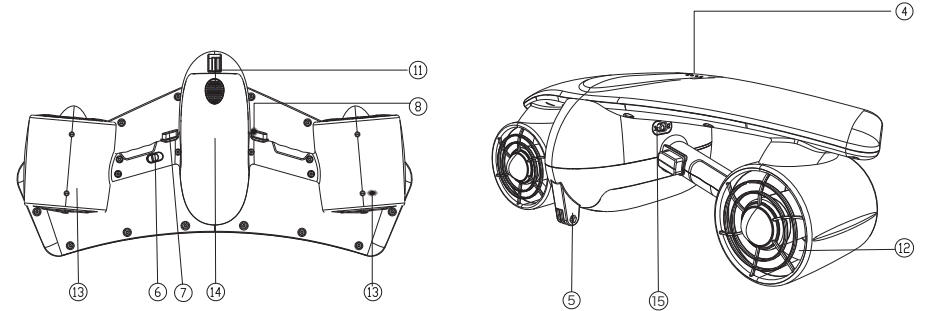
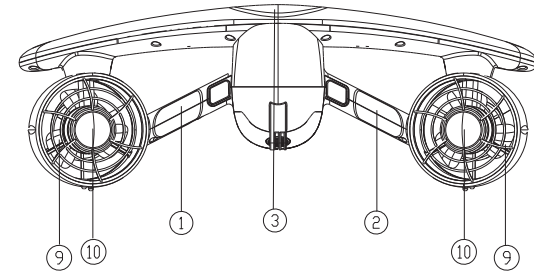

- |   |                |    |                       |    |                |
|---|----------------|----|-----------------------|----|----------------|
| 1 | Handle 1       | 6  | Safety Lock           | 11 | Battery buckle |
| 2 | Handle 2       | 7  | Accelerator Trigger 1 | 12 | Propeller      |
| 3 | Floating-panel | 8  | Accelerator Trigger 2 | 13 | Rear Grille    |
| 4 | Battery Status | 9  | Thruster              | 14 | Battery bottom |
| 5 | GoPro mount    | 10 | Front Grille          | 15 | Gear change    |

## Warnings

1. Never use Mankeel W7 as a life-saving equipment. Mankeel W7 is only designed for personal recreational use.
2. Read the User Manual carefully before using.
3. Always inspect the swimming area to enter. Make sure there's no hazards or obstacles.
4. Always wear an approved life-preserver when using Mankeel W7.
5. Never let minor children use Mankeel W7 alone, and a lifeguard or guardian should always be present.
6. The elderly, pregnant women and people unsuitable for swimming should not use Mankeel W7 alone.
7. Do not drink alcohol or take drugs before using Mankeel W7.
8. Users with long hair should wear a swimming cap. do not get close to anybody with long hair to avoid danger.
9. Never remove the grilles except for maintenance. never stick your finger, other body parts or other objects in the vicinity of the propeller.
10. Pay attention to battery level during use. Please return to shore or other safe places before battery runs out.
11. Always turn the safety lock to "OFF" when not using.
12. Always charge the battery with original battery charger. never charge the battery with other batter chargers.
13. Immediately stop using Mankeel W7 if the propeller becomes intermittent, or a buzzer is heard. never try to disassemble the product by yourself.
14. Never swap battery in water or with wet hands.
15. The Mankeel W7 is only intended for swimming. never run Mankeel W7 continuously for over 1 min in non-water environment.
16. Always keep Mankeel W7 away from gasoline, rubber oil, other volatile substances or acidic materials, sharp objects and direct sunlight.
17. Do not incinerate, disassemble, damage, short-circuit or expose the battery to heat.

## Getting Started

### 1. Charge the Battery

You need to charge the battery when use the Mankeel W7 for the first time. Please ensure the battery is dry before charging and use the original charger only. Remove battery from charger once fully charged.

#### Battery Status Indicators:

LED1	LED2	LED3	LED4	Battery level
■	■	■	■	75%~100%
■	■	■	□	50%~75%
■	■	□	□	25%~50%
■	□	□	□	0%~25%
□	□	□	□	0%

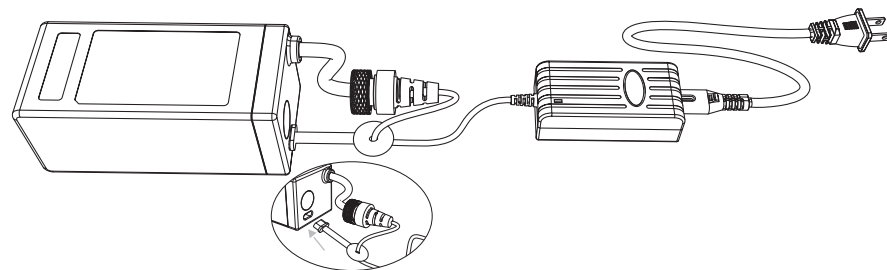

△ Note: During the charging progress, please insert the charging key into the battery key hole to make it more efficient.

## 2. Install the Battery

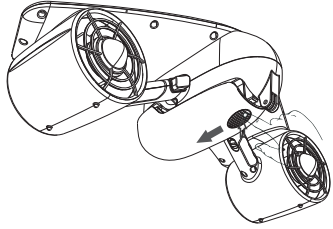

a.Unlock the bottom buckle

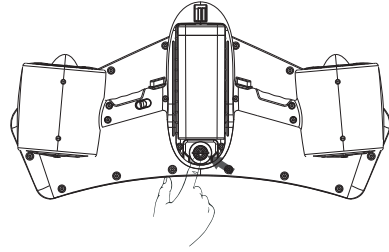

b.Insert in plug and tighten the thread

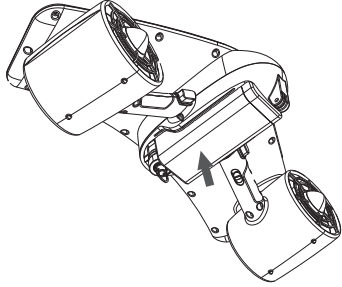

c. Place the battery

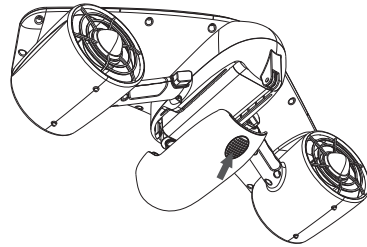

d.Secure the bottom buckle

## 3. Check the Mankeel W7

Switch the Safety Lock to on position. hold both triggers simultaneously to start the Mankeel W7. The propeller will start and the battery status indicators will operate.

Check if they work normally.

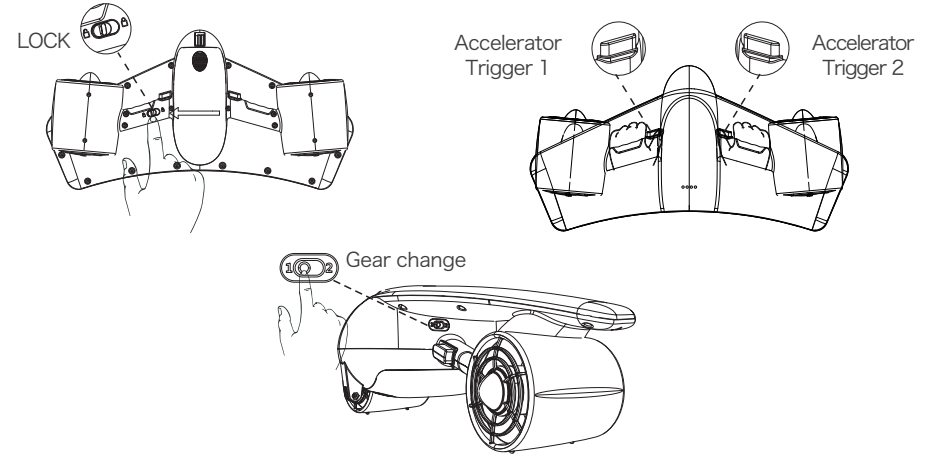

## 4. How to operate

Hold both triggers simultaneously and the propeller will start. To stop the propeller, simply release both triggers. ensure the safety lock is switched to OFF position after use.

If you want another run with a spare battery, please wipe the Mankeel W7 dry with a dry cloth and swap battery following Step 2.

## 5. Washing and Care

After use, please rinse the Mankeel W7 in fresh water with no detergents. Unlock the safety lock and hold both triggers for 3 seconds and repeat 5-10 times. Wipe the machine using a dry cloth. After that remove the battery and recharge it when it's totally dry.

⚠ Otherwise, the company will not guarantee the machine due to problems such as rust and corrosion because of irregular cleaning.

## 6. Storage

Store the Mankeel W7 in a well ventilated place away from direct sunlight or heat. Do not store battery in the Mankeel W7. Please store the battery in a well ventilated area away from children, direct sunlight, heat and ignition. Do not place the battery on or near fires, stoves, or other high temperature locations. Do not subject the battery to strong impacts or shocks. Re-charge the battery at least every 3 months. The battery does self-discharge and the charge could drop low enough to damage the battery.

## Technical Specifications

Weight(including battery): 4.5kg	Battery Capacity: 6000mAh/129.6Wh
Maximum Depth: 50m	Duration: 30min-45min
Maximum Speed: 0.8m/s, 1.5m/s	Buoyancy: 0.2kgf
Charging Time: 3hours	Power: 480W
Output Voltage: 21.6V	Thrus: 12kgft
Color: Yellow/White/Black/Pink	Battery Weight: 1.4kg
Working Temperature: -5°C - 50°C	
Dimension: 540*280*190mm/Length*Width*Height	
Battery Charger: Input 100V-240V; Output 25.2V 2A	

1. The speed may vary depending on different person or environment.
- 2.The battery duration is 30min if the propeller is always on. For normal use, it can last up to 45min.

## Warranty and Disclaimer

The warranty period of Mankeel W7 is 6 months. If your machine is not operating, please contact our after sales service in time. Please visit our website for detailed warranty information. Website: [www.mankeel.com](http://www.mankeel.com) Or contact us by email: [support@mankeel.com](mailto:support@mankeel.com) This warranty does not cover items that experience normal wear and tear. Warranty shall automatically be void if damage is result of non-original parts and/or disassembly and repair by unauthorized person or party. Warranty of this product does not cover any damages due to misuse, accident or failure to follow the user instructions. Warranty of this product does not cover damages or loss of your cameras including but not limited to any user' s personal items.

## Warranty Card

Product Name: \_\_\_\_\_  
Mode: \_\_\_\_\_  
S/N No.: \_\_\_\_\_  
Distributor/Dealer: \_\_\_\_\_  
Invoice No.: \_\_\_\_\_  
  
User Name: \_\_\_\_\_  
Telephone: \_\_\_\_\_  
Date of purchase: \_\_\_\_\_  
Address: \_\_\_\_\_

Warranty: 6months.

## 产品概述

Mankeel W7是一款搭载双螺旋桨的新概念水下推进器。每个人都对水下的世界充满好奇，Mankeel W7能够带你轻松地潜入水底，体验全新的潜水乐趣。Mankeel W7拥有独特的飞机外形和高效流道设计，强劲动力和无级变速，给潜水这项运动带来了新鲜感。

除了强大的功能外，Mankeel W7更有令人惊喜的人性化设计细节，包括儿童安全锁、易拆卸防水电池和多档位调节。Mankeel W7提供丰富多彩的颜色选择，并且预留运动相机接口，随时捕捉和分享水中精彩时刻。操作简单，推波助澜，让Mankeel W7带你去看一个全新的世界！

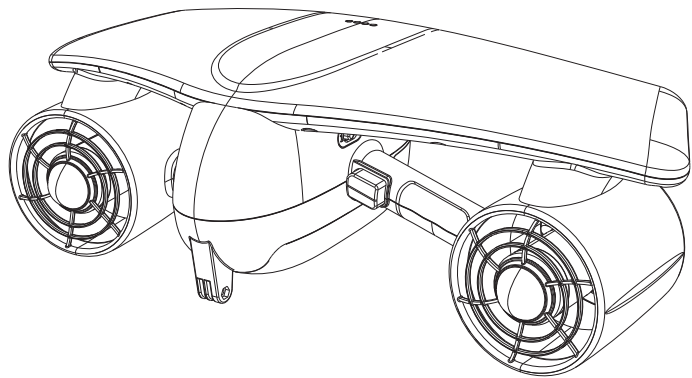

## 物品清单:

Mankeel W7 机器\*1

用户手册\*1

电池\*1

合格证\*1

电池充电器\*1

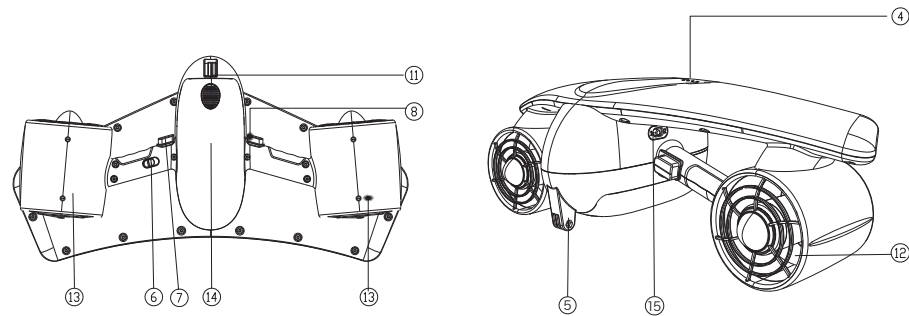
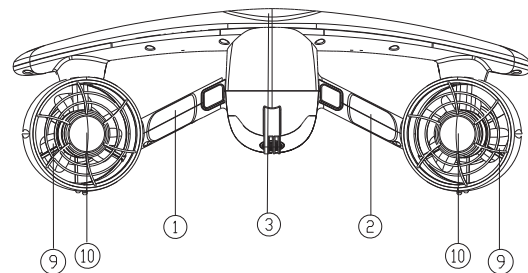

- |         |              |              |
|---------|--------------|--------------|
| 1 把手1   | 6 儿童安全锁      | 11 电池卡扣      |
| 2 把手2   | 7 开关按键1无级变速  | 12 螺旋桨       |
| 3 浮体面板  | 8 开关按键2      | 13 后螺旋桨 保护格栅 |
| 4 电量指示灯 | 9 推进器        | 14 电池底盖      |
| 5 相机接口  | 10 前螺旋桨 保护格栅 | 15 高低档开关     |

## 安全注意事项

- 1.本产品为娱乐设备，不能作为救生设备使用。
- 2.在使用本产品前请仔细阅读本使用手册。
- 3.在使用本产品前，请充分了解将要进入的水域，以避免潜在的危險。
- 4.为保证安全，在任何情况下使用者都应穿着救生衣或者配备救生设备。
- 5.除非在监护人授权的救生员保护的環境下，未成年人不建议单独使用本产品。
- 6.老年人、孕妇及不适宜游泳的人群，不应单独使用本产品。
- 7.在使用本产品之前及使用本产品的过程中，不能饮酒或服用药物。
- 8.长发者在使用本产品时应佩戴泳帽。使用时应特别注意身边任何留长发的人，避免将他人的头发或衣物绞入螺旋桨中。
- 9.切勿随意拆下螺旋桨防护栅。任何时候均不可将手指或身体的其他部分伸入螺旋桨中，也不可将任何异物塞入螺旋桨中。
- 10.在水中使用本产品时，应随时注意观察周边环境，避免发生碰撞。
- 11.在使用本产品前，请检查电池电量。在水中使用本产品时，请随时注意观察电量，确保在电量耗尽前返回岸上或其他安全区域。
- 12.请使用本机自带的适配器进行充电，切勿使用其他型号的适配器给产品充电。
- 13.非厂家售后服务人员切勿擅自进行修理，修理不正确会导致产品漏水、损坏、火灾或触电。
- 14.切勿在水中更换电池，更换电池前应保证机器、电池及双手干燥。
- 15.在使用本产品前，应充分检查产品，确认电池无破损、电量充足，确认螺旋桨及推进器运转正常。若有异常状态（如电机卡顿、烧焦味、噪音等）应立即松开按键开关使机器停止运转，条件允许的情况下立即取出电池。
- 16.本产品为水下使用产品。为保护电机寿命，请勿在非水下环境中持续运转超过一分钟。
- 17.产品表面不可与汽油、橡胶水等挥发性物质或酸性物质接触，不可与尖锐物品接触。
- 18.产品上方不可以放置重物。
- 19.不可将电池暴晒，靠近热源或投入火中。
- 20.使用完请及时用清水冲洗机器，切勿将电池放在机器里储存。机器清洗擦干后请立即将电池晾干单独放置。
- 21.使用完成后，请确保将安全锁滑至关闭状态。

## 使用指南

### 1.电池充电

为了运输安全,您收到的电池并不会完全充电。请在第一次使用前先充满电。充电前请确保电池完全干燥，并使用Mankeel W7自带充电器给电池充电。禁止使用其他充电器给电池充电。充满电后，充电适配器上的指示灯将由红色变成绿色。充电完成后请及时断开电源。

### Mankeel W7 电量指示灯:

LED1	LED2	LED3	LED4	当前电量
■	■	■	■	75%~100%
■	■	■	□	50%~75%
■	■	□	□	25%~50%
■	□	□	□	0%~25%
□	□	□	□	=0%

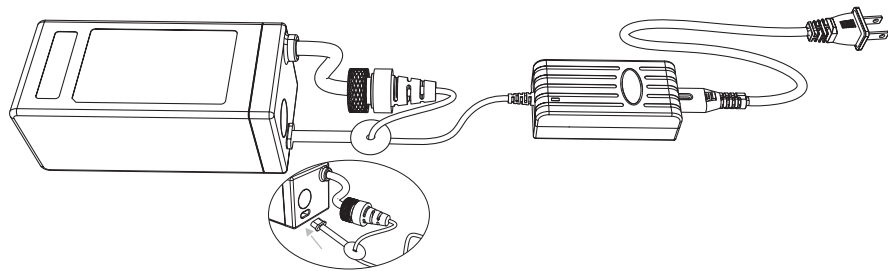

△ 注意:充电过程中请插入充电钥匙于电池钥匙孔内，充电效率更高。



## 2. 安装电池

使用前请确保电池处于满电状态。电池卡槽位于机身下部，从图示接口处解开Mankeel W7的底部卡扣，先对准接口方向插入并拧紧螺线，再将电池按照图示方向放入卡槽，最后固定底部卡扣

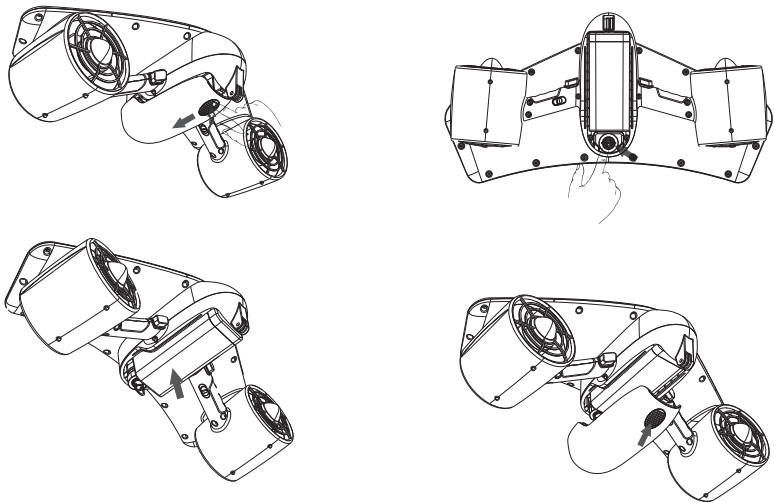

## 3. 使用前检查

请将安全锁滑动至开启位置。双手同时握住两侧手柄开关开启Mankeel W7，观察LED电量指示灯是否正常亮起，推进器是否正常工作。若LED电量指示灯提示电量不足，请及时充电。如出现推进器卡顿，有杂音等异常情况，请不要使用机器，并及时联系保修。

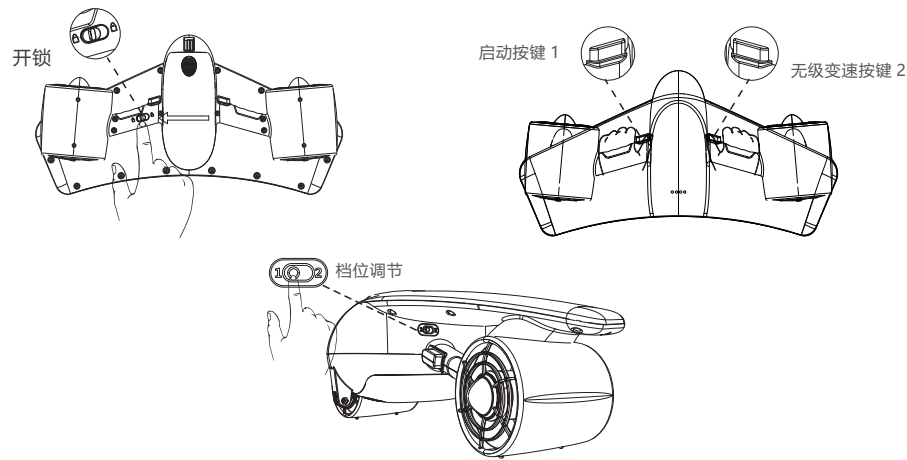

## 4. 启动与关机

确保安全锁在开启位置，双手同时握住两侧手柄开关即可启动Mankeel W7。双手松开开关Mankeel W7将停止。请注意单手握住开关，机器将不会启动。使用完后请将安全锁滑至关闭位置。

如果您想更换备用电池继续使用Mankeel W7，请先用干毛巾将机器擦干，然后按照步骤2的指示重装电池。

## 5. 清洁与保养

使用完后请立即将机器浸泡在不加入任何清洗剂的清水中，双手握住两侧手柄开关3秒，持续5-10次。用干净毛巾或软布将机身擦干，将电池取出晾干充电。

⚠ 否则因不规范清洗导致机器生锈、腐蚀等问题我司不予保修退换。

## 6. 储存

请将Mankeel W7放置在通风良好的地方，避开暴晒、热源、火源。切勿将电池放到Mankeel W7机器内储存。电池必须取出单独放置在通风良好的地方，远离儿童、暴晒、热源和火源。切勿撞击、拆解、刺穿或损坏电池，或是使电池短路，否则有爆炸的危险。如果长期不用，请至少每3个月给电池充满电一次。电池会自行放电，如果电量过低会损害电池，影响电池使用寿命。

## 产品参数

空气中重量(含电池): 4.5kg	电池容量: 6000mAh/129.6Wh
最大深度: 50m	电池使用时间: 30min-45min
速度: 0.8m/s, 1.5m/s	浮力: 0.2kgf
充电时间: 3hours	引擎功率: 480W
输出电压: 21.6V	推力: 12kgft
颜色: 黄色/白色/黑色/粉色	电池重量: 1.4kg
使用温度: -5°C - 50°C	
尺寸: 540*280*190mm 长*宽*高	
电池充电器: 输入100V-240V; 输出: 25.2V 2A	

- 1.使用人和环境不同时,速度有差异属于正常现象.
- 2.电池使用时间会随着电池化学状态,环境温度,充放电次数等有所变化.电机若一直工作持续时间为30分钟,经测试正常游泳使用可持续45分钟.

## 保修说明

- 1.本产品享有6个月保修服务。
- 2.购买发票是您获得保修服务的重要凭证，请妥善保管。
- 3.客户或者未授权第三方自行拆开设备维修，或者由使用不当引起的设备外壳划伤破损，或者超过保修年限的，维修时需取维修费（包括修理费及元器件费用）。
- 4.请登梦客网址查看详细售后流程：  
网址: [www.mankeel.com](http://www.mankeel.com)  
或通过电子邮件联系本公司售后支持： 邮箱: [support@mankeel.com](mailto:support@mankeel.com)  
欢迎对我们的产品质量和售后服务提出宝贵意见！

# 保修卡

商品名称: \_\_\_\_\_

型号: \_\_\_\_\_

S/N 编码: \_\_\_\_\_

经销商: \_\_\_\_\_

发票号码: \_\_\_\_\_

用户姓名: \_\_\_\_\_

联系电话: \_\_\_\_\_

购买日期: \_\_\_\_\_

联系地址: \_\_\_\_\_

## 注意事项:

1. 机器使用过程中请谨遵使用说明书指引,切勿进行违反安全提醒的操作。
2. 机器使用过程中如遇任何异常情况,请及时联系生产商或者当地代理商,切勿私自拆开机器处理。

## 免责声明

1. 机器正常使用导致的磨损老化不属于保修范围。
2. 用户任何不按照说明书指示的不当行为或强行拆卸产品的行为，或由非机器故障原因或第三方零件导致的产品损坏或故障不属于保修范围。同时由此产生的维修、零件更换和运输费用将由用户承担。
2. 请严格按照使用说明书指示使用本产品，任何违反使用说明书指示的使用行为导致用户身体的伤害、疾病或财产等方面的损失，将由用户自行承担。
3. 用户在产品使用过程中，造成运动相机或其他私人物品的损毁遗失不属于保修范围。