

Owner's Manual

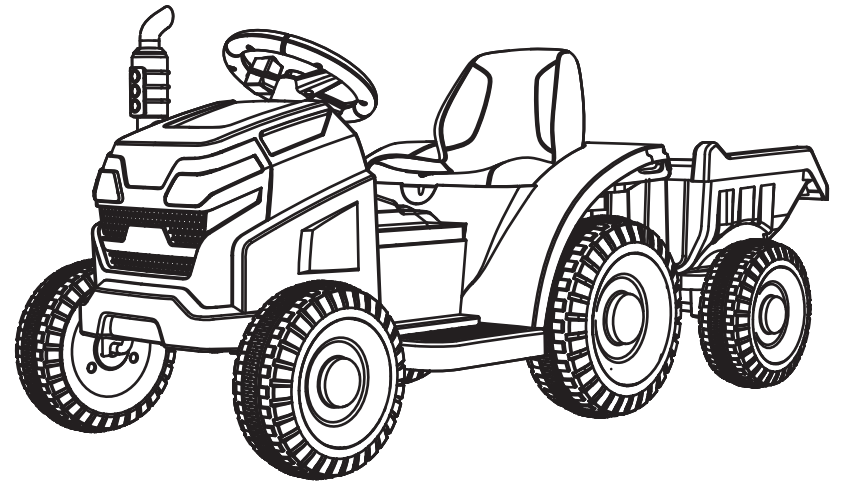

**Age for: 37-95 months
Adult assembly required!**

The Owner's manual contains assembly, use and maintenance instructions. The vehicle must be assembled by an adult who has read and understands the instructions in this manual. Keep the packaging away from children and dispose all packaging before use. Keep instructions for future reference.

Safety

Warning !

The following safety hazards may result in serious injury or death to the user of the vehicle:

- This product contains small parts that are for adult assembly only. Keep small children away when assembling. Remove and dispose of all protective material and poly bags before assembly. Be sure to remove all packaging materials and parts from underneath the car body.
- Body parts such as hands, legs, hair and clothing can get caught in moving parts. Never place a body part near a moving part or wear loose clothing while using the vehicle. Always wear shoes when using the vehicle.
- Using the vehicle near streets, motor vehicles, drop-offs such as: steps, water (swimming pools), sloped surfaces, hills, wet areas, flammable vapors, in alleys, at night or in the dark could result in an unexpected accident. Always use the vehicle in a safe, secure environment with continuous adult supervision.
- Using the vehicle in unsafe conditions such as snow, rain, loose dirt, mud, sand or fine gravel may result in unexpected action such as tip over and skidding.
- Using the vehicle in an unsafe manner. Examples include but are not limited to:
 - a. Pulling the vehicle with another vehicle or similar device
 - b. Allowing more than one rider
 - c. Pushing the user from the back
 - d. Traveling at an unsafe speed

Always use common sense and safe practices when using the vehicle. The user must 3+ years old and not weigh more than 66 lbs (30kg).



WARNING:
CHOKING HAZARD -Small
parts. Not for children under 3 years!

Warning. Protective equipment should be worn.
 Not for children with a body weight of more than 30kgs.
 Warning. Only for domestic use.
 Warning. Never change the vehicle parts or circuit without
 manufacturer's introduction.

SPECIFICATION

Battery	12V4.5AH		
Motor	Drive motor: 390# 15000RPM		
Age for	37-95 Month		
Maximum Capacity	30kg	Speed	3-5km/h
Vehicle size	1000*400*420mm		
Package size	680*390*380mm		
Net weight	7.3 kgs	Gross weight	8.9 kgs
Use time	Each charge for 10-12 hours, use 1-2hours		
Charger	Output: DC12V 1000MA		
	Input: Depend on local voltage		

Parts list in package

- | | | | |
|-----------------------|------|---------------------|------|
| ● User Manual | 1pcs | ● Charger | 1pcs |
| ● Vehicle body | 1pcs | ● Seat | 1pcs |
| ● Front wheel | 1pcs | ● Big rear wheel | 2pcs |
| ● Small rear wheel | 2pcs | ● Exhaust pipe | 1pcs |
| ● Big wheel cover | 2pcs | ● Small wheel cover | 4pcs |
| ● Drag bucket support | 1pcs | ● Drag bucket axle | 1pcs |
| ● Wrench | 2pcs | | |

Assembly

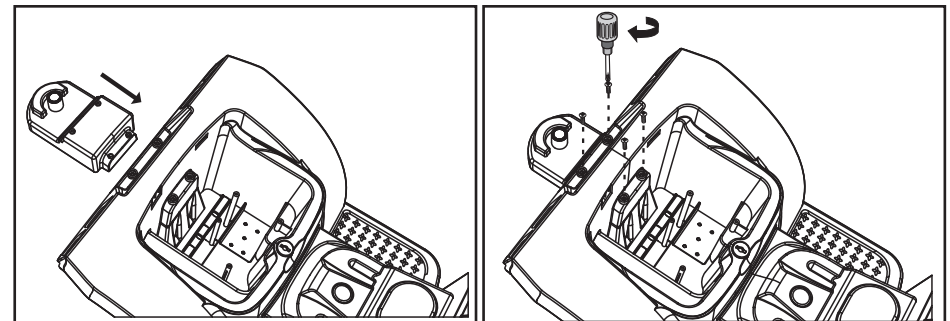

1. Insert the drag bucket connector into the body and fix it with 4 screws, as same the pic.

Assembly

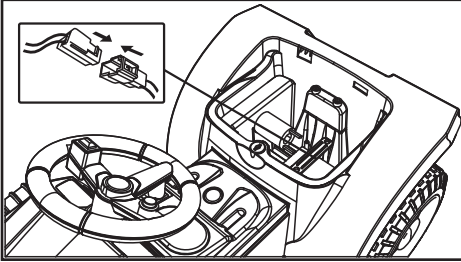

2. Connect two the wire terminals in the battery compartment, then assamble the seat on the body and tighten latch, as smae the pic.

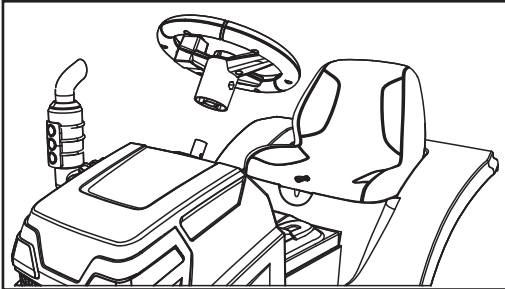
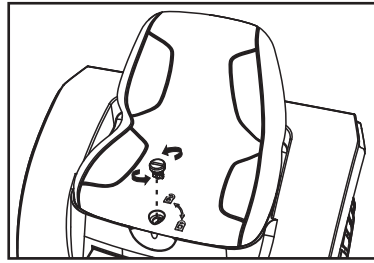

3. Insert the steering wheel into the steering rod, then the M5 screw though the steering wheel and steering rod holes, and finally tighten with nuts,as same the pic.

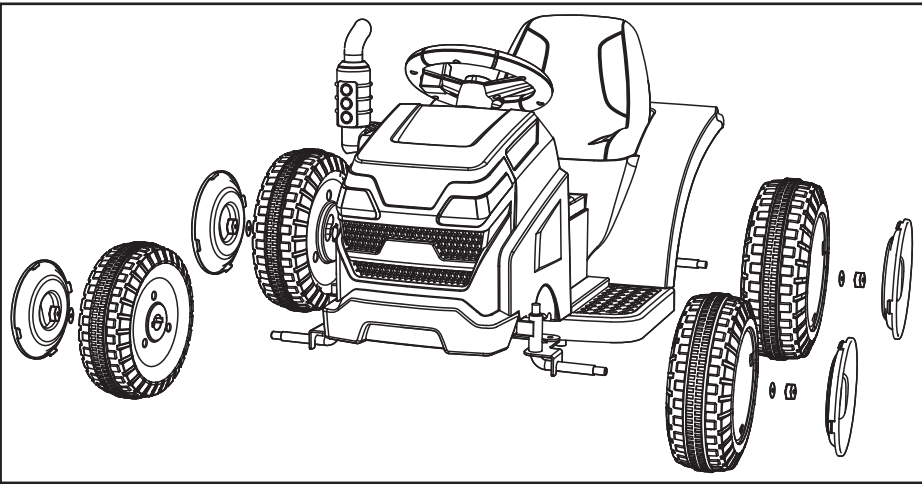

4. Insert the wheels and gaskets into the axles, then tinghten the M8 nuts, finally clip into the wheel cover, as smae the pic.

TROUBLESHOOTING GUIDE

Problem	Possible	CauseRemedy
Motor does not work	Pedal switch not connect well. The terminal and wire on motor loose The plug for motor and battery not connected well The motor is damaged.	Repair the pedal switch. Connect the wire and terminal Reconnect the plug Replace the motor
Vehicle can go forward but can't backward	The forward/backward switch not connected well. The wire connect forward/backward and battery loose	Replace the switch. Reconnect the wire
The speed is slow	The battery with low power The gear not fit well in the motor	Charge the vehicle Change the motor
The vehicle can't be charged	The charger is damaged (if the output terminal of charger tested no voltage) The battery is damaged (connect the charger and check the terminals on battery, there is a voltage of 6.8-8.0v) The charge socket not connected well or the welding spot loose	Change the charger Change the battery Tighten the socket or reweld the wires
The vehicle can move but no sound and lights	The button for music and lights is damaged. The wire from battery not connect the vehicle head plug well	Replace the buttons. Reconnect them.
Motor works while the vehicle can't move	The motor loose from the gear box The gear in gear box damaged.	Open the gear box and tighten the screws to fix the motor. Change a new gear box.
The vehicle moves but not smooth	The user weight is over 30kg. The vehicle moves on uneven surface. The wheels or axle seized up by something. The battery with low power.	No need mend.. No need mend..Just ride the vehicle on smooth surface. Check the wheels and axle,remove the debris. Charge the vehicle in time.
The vehicle can't stop	The pedal can't rebound when remove the foot.	Check the pedal switch, remove the debris. If damaged, change a new switch.

- Contact or exposure to battery leakage (lead acid) may cause serious injury. If contact or exposure occurs immediately call your physician. If the chemical is on the skin or in the eyes, flush with cool water for 15 minutes. If the chemical was swallowed, immediately give the person water or milk. Do not give water or milk if the patient is vomiting or has a decreased level of alertness. Do not induce vomiting.
- Battery posts, terminals and related accessories contain lead and lead compounds (acid), chemicals to cause cancer, reproductive harm and are toxic and corrosive. Never open the battery.
- Tampering or modifying the electric circuit system may cause a shock, fire or explosion and permanently damage the system. Exposed wiring, circuitry in the charger may cause electric shock. Always keep the charger housing closed.

Maintenance

The vehicle should be checked for damage, missing or badly worn parts before each use.

- Check the tightness of the fasteners before each use.
- Check the tightness of the wheel locknuts.

Note: If the wheel locknuts are not tight the drive wheel will not engage and the vehicle will not run.
- Ensure the battery is securely in place before use.
- Occasionally use lightweight oil to lubricate moving parts such as wheels and steering linkage. Do not use oil on plastic or nylon parts. No lubrication is required.
- Store the vehicle indoors or cover it with a tarp to protect it from the wet weather. Keep it away from sources of heat, such as stoves and heaters.
- Clean the vehicle with a soft, dry cloth. To restore shine to plastic parts, use a non-wax furniture polish. Do not use car wax, abrasive cleaners or wash the vehicle with soap and water. Water will damage the motor, electrical system and battery.

Warning

- The toy must only be used with the recommended transformer.
- The transformer is not a toy.
- Disconnect toy from transformer before cleaning the toy with liquid.

Assembly

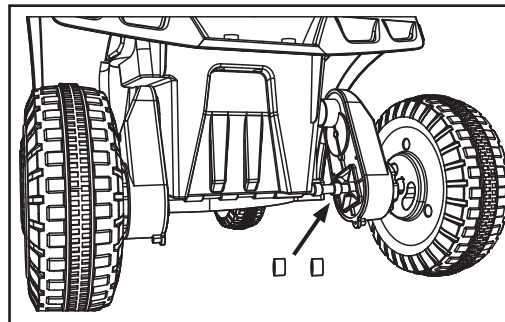

When installing the right motor, it is necessary to install two shaft bushings on the inside of the right motor

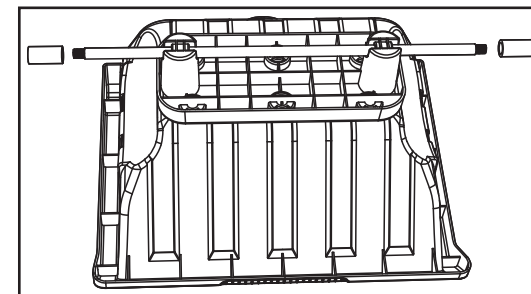
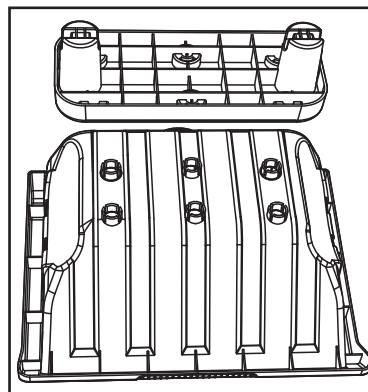

5. The drag bucket support clip into the drag bucket, then insert the axle into the drag bucket support, finally

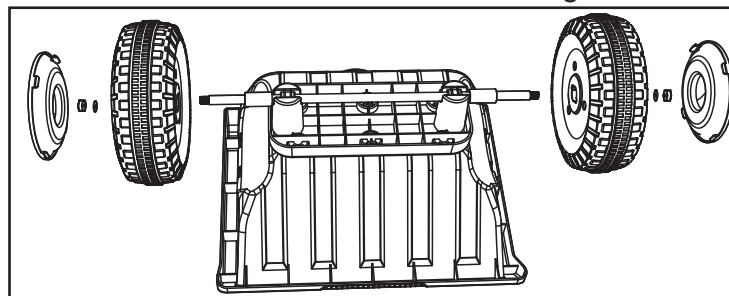

insert two shaft bushings into the axle, as same the pic.

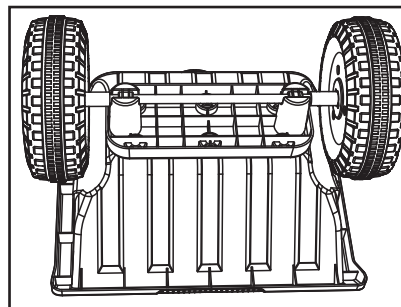

6. Insert the wheels and gaskets into the axles, then tighten the M8 nuts, finally clip into the wheel cover, as same the pic.

Assembly

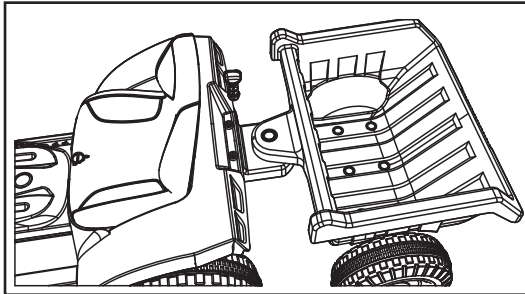

7. Insert the drag bucket into the connector, then insert the dowel pin to secure, as same the pic.

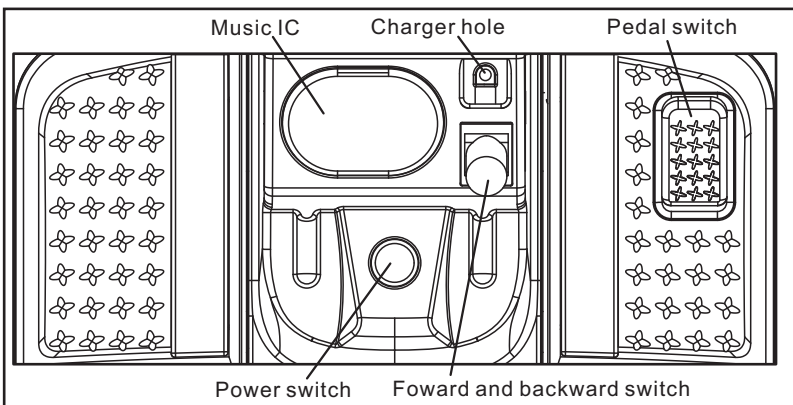
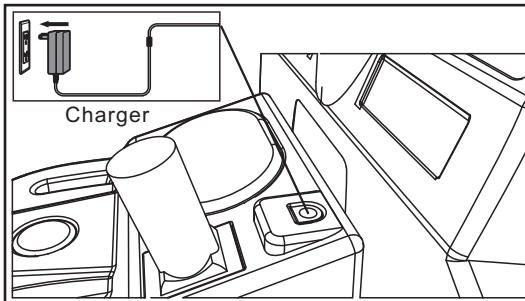
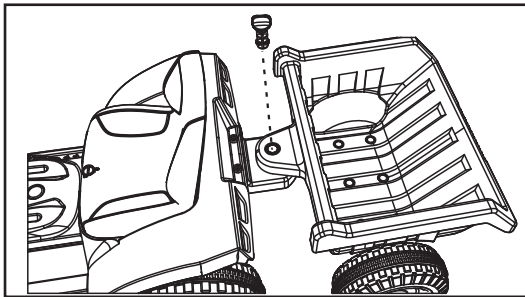

Charging the battery

- 1.Important!** Before using the vehicle for the first time the battery needs to be charged for 10-12 hours. Failure to do so may damage the battery and can't be repaired.
- 2.Insert the charger plug into charge hole on vehicle body first, then connect the other end with power supply.
- 3.Charge the vehicle when each use after 1hour, normal charging time is 10 to 12 hours.
- 4.Each charge no more than 15 hours.
- 5.Only an adult who has read and understands the safety warnings should handle, charge or recharge of the battery.
- 6.If the vehicle won't use for a long time, it need to be charged at least once per month.
- 7.The charger and the battery may be a little heating-up, it will be acceptable if the temperature less than 60 .
- 8.The charging hole and jack can't be damp or it may cause short -circuit.
- 9.Only charge the vehicle by proprietary charger which sell with the product.
- 10.**Note:** It is not necessary to remove the battery from the vehicle for charging.



Warning about battery

Failure to comply with the following safety warnings may result in serious injury or death.

- Use of a battery or charger other than the supplied 6V/12V rechargeable battery and charger may cause a fire or explosion.
- Using the 6V/12V rechargeable battery and charger for any other product may result in overheating, fire or explosion.
- Explosive gases are created during charging. Charge the battery in a well ventilated area. Do not charge the battery near heat or flammable materials.
- Contact between the positive and negative terminals may result in fire or explosion. Avoid direct contact between the terminals. Picking up the battery by the wires or charger can cause damage to the battery and may result in a fire. Always pick up the battery by it's case or handles.
- Liquids on the battery may cause fire or electric shock. Always keep all liquids away from the battery and keep the battery dry.