

Children's Toy Dump Truck

BATTERY POWERED RIDE-ON

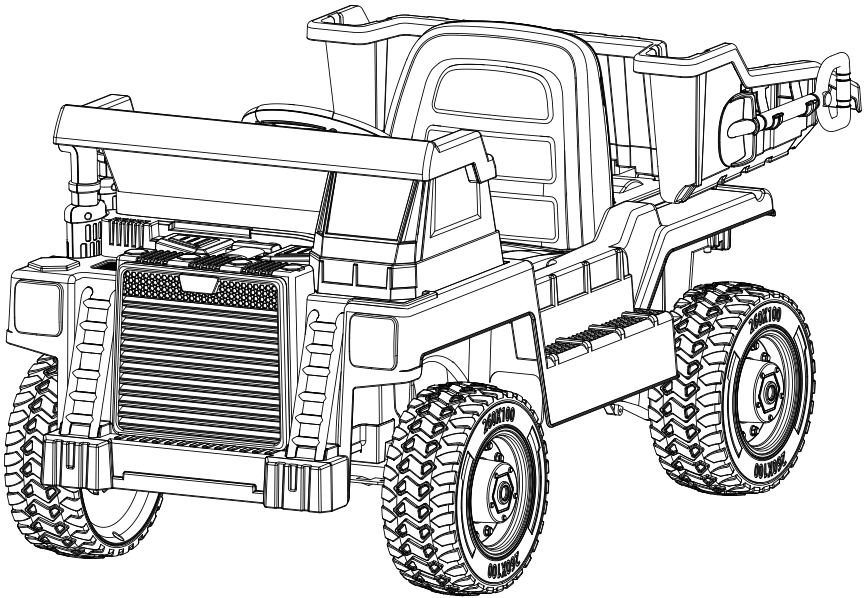

Owner's Manual with Assembly Instructions

Styles and colo(u)rs may vary.
Made in China.

The owner's manual contains important safety information as well as assembly, use and maintenance instructions.

The Ride-on Car must be assembled by an adult who has read and understands the instructions in this manual.

Keep the package away from children and dispose of properly before use.

Keep this manual for future reference.

On the purchase of your new Ride-On.

This ride-on will provide your child with many miles of riding enjoyment. To help ensure a safe ride we ask you to please read this manual carefully, and keep it for future reference.

Please follow the recommendations in this manual, they are designed to improve the safety and operation of your ride-on car and it's rider.

SPECIFICATIONS:

| | | |
|----------------|-----------|--|
| Battery | 12V7AH *1 | |
| Charger | 12V1000mA | |

Suitable age: 37-96 months

Load Capacity: Under 30kg

Speed: 3-5 km/h

Size of ride-on car: 119 x 62 x 56 CM

Power way: Charging type

Charge time: 8-12 hours

 **WARNING!**

- **CHOKING HAZARD** - Small parts. Not suitable for children under 36 months. The product contains small parts, keep children away when assembling.
- **ADULT ASSEMBLY REQUIRED.**
- Always remove protective material and poly bags and dispose before assembly.
- Protective equipment should be worn. Always wear shoes and sit in the seat when operating the vehicle.
- Only drive on level ground. Never use on the lawn.
- Keep your hands, hair, and clothes away from moving parts.
- Never leave child unattended. Direct adult supervision is required. Always keep child in view when child is in vehicle.
- To reduce the risk of injury, adult supervision is required. Never use in roadways, near motor vehicles, on or near steep inclines or steps, swimming pools or other bodies of water, always wear shoes, and never allow more than 1 rider.
- Never use in unsafe conditions such as snow, rain, loose dirt, mud, sand, or gravel, otherwise may result in an unexpected accident such as tipping over, and could damage the electrical system or battery
- Not to be used in traffic.
- This toy should be used with caution since skill is required to avoid falls or collisions causing injury to the user or third parties.
- This toy is unsuitable for children under 36 months due to its maximum speed; Maximum user weight is 30kg.
- This toy has no brake.

 **BATTERY INFORMATION**

- Non-rechargeable batteries are not to be recharged.
- Rechargeable batteries are to be removed from the toy before being charged.
- Rechargeable batteries are only to be charged under adult supervision.
- Different types of batteries or new and used batteries are not to be mixed.
- Batteries are to be inserted with the correct polarity.
- Exhausted batteries are to be removed from the toy.
- The supply terminals are not to be short-circuited.

 **WARNING!**

The remote control is not a toy, and is only allowed to be operated by adults.

Parts List | 4

| PART NO. | PART NAME | Q'ty (pcs) | | REMARKS |
|----------|-------------------|------------|-----|---|
| | | 2WD | 4WD | |
| 1 | Vehicle body | 1 | 1 | |
| 2 | Rear gear box | 2 | 2 | Placed on the vehicle body |
| 3 | Ø12 washer | 11 | 9 | 1pc placed in the assembly package, others placed on the front and rear axle. |
| 4 | Snap ring | 1 | 1 | Placed in the assembly package |
| 5 | Rear wheel | 2 | 2 | |
| 6 | Front wheel | 2 | 2 | |
| 7 | Lock nut | 6 | 6 | Placed on the front & rear axles |
| 8 | Hubcap | 4 | 4 | Placed in the assembly package |
| 9 | Front axle | 1 | 1 | |
| 10 | Rear axle | 1 | 1 | |
| 11 | Steering wheel | 1 | 1 | |
| 12 | Seat back | 1 | 1 | |
| 13 | Seat | 1 | 1 | |
| 14 | Ø4x12 screw | 30 | 30 | Placed in the assembly package |
| 15 | Ø4x16 screw | 2 | 2 | Placed in the exhaust package |
| 16 | Exhaust | 1 | 1 | |
| 17 | Cab | 1 | 1 | |
| 18 | Seat lock bracket | 1 | 1 | |
| 19 | Dump | 1 | 1 | |
| 20 | Windshield | 1 | 1 | |
| 21 | Spade clip | 2 | 2 | Placed in the assembly package |
| 22 | Spade | 1 | 1 | |
| 23 | Spanner | 2 | 2 | Placed in the assembly package |
| 24 | Charger | 1 | 1 | |
| 25 | Remote controller | 1 | 1 | For R/C type only |

Assembly tools required (not included):



Screwdriver

HINT: If your product is All Wheel Drive (4WD), please refer to the page 6a & 6b to attach the front wheels.

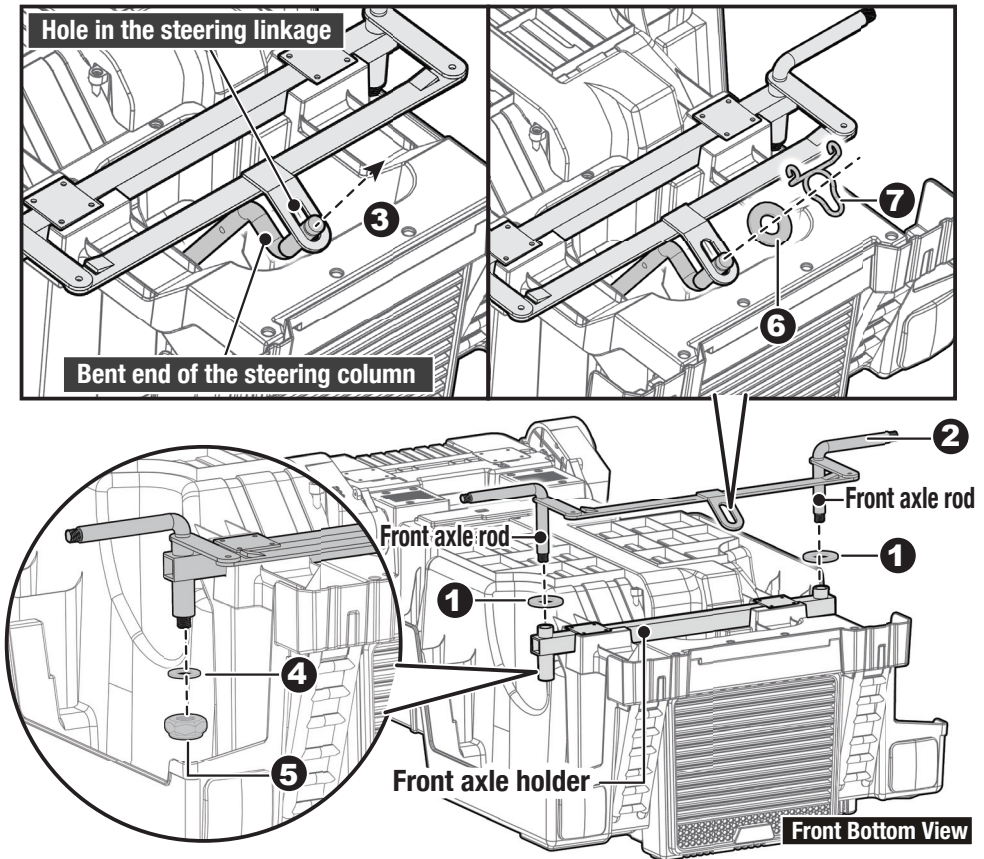

Turn the vehicle body upside down. Remove all the parts from the front axle.

1. Slide a $\varnothing 12$ washer onto the each front axle rod.
2. Fit the front axle rods into the holes at both ends of the front axle holder.
3. Insert the bent end of the steering column into the hole in the steering linkage.
- 4-5. Slide a $\varnothing 12$ washer onto the front axle rod. Tighten a $\varnothing 10$ locknut to the end of the front axle rod with a spanner. Repeat for the other side.
6. Fit a $\varnothing 12$ washer onto the bent end of the steering column.
7. Fit the snap ring into the groove in the bent end of the steering column.

2WD (Dual-Wheel Drive)-Attach the Front Wheels | 5b

HINT: If your product is All Wheel Drive (4WD), please refer to the page 6a & 6b to attach the front wheels.

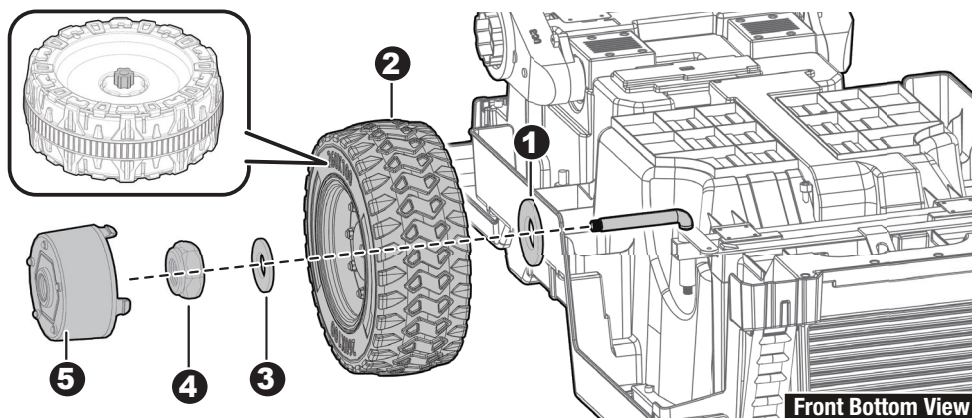

1. Slide a $\varnothing 12$ washer onto the front axle.
2. Slide a wheel onto the front axle.
3. Slide a $\varnothing 12$ washer onto the front axle.
4. Tighten a lock nut to the end of the front axle with a spanner. **DO NOT** over tighten.
5. “Snap” the hubcap to the wheel.

Repeat the above procedure to assemble the other Front Wheel.

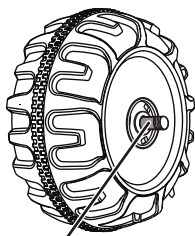

GAP

After assembling any wheel to the axles, please check the gap between the screw thread and the collapsible (refer to below picture), if the gap is too big, please add two or three washers inside the wheel, but after tightening the nut outside the wheel, please turn the wheel by your finger to check if the wheel can run smoothly, this is very important, because if the wheel can run smoothly, it is ok, but if the nut press the wheel and the wheel can't run smoothly, the motor will be broken easily! Then you need to decrease one or two washers to make sure the wheel can run smoothly!

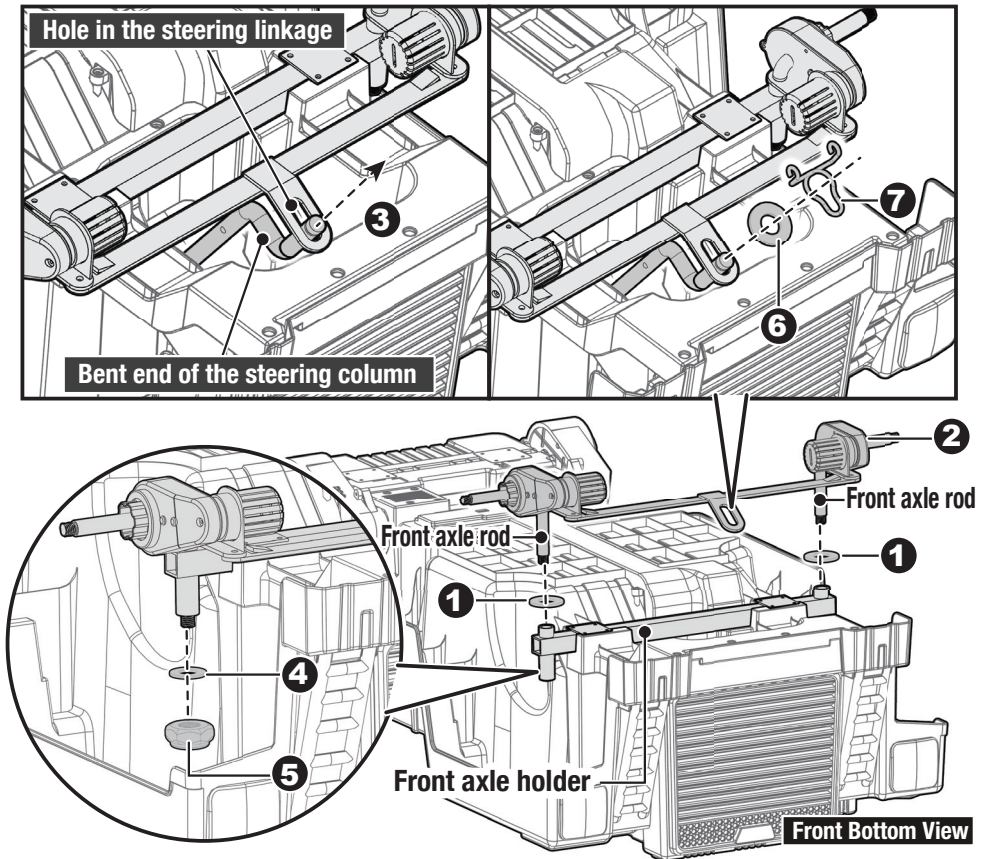

Turn the vehicle body upside down. Remove all the parts from the front axle.

1. Slide a $\varnothing 12$ washer onto the each front axle rod.
2. Fit the front axle rods into the holes at both ends of the front axle holder.
3. Insert the bent end of the steering column into the hole in the steering linkage.
- 4-5. Slide a $\varnothing 12$ washer onto the front axle rod. Tighten a $\varnothing 10$ locknut to the end of the front axle rod with a spanner. Repeat for the other side.
6. Fit a $\varnothing 12$ washer onto the bent end of the steering column.
7. Fit the snap ring into the groove in the bent end of the steering column.

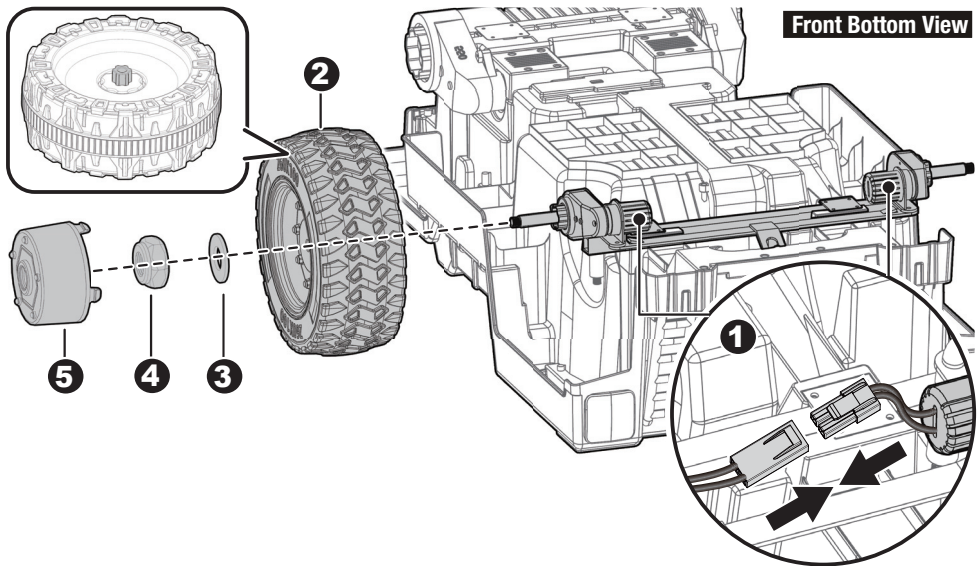

1. Plug the connector on the front gear box into the connector from the vehicle body.
2. Slide a wheel onto the front axle.
3. Slide a $\varnothing 12$ washer onto the front axle.
4. Tighten a lock nut to the end of the front axle with a spanner. DO NOT over tighten.
5. “Snap” the hubcap to the wheel.

Repeat the above procedure to assemble the other Front Wheel.

Attach the Rear Wheels | 7

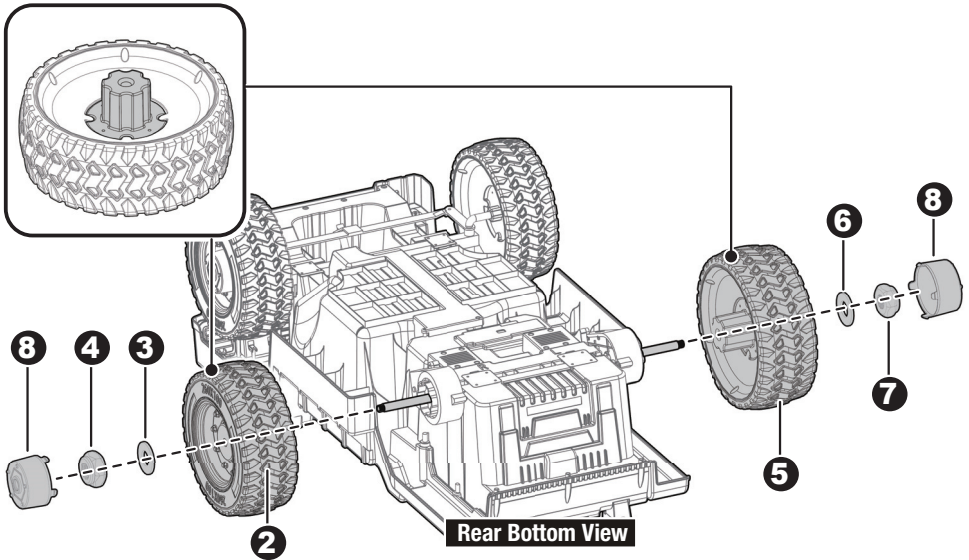
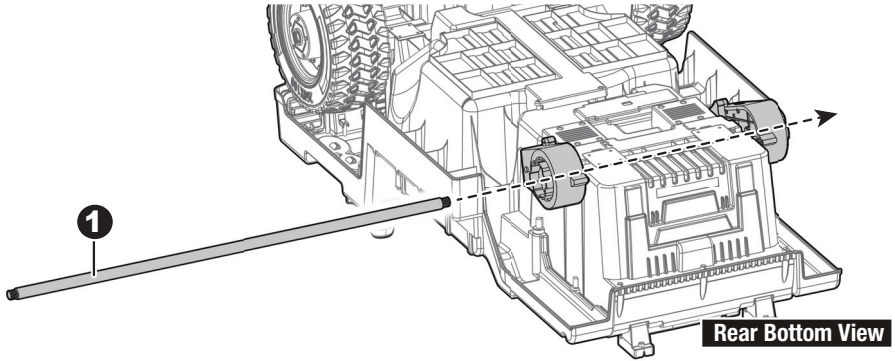

1. Cut off the plastic tie on the both rear gear boxes with scissors. Remove all the parts from the rear axle. Insert the rear axle through the hole in the vehicle body, when inserting it half way, lift the another gear box so that the rear axle can go through it and protrude out. Make sure that the rear axle is centered with left and right ends exposed the same distance outside of the vehicle body.
2. Fit a rear wheel onto the rear axle.
3. Slide a $\varnothing 12$ washer onto the rear axle.
4. Tighten a $\varnothing 10$ locknut to the end of the rear axle with a spanner (included).
- 5-7. Repeat steps 2-4 to assemble the other rear wheel. **HINT:** An extra spanner has been provided to hold the Lock nut on the other side of the rear axle while tightening the lock nut on the other side.
8. Snap the hubcaps to the wheels.

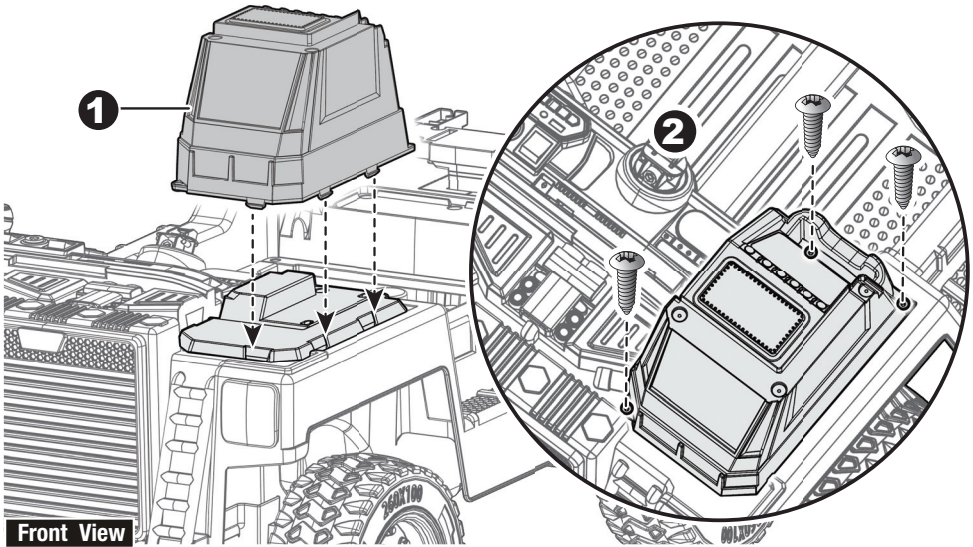

Front View

- Turn the vehicle body on upright.
- 1. Fit the cab to the vehicle body,
- 2. Insert and tighten three Ø4x12 screws with a screwdriver.
- 3. Fit the exhaust to the groove in the top of the vehicle body.
- 4. Insert and tighten a Ø4x12 screw with a screwdriver.

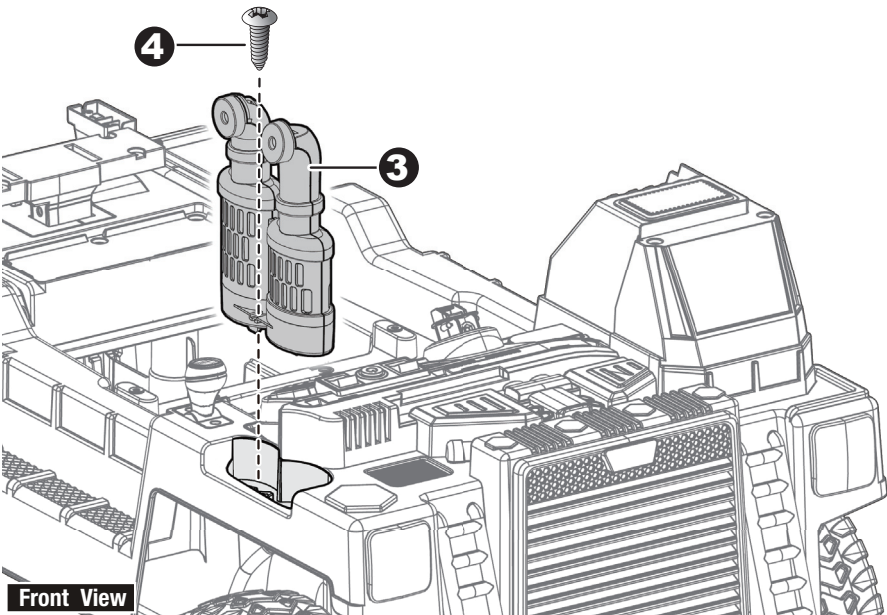

Front View

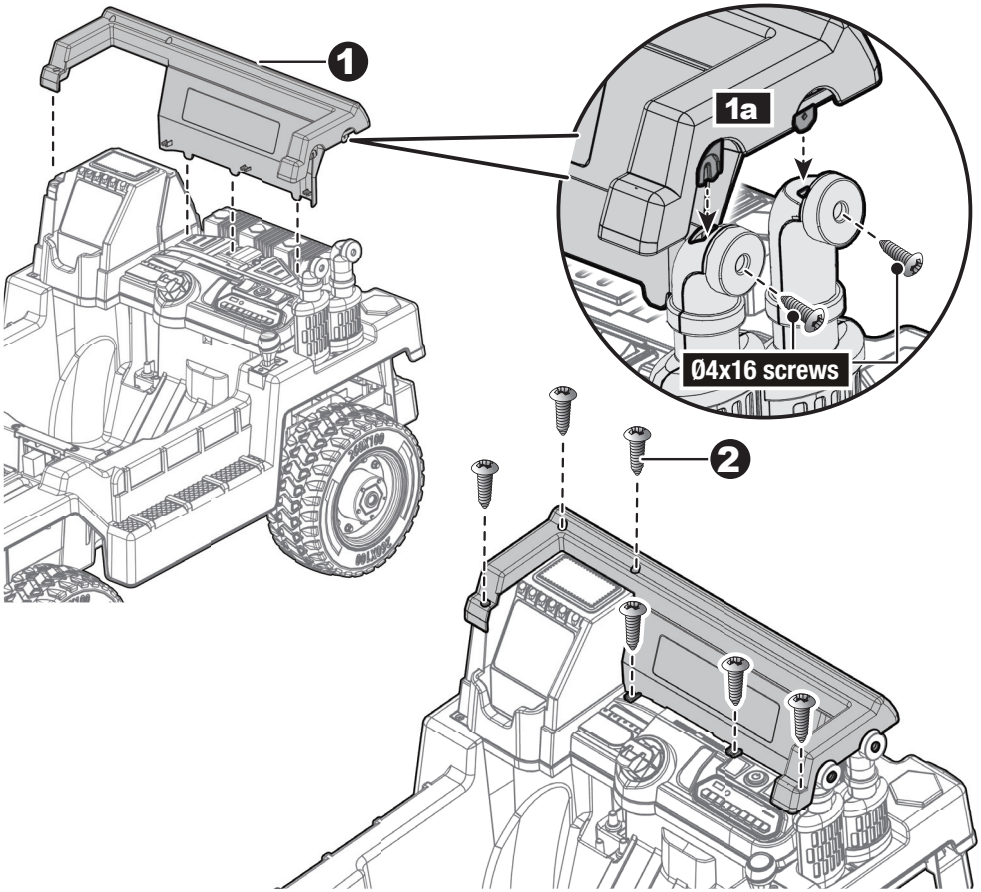

1. Fit the windshield to the vehicle body, make the two screw studs insert into the holes on the top of the exhaust as fig 1a, insert and tighten two **Ø4x16 screws** with a screwdriver.
2. Insert and tighten six **Ø4x12 screws** with a screwdriver.

Please follow the steps 1-4 to add the batteries (Not Included), and refer to the battery information on page 2.

1. With a screwdriver loosen the screw on the battery cover located in the center of the steering wheel.
2. Remove the battery cover from the top of the battery compartment.
3. Insert 2x1.5 AA batteries in their correct polarities.
4. Place the battery cover over the battery compartment and fasten with the screw you loosened in step one.

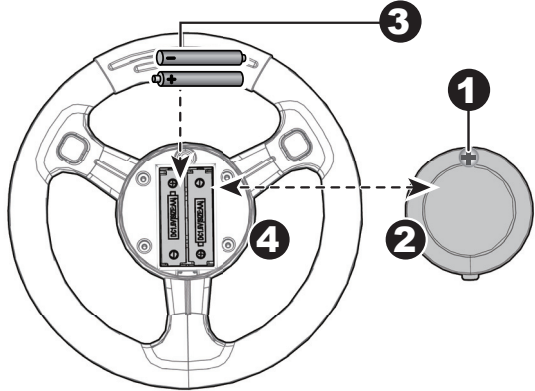

Attach the Steering Wheel

5. Insert the steering wheel to the steering wheel linkage, push until you hear it “click” into place.

HINT: There is an unlock button under the steering wheel, pressing and holding the unlock button can remove the steering wheel easily .

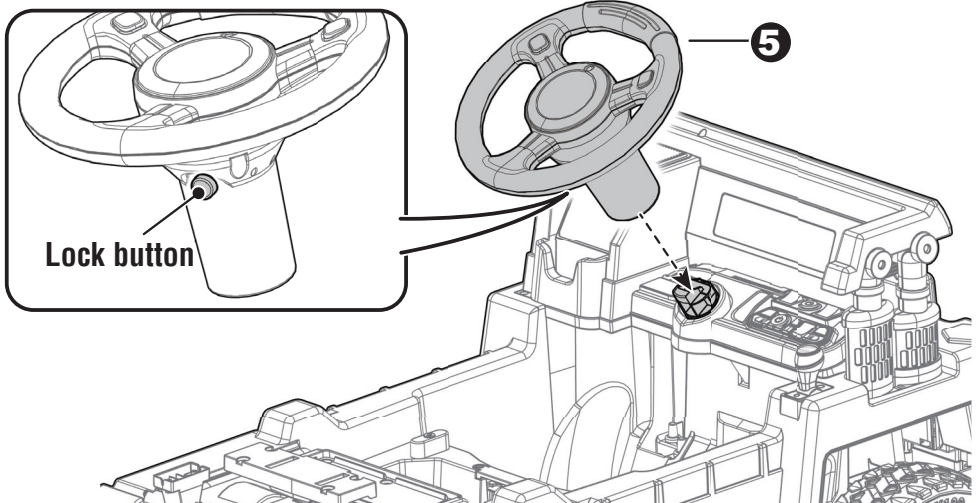

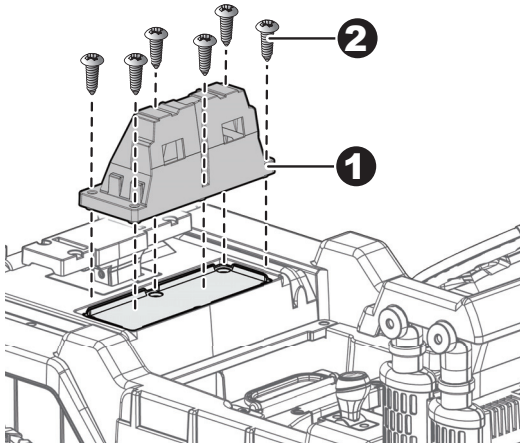

Bottom left view of dump

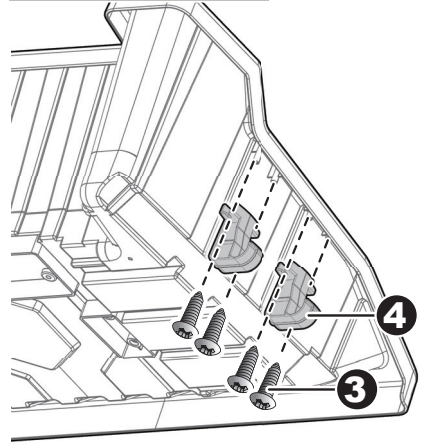

1. Fit the seat lock bracket to the vehicle body,
2. Insert and tighten six $\text{\O}4 \times 12$ screws with a screwdriver.
- 3-4. Place the left side of dump up, fit a spade clip to the left side of the dump, insert and tighten two $\text{\O}4 \times 12$ screws with a screwdriver. Repeat for the other spade clip.
- 5-6. Fit the dump to the rear side of the vehicle body. Insert and tighten eight $\text{\O}4 \times 12$ screws with a screwdriver.
7. Fit the spade to the clips on the left side of the dump.

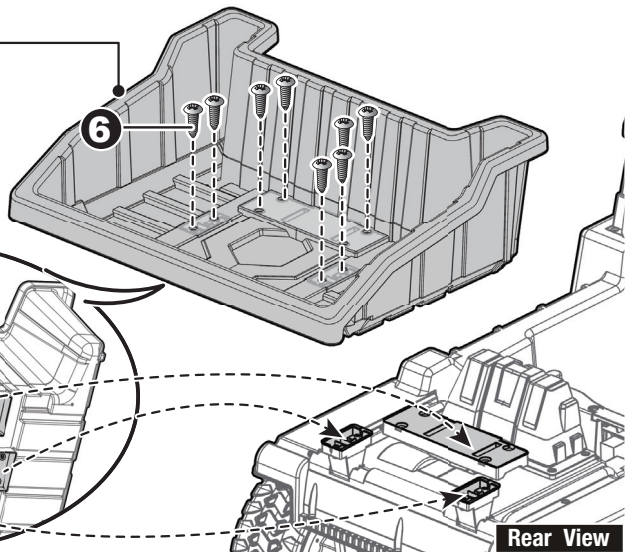
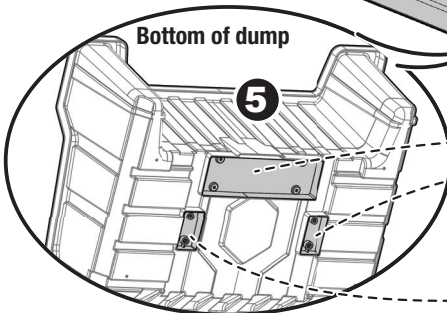
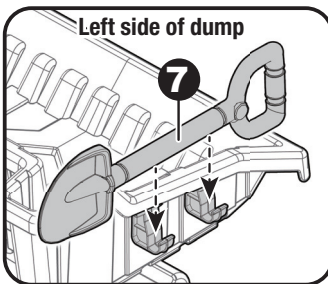

Rear View

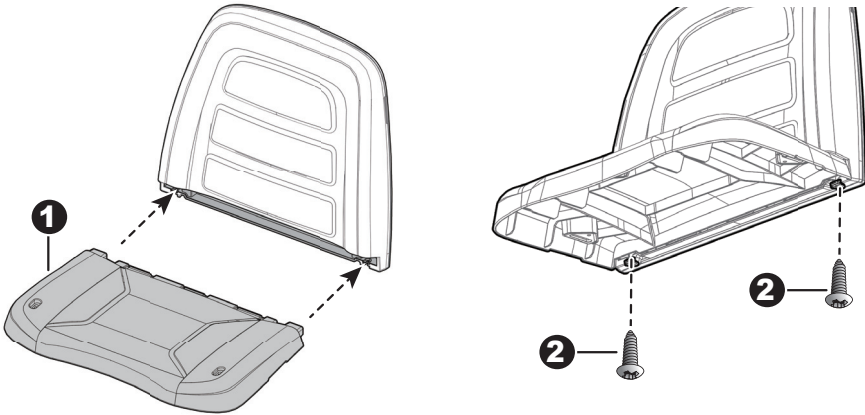

1. Fit the seat to the seat back.
2. Insert and tighten two $\varnothing 4 \times 12$ screws with a screwdriver from the bottom of the seat.
3. Plug the **red** vehicle connector into the **red** connector on the battery.
4. Fit the tabs on the seat back into the holes in the seat lock bracket
5. Use a screwdriver to tighten the both M5x16 screws at the top of the seat into the holes in the vehicle.

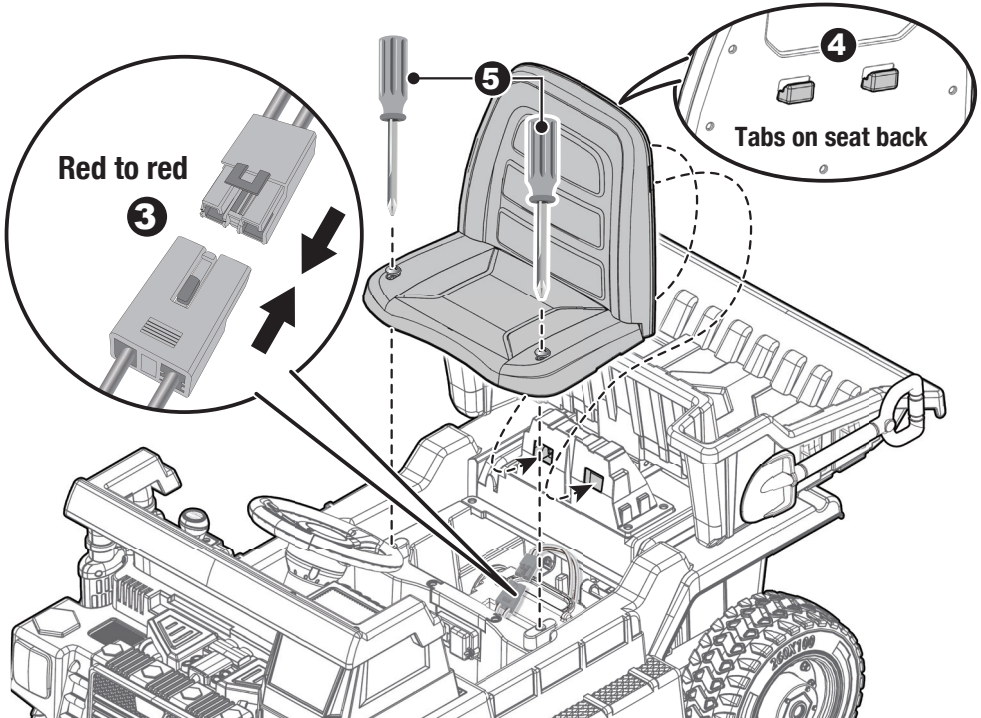

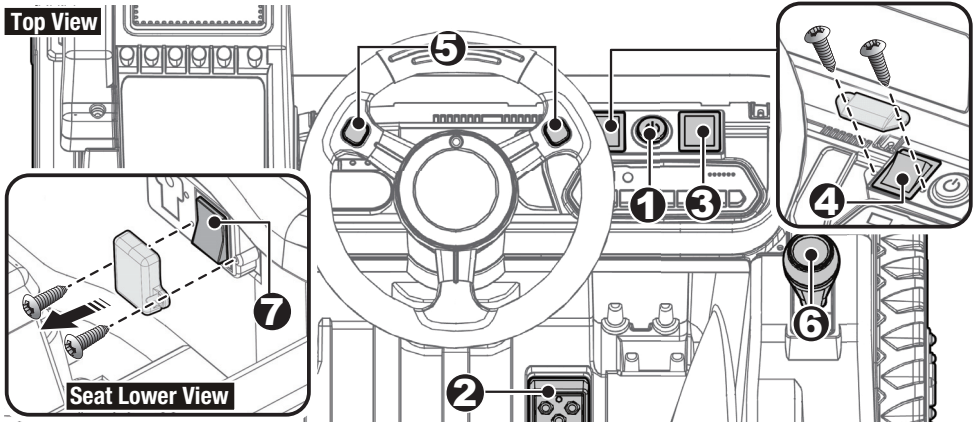

1. **Power button:** Turns the product on and off.
2. **Foot pedal:** Applies power (speed) to the product.
 - To move the product, press the pedal down.
 - To brake or slow down, release pressure from the pedal.
3. **Forward/stop/reverse switch:** Changes the direction that product moves from forward to reverse.
 - To move the product forward, press the switch to “forward” position.
 - To move the product backward, press the switch to “reverse” position.
 - Move the switch in the middle (stop), the product will stop and not run.
4. **High/Low speed switch:** (If equipped, the protective cover must be removed by an adult.): Operates the product to move forward in high speed or low speed.
5. **Sound buttons:** Press for sound playing.
6. **Dump lever:**
 - To tip the dump, pull the lever back.
 - To reset the dump back, push the lever forward.
7. **R/C - PEDAL Switch:** (If equipped, below the seat, the protective cover must be removed by an adult.)
 - Rock the switch to ‘R/C’ position, user could use R/C to control the car.
 - Rock the switch in ‘PEDAL’ position, the car will only work by pedal.

⚠ **WARNING**

- Always stop vehicle when changing the speed or direction to avoid damage the gears and motor.
- **HIGH SPEED:** Make sure your child knows how to steer, how to start and stop the product and knows the rules for safe driving.
- The protective cover must be removed by an adult.
- No stepping, climbing, sitting, lying on or in dump bed.
- Never ride in dump bed.
- Maximum load weight on the dump is 5 kg (11 lb).

WARNING!

- **ONLY an adult is allowed charge and recharge the battery!**
- **This product with Charging Protection: when charging, all functions will be cut off.**

- The POWER SWITCH must be turned in OFF position when charging.
- Before the first use, you should charge the battery for 4-6 hours. Do not recharge the battery for more than 10 hours to avoid overheating the charger.
- When the vehicle begins to run slowly, recharge the battery.
- After each use or once a month minimum recharge time as 8 to 12 hours, less than 20 hours at most.
- Use only battery(ies) and charger specified by the manufacturer. Using another battery or charger may cause a fire or explosion. Do not use the battery or charger for any other product.
- If your ride-on with a Digital voltmeter, the magnitude of voltage will tell you how much power is remaining in the battery when you must recharge the battery. Make sure the vehicle is stop!

| | | |
|-------------|-----------------|--|
| 12V product | less than 12.5V | The battery needs to be charge. |
| | | |

Charging Way I

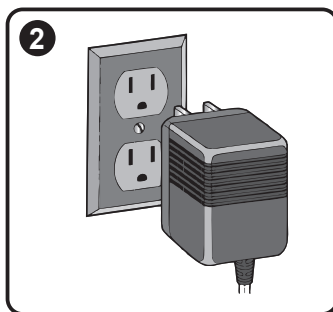
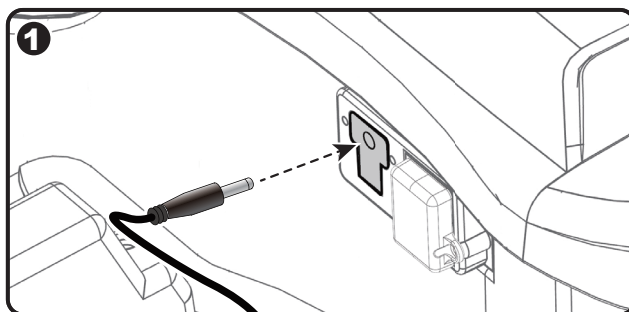

1. Plug the charger port into the input socket (the socket is below the seat).
2. Plug the charger plug into a wall outlet. The battery will begin charging.

Battery Disposal



The battery will eventually lose the ability to hold a charge. Depending on the amount of use, and varying conditions, the battery should operate for one to three years.

Important! Recycle the dead battery responsibly. The battery contains lead acid (electrolyte) and must be disposed of properly and legally. It is illegal in most areas to incinerate lead acid batteries or dispose of them in landfills. Take it to a federal or state-approved lead acid battery recycler, such as local automotive battery retailer.

Do not throw the battery away with your regular household waste!

Charging Way II

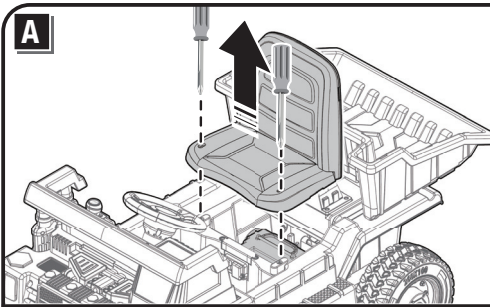

A: Use a screwdriver to loosen the two screws on the top of the seat and remove the seat.

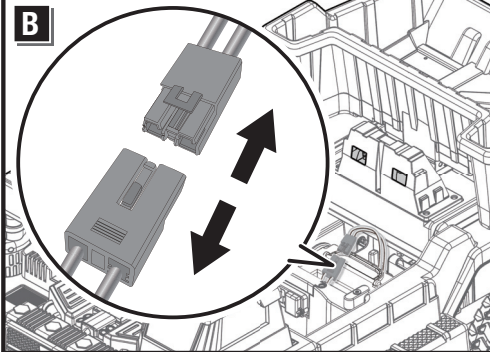

B: Unplug the red connectors from each other.

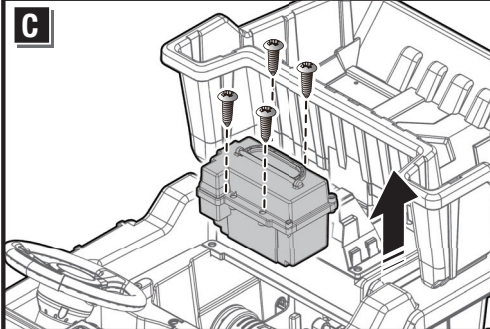

C: Loosen the four screws around the battery box with a screwdriver and lift the battery box up.

D: Place the battery box on a flat ground. Plug the charger port into the input socket on the battery box.

E: Plug the charger plug into a wall outlet. The battery will begin charging.

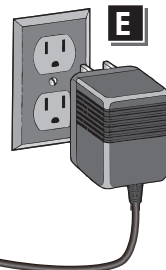
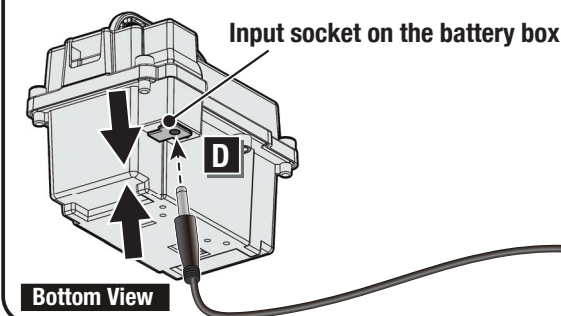

| Problem | Possible Cause | Solution |
|--|---|--|
| Vehicle does not run | Battery low on power | Recharge battery. |
| | Thermal fuse has tripped | Reset fuse, see <Fuse> |
| | Battery connector or wires are loose | Check that the battery connectors are firmly plugged into each other. If wires are loose around the motor contact your distributor please. |
| | Battery is dead | Replace battery, contact your distributor please. |
| | Electrical system is damaged | Contact your distributor please. |
| | Motor is damaged | Contact your distributor please. |
| Vehicle does not run very long | Battery is under charged | Check that the battery connectors are firmly plugged into each other when recharging |
| | Battery is old | Replace battery, contact your distributor please. |
| Vehicle runs sluggishly | Battery low on power | Recharge battery, contact your distributor please. |
| | Battery is old | Replace battery, contact your distributor please. |
| | Vehicle is overload | Reduce weight on vehicle. |
| | Vehicle is being used in harsh conditions | Avoid using vehicle in harsh conditions, see <User Notice>. |
| Vehicle needs a push to go forward | Poor contact of wires or connectors | Check that the battery connectors are firmly plugged into each other. If wires are loose around the motor, contact your distributor please. |
| | “Dead Spot” on motor | A dead spot means the electric power is not being delivered to the terminal connection and the vehicle needs repair. Contact your distributor please. |
| Difficult shifting from forward to reverse or vice-versa | Attempting to shift while the vehicle is motion | Completely stop the vehicle and shift, see <Use Your Ride-On> |
| Loud grinding or clicking noises coming from motor or gear box | Motor or gears are damaged | Contact your distributor please. |
| Battery will not recharge | Battery connector or adapter connector is loose | Check that the battery connectors are firmly plugged into each other. |
| | Charger not plugged in | Check that the battery charger is plugged into a working wall outlet. |
| | Charger is not working | Contact your distributor please. |
| Charger feels warm when recharging | This is normal and not a cause for concern | |

Completely read through this manual and the troubleshooting guide table before calling. If you still need help resolving the problem **Contact your distributor please.**

- It is parents' responsibility to check main parts of the toy before using, Must regularly examine for potential hazard, such as the battery, charge, cable or cord, plug, screws are fastening enclosure of other parts and that in the event of such damage, the toy must not be used until that damage had been properly removed.
- Park the vehicle indoors or cover it with a tarp to protect it from wet weather.
- Recharge the battery after each use. Only an adult can handle the battery. Recharge the battery at least once a month when the vehicle raider is not being used.
- Do not wash the vehicle with a hose. Do not wash the vehicle with soap and water. Do not drive the vehicle in rainy or snowy weather. Water will damage the motor, electric system and battery.
- Clean the vehicle with a soft, dry cloth. To restore shine to plastic parts, use a non-wax furniture polish. Do not use car wax. Do not use abrasive cleaners.
- When not using, all the electrical source should be turn off. Turn off the power switch and disconnect the battery connection.

Fuse

The battery features a thermal fuse with a reset fuse that will automatically trip and cut all power to the vehicle if the motor, electric system or battery is overloaded. The fuse will reset and power will be restored after the unit is turned OFF for 20 seconds and then turned ON again. If the thermal fuse trips repeatedly during normal use, the vehicle may need repair. **Contact your distributor please.**

To avoid losing power, follow these guidelines:

- Do not overload the vehicle.
- Do not tow anything behind the vehicle.
- Do not drive up steep slopes.
- Do not drive into fixed objects, which may cause the wheels to spin, causing the motor to overheat.
- Do not drive in very hot weather, components may overheat.
- Do not allow water or other liquids to come in contact with the battery or other electric components.
- Do not tamper with the electric system. Doing so may create a short, causing the fuse to trip.



RISK OF FIRE. Do not bypass. Replace only with a new fuse.

**Our products are suitable for
ASTM F963; GB6675; EN71 and EN62115 standard.**