

Owner's Manual & Safety Instructions

Save This Manual Keep this manual for the safety warnings and precautions, assembly, operating, inspection, maintenance and cleaning procedures. Keep this manual and the receipt in a safe and dry place for future reference.

 **TOPKEY**[®]

46" 9-DRAWER CABINET WITH WOOD TOP



HYXTB4609

Ensure all components are present. If any components are missing, do not proceed with assembly. Please send an email to customerservice@topkeyus.com

⚠ WARNING

Read this material before using this product. Failure to do so can result in serious injury.

SAVE THIS MANUAL.

SAFETY INFORMATION

1. Do not pull this unit, push it when moving.
2. Use the brakes when this product is not being moved. This prevents the product from rolling.
3. Secure this product properly before moving it with a forklift.
4. Do not tow the product with power equipment.
5. Do not alter this product in any manner. For example, do not weld external lock bars or attach electrical equipment.
6. When locking a cabinet, close the drawers completely in order for the rear lock bars to work properly.

7. Extension cord:

- Do NOT insert extension cord through hole without grommet in place.
- Only use a three-wire extension cord with all three prongs intact. Never remove the round grounding prong.
- Extension cord must be connected to a 125Volt GFCI protected outlet with proper ground. If GFCI outlet is not available, use an extension cord with GFCI protection built in.

- Check the insulation and plugs of extension cord before using. Do NOT use cord if it is worn or damaged.
- Do NOT overload extension cord.
- Remove extension cord from the hole before moving or transporting storage cabinet.
- Do NOT connect extension cord to outlet that also supplies critical safety equipment with power.
- Make sure the power supply cord is unplugged before any servicing or cleaning.

8. Electrical shock hazard

- Do not plug cord into outlet with wet hands.
- Do not use this tool cabinet near a bathtub, a shower, or a swimming pool.
- Cabinet plugs must match the outlet.
- Never modify the plug in any way.
- Do not use any adapter plugs with earth (grounded) chest power strips.
- Unmodified plugs and matching outlets will reduce the risk of electric shock.
- Avoid body contact with earthed or grounded surfaces. There is an increased risk of electric shock if your body is earthed or grounded.



CAUTION: Do not attach or mount this product to a vehicle. This may cause personal injury or product damage. Mounting this product to any vehicle in any manner will void warranty.



CAUTION: Lock the drawers before moving this product. The drawers could come open and make the product unstable and tip, which may cause personal or product damage.



CAUTION: Do not stand or step on this product. You may fall which may cause personal injury.



CAUTION: Keep children and bystanders away while loading, unloading and moving the product.



CAUTION: Be careful when opening more than one drawer. The product may become unstable and tip, which may cause personal injury or product damage.



CAUTION: Do not exceed the maximum drawer weight, wood top or total product weight, including contents. Always balance the loads to avoid tipping. Place the heavier weights on the bottom drawers when possible.



CAUTION: Keep the product on level surfaces. The product may become unstable and tip if stored or moved on an unlevel surface, which may cause personal injury or product damage.



CAUTION: Changes or modifications not expressly approved by the party responsible for compliance could void the user's authority to operate the equipment.

Specifications

Maximum drawer capacity	100 lbs.
Maximum total capacity	1200 lbs.



NOTE: Begin product assembly close to the final intended location of your cabinet. This product is heavy and may be difficult to move after assembly.

Package Contents

HARDWARE INCLUDED



NOTE: Hardware not shown to actual size.

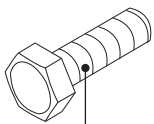

AA

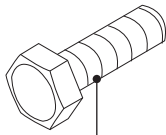

BB



CC



DD



EE

ALTERNATIVE TOOLS FOR ASSEMBLY (NOT INCLUDED)



10mm and 14mm
wrench or socket

Part	Description	Quantity
AA	M6 x 20 bolt	8
BB	M8 x 25 bolt	16
CC	Spring washer	16
DD	Flat washer	16
EE	Wrench	1

Parts Contents

PARTS LIST

Part	Description	Qty
A	Wood Top	1
B	Cabinet	1
C	Side Handle	1
D	Storage hook	2
E	Fixed Caster	2

Part	Description	Qty
F	Swivel Caster	2
G	Drawer A	1
H	Drawer B	4
I	Drawer C	2
J	Drawer D	2

ASSEMBLY DIAGRAM

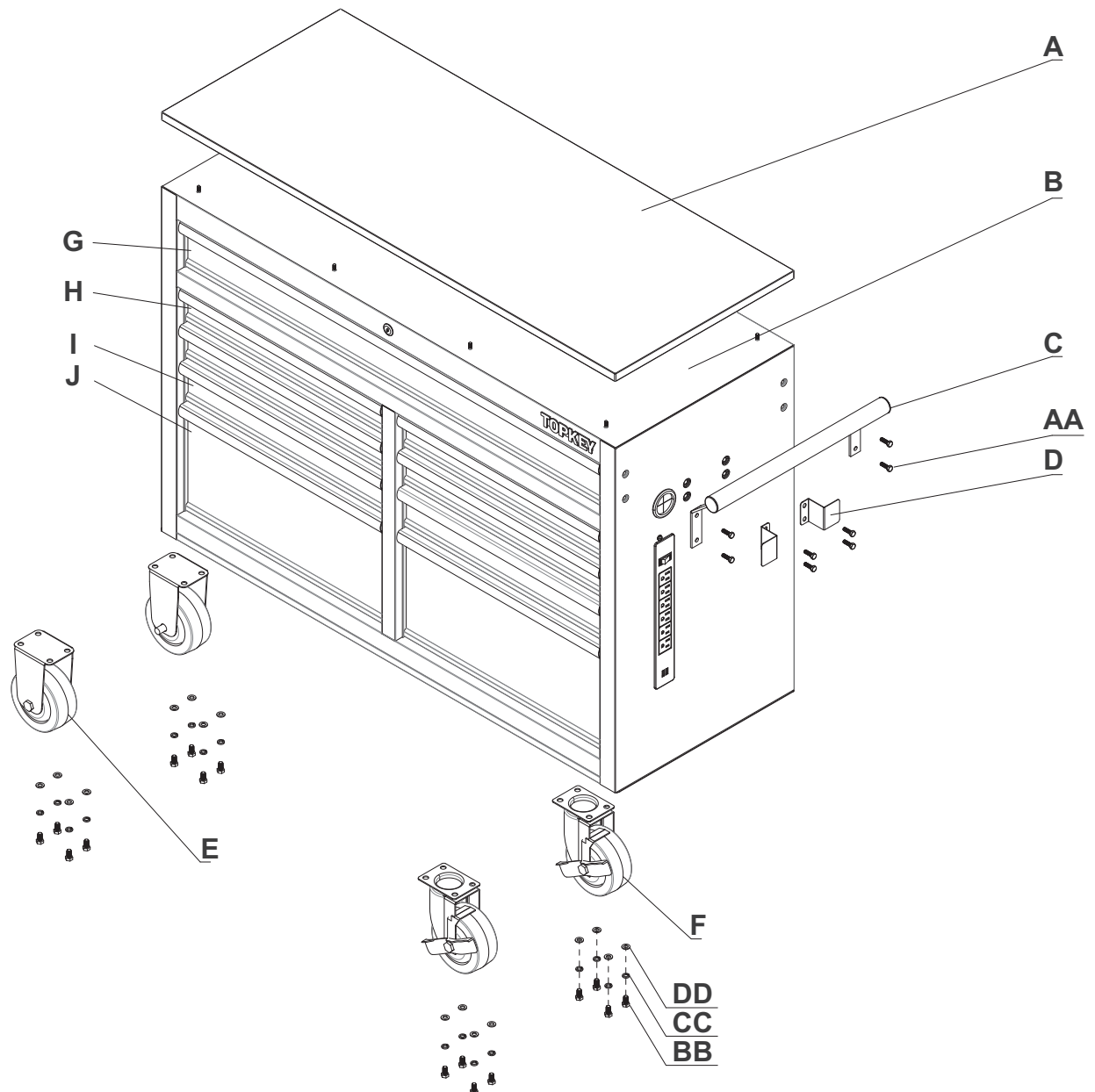

Assembly Instructions



Read the **ENTIRE IMPORTANT SAFETY INFORMATION** section at the beginning of this document including all text under subheadings therein before set up or use of this product.

1. Assemble on a flat, level, hard and smooth surface capable of safely supporting a fully loaded Cabinet.
2. Attach Side Handle (C) to either side of Cabinet using four M6 × 20 Bolts (AA). Attach Storage hook (D) to Cabinet using four M6 × 20 Bolts (AA).
3. Attach two Swivel Casters (F) to the same side as Handle using eight Flat Washers (DD), eight Spring Washers (CC), and M8 × 25 Bolts (BB).

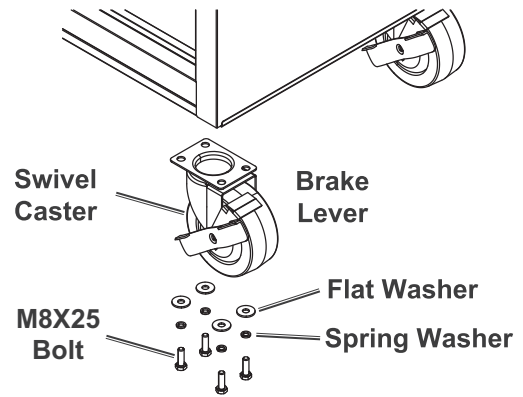
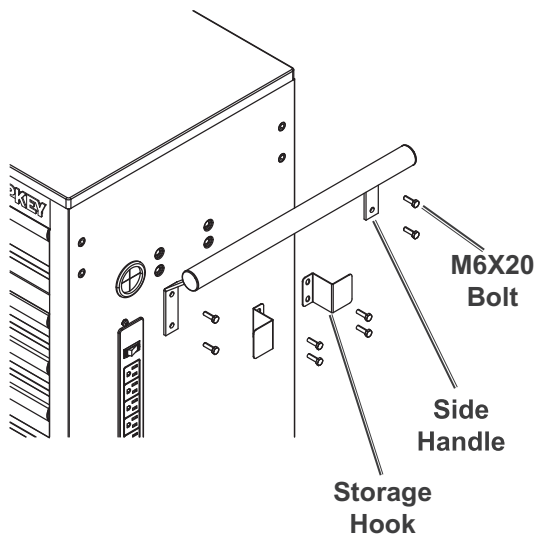

4. Attach two Fixed Casters (E) to the other side using eight Flat Washers (DD), eight Spring Washers (CC), and M8 × 25 Bolts (BB).
5. Lock the Swivel Casters by depressing the brake levers.

Operation Instructions

1. Removing the drawers

Fully extend the empty drawer.
Push up the one release lever while pulling down on the other release lever.
Pull the drawer outward until it is released from the drawer slide.

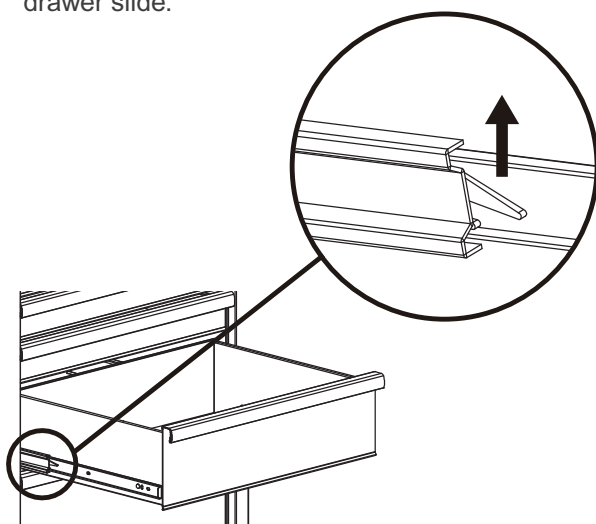

2. Re-inserting the drawers

Extend the drawer slides.
Insert the brackets on each side of the drawer into the slots in the slides, being careful that they are properly positioned.
Once properly inserted, completely close the drawer to set slides in their proper positions.

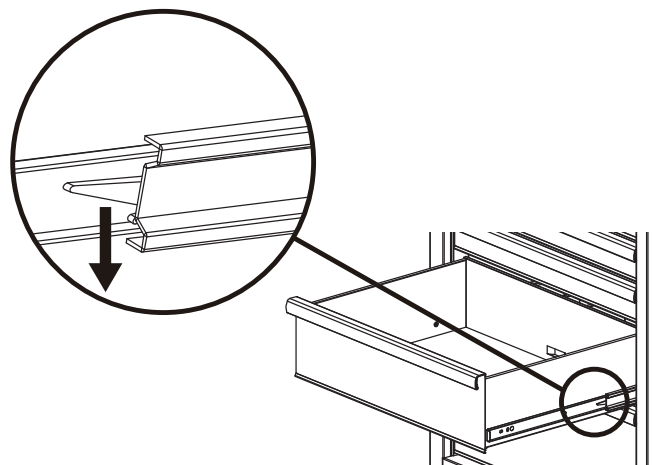

Operation Instructions

3. Installation of power cord

Cord for power strip is located inside top, right-half drawer of cabinet. Unroll cord and push the prong end through the pass-through grommet. Once cord is pulled all the way through grommet, wrap cord around storage hooks to secure when not in use.

BE SURE TO FOLLOW ALL ELECTRICAL SAFETY PRECAUTIONS.

4. Usage of rubber grommet

When not in use, always store the cord prong end of power strip inside cabinet (pushing back through the pass-through grommet). Once the prong end has passed through grommet, pull the cord back a few inches away from cabinet to ensure the pass-through grommet flaps are facing exterior of the cabinet, not interior. This ensures the inside of the cabinet is not exposed to environmental elements.

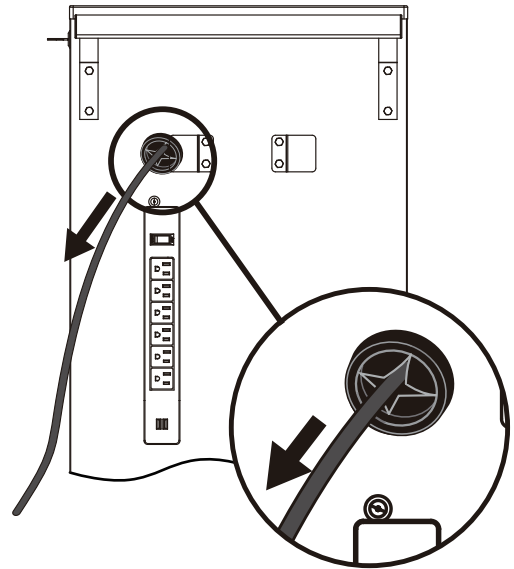

Cordless Power Tool Battery Chargers

- See Charger's Owner's Manual for proper use and care of charger and batteries. Follow all Warnings and Instructions provided with your battery charger.
- Place chargers and electrical connections in till.
- Chargers are for use in dry locations only. Do NOT expose to liquid, vapor, or rain. Should your charger become wet, do NOT attempt to use. Unplug extension cord from supply before handling wet charger or cords.
- Only use chargers and batteries that are intact and operating properly.
- Do NOT touch metal prongs when plugging charger into an extension cord.
- Keep flammable materials like paper or rags away from charger, cords or connections.
- Do NOT place or attempt to charge lead acid, or car type batteries in the storage cabinet.

1. Caster maintenance

Grease the casters annually using high-quality bearing grease.

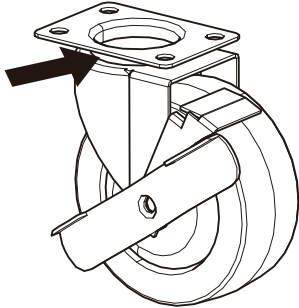

2. Drawer maintenance

Lubricate the slides semi-annually with high-quality bearing grease.

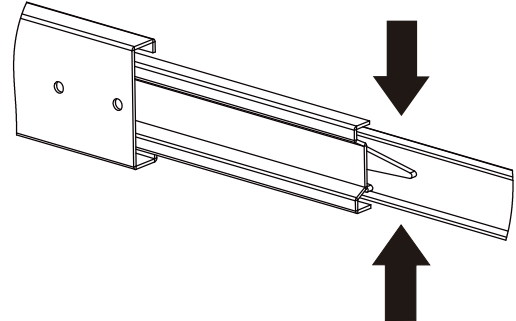

Periodically clean the drawer fronts, drawer trim, and other surfaces with a mild detergent and water. Auto wax preserves the storage unit's luster finish and protects against scratches. Apply the wax as you would on a car. Remove grease and oil with a standard nonflammable cleaning fluid.

Periodically inspect the general condition of the cabinet.

Check for: loose hardware misalignment or binding of moving parts, brake operation, caster swivel function and movement, cracked or broken parts, any other condition that may affect its safe operation.