

# Product Size Chart

The dimensions are for reference only, please refer to the actual product for accuracy.

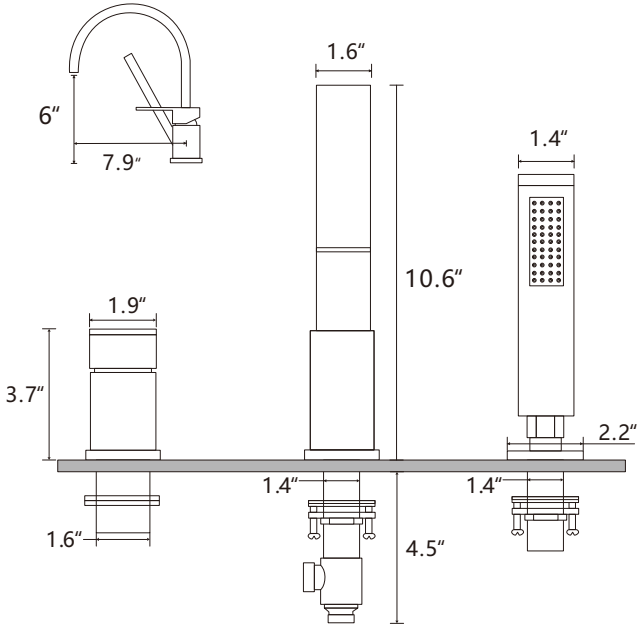

No.	Description
A	Faucet body
B	Handle body
C	Hand shower
D	Shower holder
E	O Ring
F	Fixing Kit
G	Rubber Gasket
H	Steel Gasket
I	Lock Nut
J	Connector
K	Hose
L	Extension Hose
M	Shower Hose

# Component

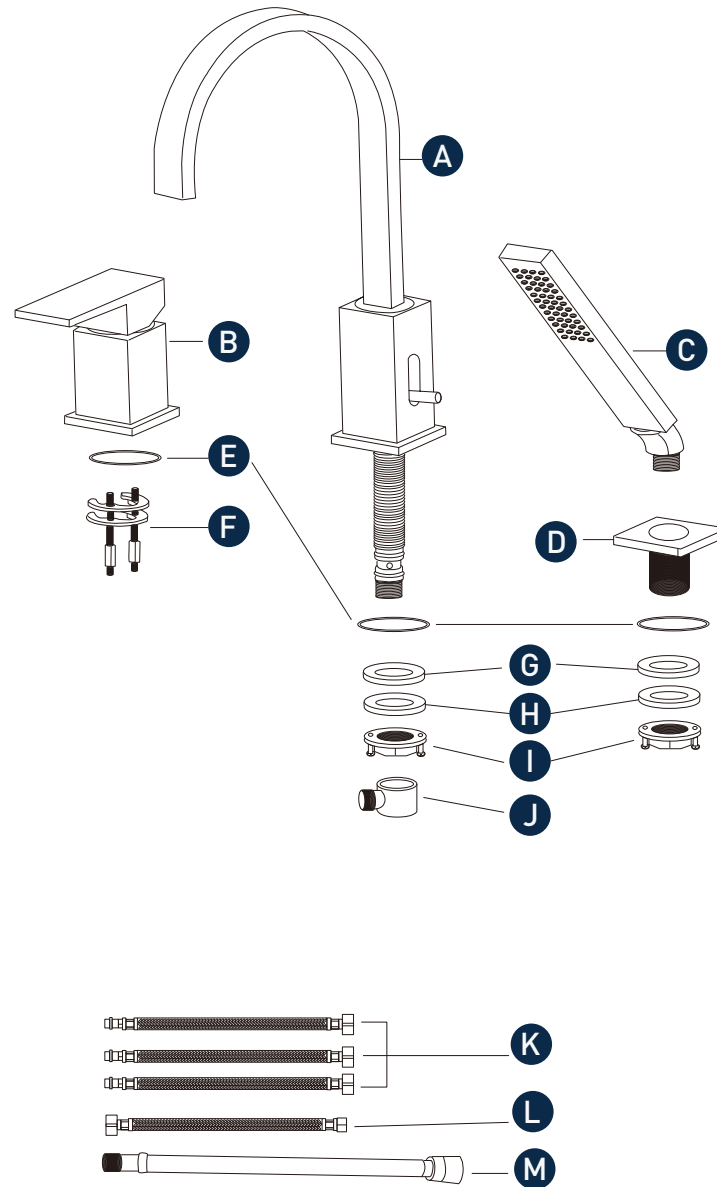

# INSTALLATION

**STEP 1:**

- Remove Rubber Gasket, Steel Gasket and Nuts.
- Install Body through the deck hole on the left. Note: Make sure there is a O Ring. under the Body.

**STEP 2:**

- Slide the Rubber Gasket and Steel Gasket up onto Body from under the deck and secure with Nuts.
- Adjust the position of Body. Hand tighten the Nuts and tighten with wrench to secure the Body.

**STEP 3:**

- Adjust the Spout so that the Rod at the right. Tighten the Screw to secure the Spout.
- Remove Gasket, Steel Gasket, Lock Nut and Connector from the shank.
- Install Spout through the deck hole in the middle. Note: Make sure there is a O Ring under the Spout.

# INSTALLATION

9

**STEP 4:**

- Slide the Gasket, Steel Gasket up onto Spout from under the deck and secure with Lock Nut.
- Adjust the position of Spout. Hand tighten the Lock Nut and tighten with screwdriver to secure the Spout.
- Install Connector to the shank. Hand tighten it. Unscrew the Connector so that the outlet pointed to the left. **DO NOT** unscrew the Connector over one turn, otherwise it may leaks.

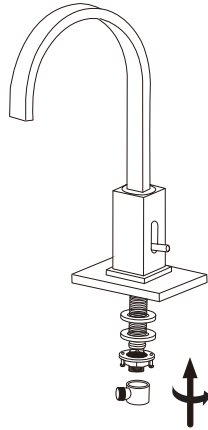

4

**STEP 5:**

- Remove the Gasket, Steel Gasket, LOCK Nut from the Shower Holder.

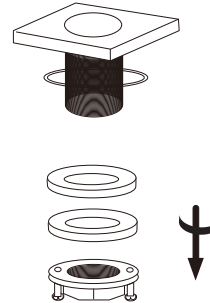

5

**STEP 6:**

- Install the Shower Holder through the deck hole on the right.
- Slide the Gasket and Steel Gasket up onto Shower Holder from under the deck and secure with Lock Nut.
- Adjust the position of Shower Holder. Handtighten the Lock Nut and tighten with screwdriver to secure the Shower Holder.

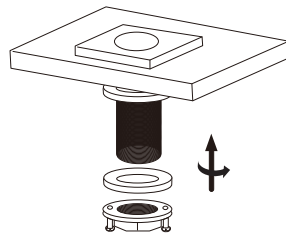

6

**STEP 7:**

- Connect Hand Shower and Shower Hose. Note: Make sure there is Washer between Connector and Shower Hose.

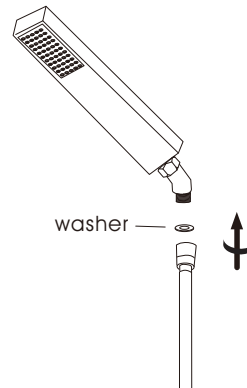

7

**STEP 8:**

- Slide the Shower Hose from above the Shower Holder.

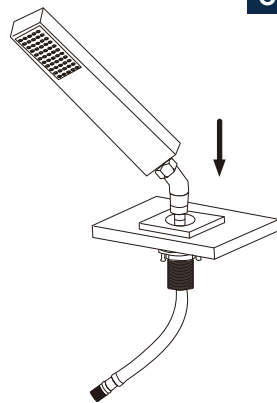

8

**STEP 9:**

- Turn on the supply stop valves for 30s to 1 min to flush the debris in the supply lines. Turn off the supply stop valves again.
- Connect the Hot Labeled Hose to the Hot Water Supply. Cold Labeled Hose to the Cold Water Supply. Tighten the Nuts with wrench. **DO NOT OVER TIGHTEN**
- Connect the third Hose to the Connector. Tighten the Nuts with wrench. **DO NOT OVER TIGHTEN.**
- Connect the Extension-Hose to the shank of the Spout from under the deck. Tighten the Nuts. with wrench. **DO NOT OVER TIGHTEN.**
- Connect the Shower Hose with the Extension-Hose from under the deck. Tighten the Nuts with wrench. **DO NOT OVER TIGHTEN.**
- Turn on the supply stop valves and check connections for leaks. Retighten if necessary. but **DO NOT OVER TIGHTEN.**

