

PRODUCT DRAWING

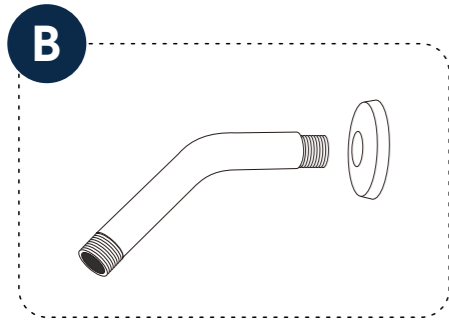

A



B

No.	Description
A	Head shower
B	Shower arm and flange kit

RECOMMENDED TOOLS

Plumber's putty



Thread seal tape



Included



1

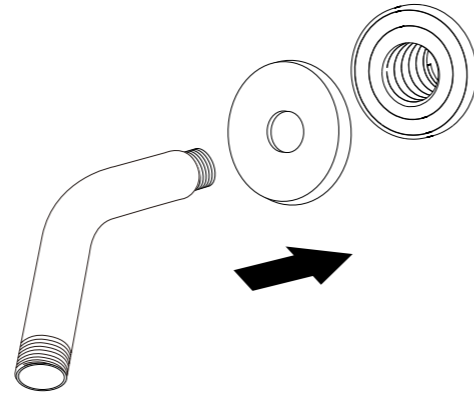

2

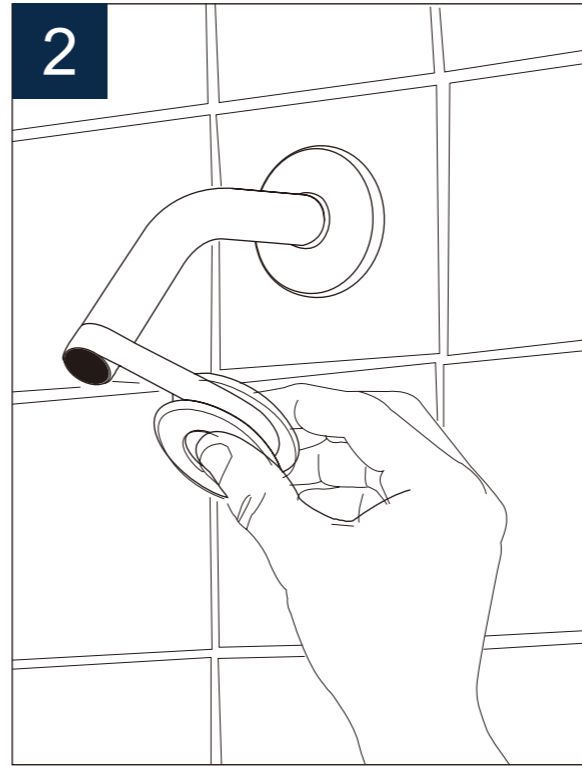

3



***DO NOT USE TOOLS**

4

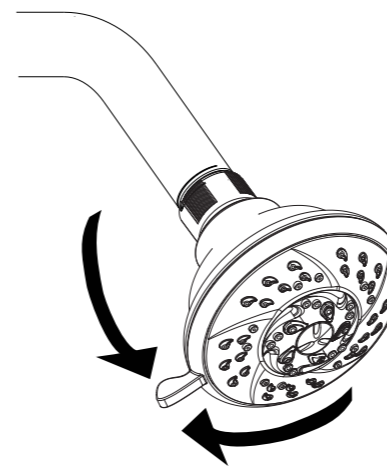

NOTE:

To change the spray settings, position hand over face of showerhead and rotate, while pressing thumb against tab.

SHOWER HEAD SET

Installation instruction



No control valve
MB / BN / BG / CH / ORB

CARE INSTRUCTIONS

Rinse the product with clear water. Dry the product with a soft cloth.

DO NOT:

Use abrasive cleansers, cloths, or paper towels. Use any cleaning agents containing acid, polish, wax, alcohol, ammonia, bleach, solvent or any other corrosive or harsh chemical cleansers.