

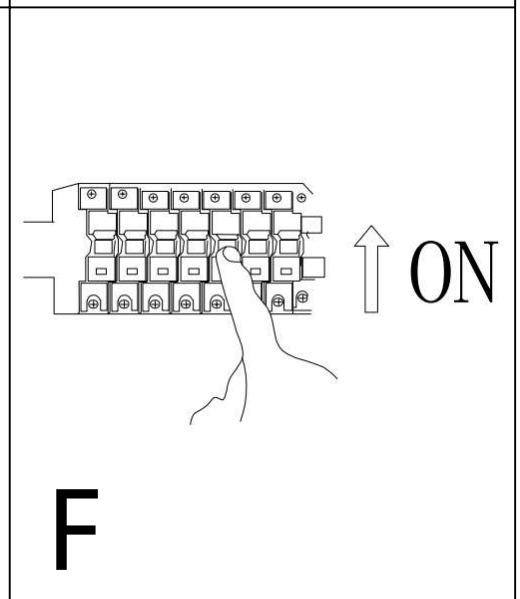

INSTRUCTIONS

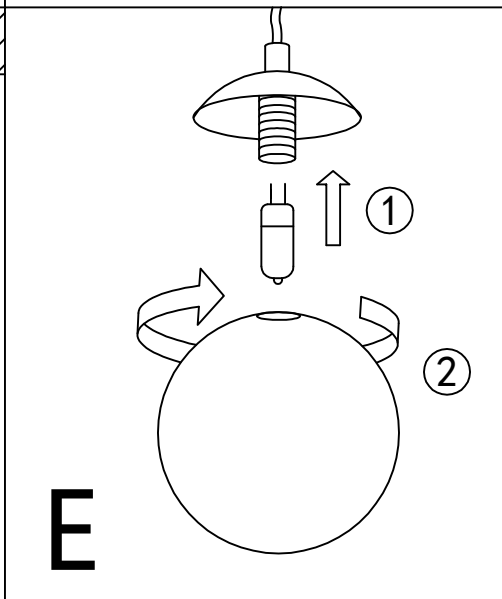

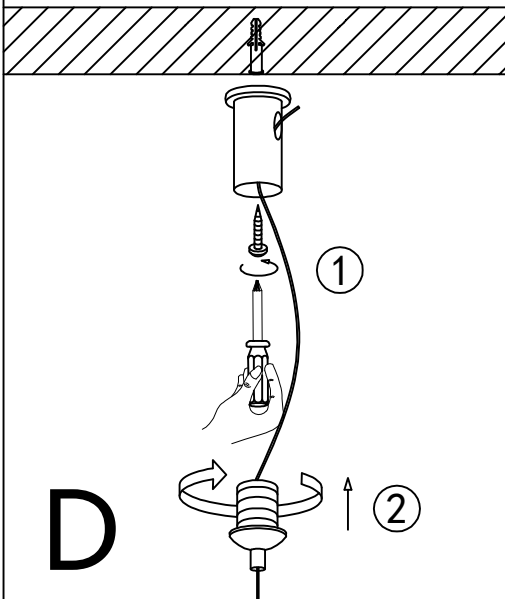

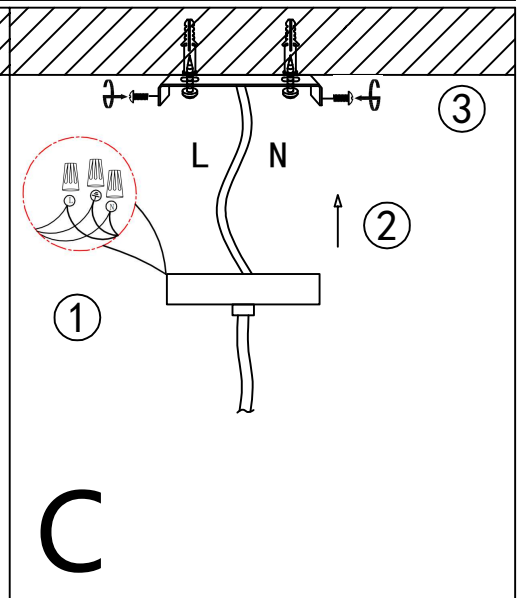
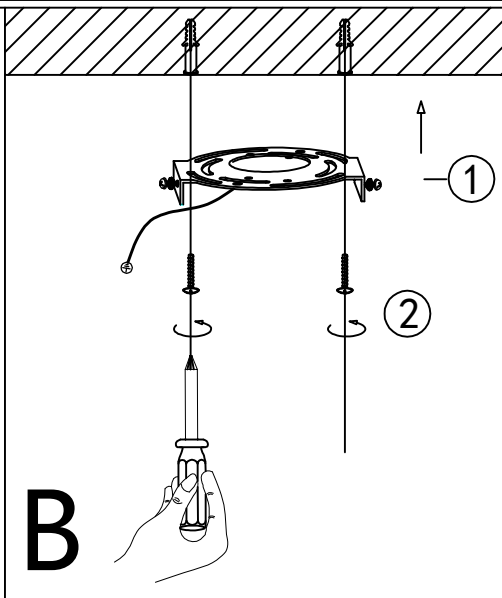
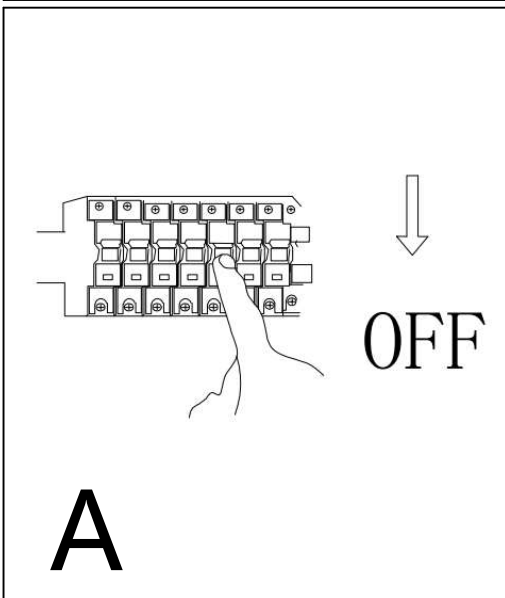
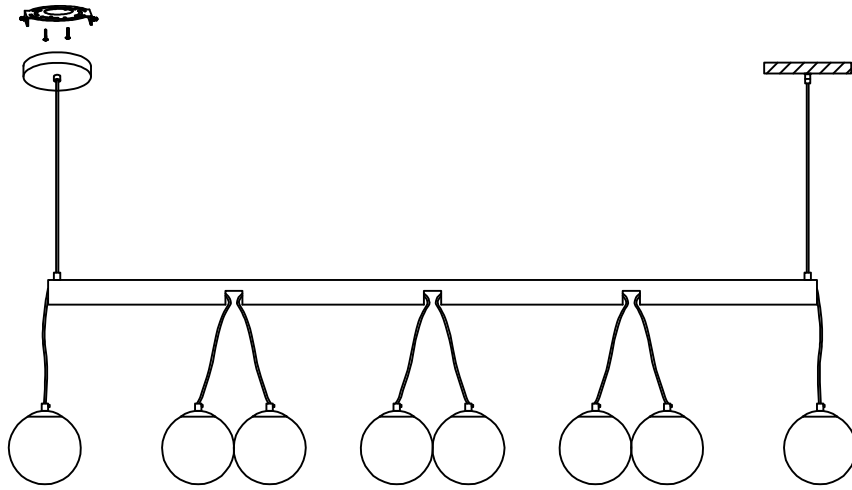





NOTES: 1. The symbol  indicates that the lamp head must be at least '0.5M' from the lighted surface

1. The symbol  indicates this luminaire is suitable for use on normally flammable surface

1. The symbol  indicates the luminaire is only suitable for use indoors

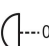
English

Safety directions: Please read this information carefully before installing or using this product. Please keep this user manual for further reference.

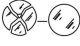
1. The lamps may only be installed by authorized and qualified technicians according to the valid regulations for electrical installation.
2. The manufacturer does not accept any responsibility for injuries or damage resulting from improper use of the light.
3. Maintenance of the lights is limited to the surfaces. When doing this, no moisture must come into contact with any areas of the terminal connections or mains voltage control parts.
4. Attention! Before starting the installation work, make sure that the mains power line is voltage-free - turn off safety cutout or unscrew the protection fuse. The switch must be "OFF".
5. The light has the protection degree IP20, covered design in accordance with IEC 529 and is only suitable for use in living areas.
6.  The symbol of the crossed-out garbage can on the product or the packaging means that the product must not be disposed with ordinary household waste. At the end of its useful life, the product must be returned to a point of acceptance for the recycling of electric and electronic device. Please ask your local municipality for the point of acceptance.
7. Safety class I . This light must be connected to the earthed conductor-terminal with the earthed conductor (green-yellow wire) .
8. Description of the supply terminals: L = Phase N = Neutral conductor  = Earthed conductor.
9. Do not install the light on a damp or conductive subsurface
10. Only the included individual parts may be used; otherwise any and all guarantee claims will expire.
11. Protective covers and end covers for mains voltage control parts must always be mounted.
12. Please make sure that no cables get damaged during the installation work.
13. The connecting cables must be covered with the silicone tubes enclosed.
14. Attention! During operation, lamp parts and illuminants can reach temperatures of more than 350°C. Do not touch during operation!
15. Please make sure that illuminants have first cooled down before replacing them. Attention! Switch the mains power line to zero potential and switch-off the circuit breaker and/or remove the fuse before!
16. Make sure that illuminants are securely fixed during the installation.
17. Faulty illuminants may only be replaced by lamps of the same type, output and voltage.
18. The maximum wattage indicated of each lighting unit must not be exceeded.
19. The lamp may only be adjusted and positioned after having cooled down.
20.  Minimum distance from the edge of the spotlight to the illuminated surface ≥ 0.5 m.
21. Do not touch halogen lamps  with bare fingers. If this should happen, however, then the illuminant must be wiped with alcohol and dried with a non-fluffy cloth.
22.  Only use halogen illuminants with a covering pane or in low-pressure technology.
23.  With this symbol, no "cool beam" illuminant must be used.
24.  Broken protective glass must be replaced immediately.
25. Do not touch the lamp while in operation.