

PRODUCT DRAWING

A — Installation method of shower arm

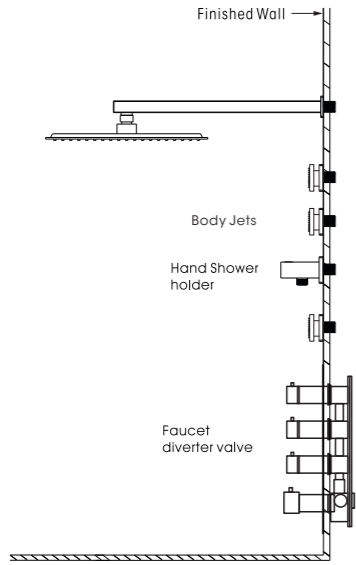

B — Installation method of Ceiling shower arm

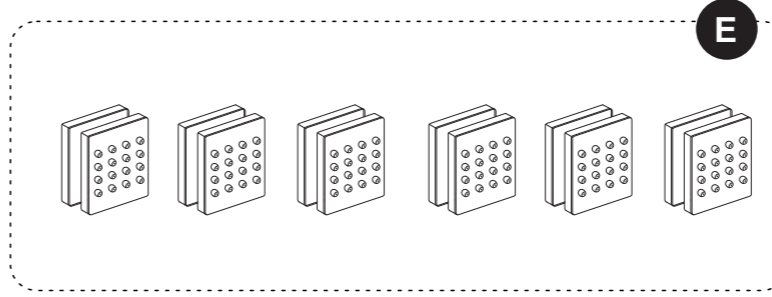
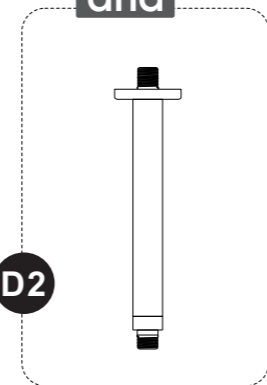
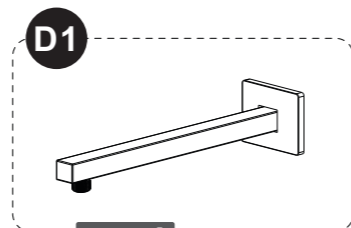
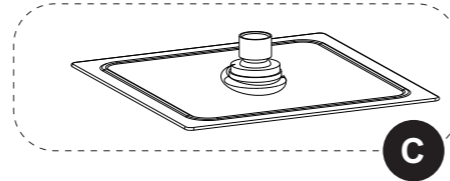
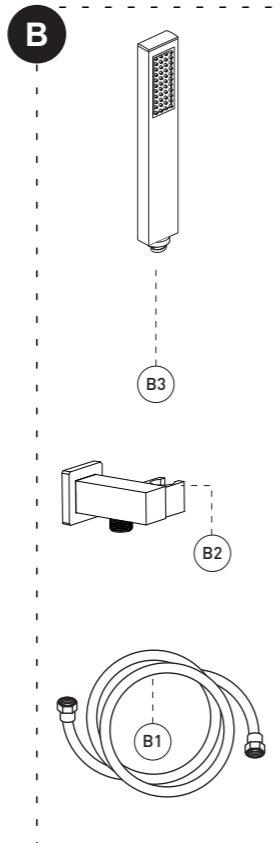
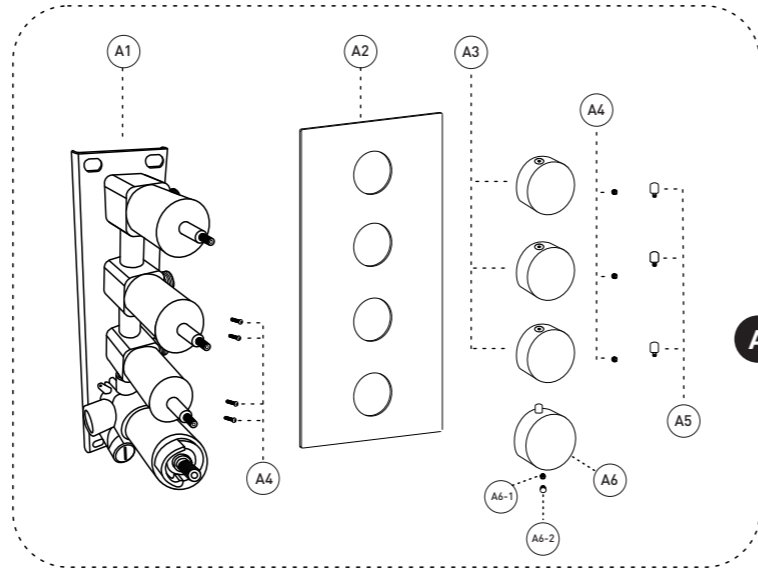
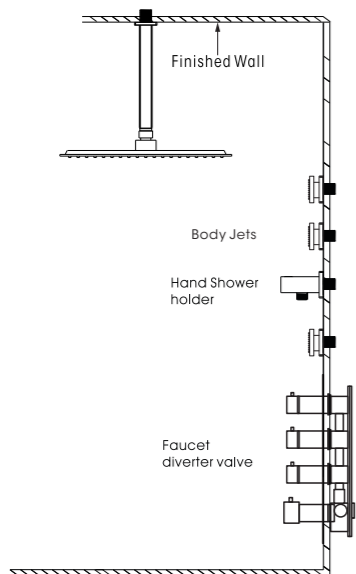

No.	Description				
A	Pressure balanced diverter valve				
A-1	Valve				
A-2	Face plate with sealjoint				
A-3	Diverter knob kit				
A-4	set screws				
A-5	Handwheel stem				
A-6	Shower valve knob kit				
A6-1	set screws				
A6-2	Trim cap (A4-2 included)				
B	Handheld Shower Kit with Flexible Hose				
B-1	Flexible hose				
B-2	Wall Bracket				
B-3	Hand shower				
C	Shower head				
D1	Shower arm set				
D2	Ceiling shower arm set				
E	body jets				
Z	Accessories Package				
<table border="1"> <thead> <tr> <th>For Repair And Warranty (Spare Parts)</th> <th>For Installation (Spare Parts)</th> </tr> </thead> <tbody> <tr> <td> </td> <td> </td> </tr> </tbody> </table>		For Repair And Warranty (Spare Parts)	For Installation (Spare Parts)		
For Repair And Warranty (Spare Parts)	For Installation (Spare Parts)				

SHOWER SYSTEM FAUCET

Installation instruction



MB/BN/BG/CH/ORB

CARE INSTRUCTIONS

Rinse the product with clear water. Dry the product with a soft cloth.

DO NOT:

Use abrasive cleansers, cloths, or paper towels. Use any cleaning agents containing acid, polish, wax, alcohol, ammonia, bleach, solvent or any other corrosive or harsh chemical cleansers.

! IMPORTANT

We recommends using a professional plumber for all installtion and repair. Please inform yourself about the canadian plumbing code`s regulations and your local municipality plumbing codes before installlation.the canadian plumbing code requires the installation of urge arresting devices to eliminate water hammering.allow an adequate opening in orderto easilyaccess connections or other plumbing devicesfor maintenance or repair.

RECOMMENDED TOOLS



* Apply plumber's putty under the plastic cover deck plecta to seal your installation.
Appliquez du mastic pour plombier sous la sous-plaque de plastique pour rendre votre installation étanche.

CONNECTION ADVICE

Firmly hand tighten the hose to the valve and add a quarter turn using the proper wrench. Tighten more if needed.

The model shown in the installation steps may differ from the one in box however connection type and installation steps are the same.

INSTALLATION STEPS

INSTALL THE SHOWER VALVE BODY

