

# FREESTANDING FAUCET

Installation instruction

CH/BN/MB/BG/ORB



## 1. INSTALLATION PRECAUTIONS

- When you open the product packaging, please check the product and accessories at first. If there are any discrepancies, please contact us promptly. We will provide you with a satisfactory solution.
- The hot and cold water supply pipe of the valve must be properly connected. When facing the front of the valve, the hot water supply is on the left and cold water supply is on the right. Incorrect connection will cause permanent damage to the cartridge.
- If the accessories to be changed without affecting the use, we will not make a prior notice.
- The impurities in the water supply pipe must be cleared before installation to avoid blockage.
- The water pressure of the faucet is 0.05MPa-1.0MPa(including cold water and hot water Pressure). Applicable water temperature range:39° F-194° F.

## 2. PREPARATION BEFORE INSTALLATION

CONNECTION ADVICE

Firmly hand tighten the hose to the valve and add a quarter turn using the proper wrench. Tighten more if needed.

\* Apply plumber's putty under the plastic cover deck plate to seal your installation.

\*The model shown in the installation steps may differ from the one in box however connection type and installation steps are the same.

Plumber's putty

Thread seal tape

Included

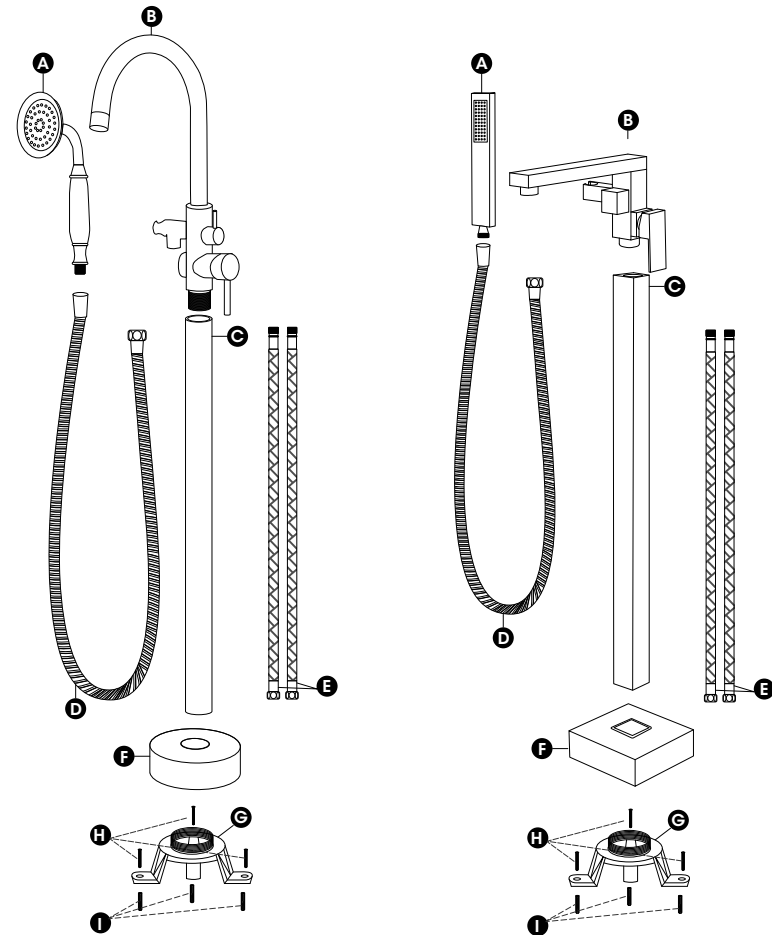

## 3. FAUCET ACCESSORIES LIST

No.	Description
A	Hand shower
B	Main Body
C	Straight Tube
D	Flexible hose
E	Inlet Tube
F	Base flange cover
G	Base flange
H	Screws
I	Anchor

## CARE INSTRUCTIONS

Rinse the product with clear water. Dry the product with a soft cloth.

## DO NOT:

Use abrasive cleansers, cloths, or paper towels. Use any cleaning agents containing acid, polish, wax, alcohol, ammonia, bleach, solvent or any other corrosive or harsh chemical cleansers.

## 4. FREESTANDING FAUCET INSTALLATION

1. Slide the decorative baseplate onto the faucet body, as shown.

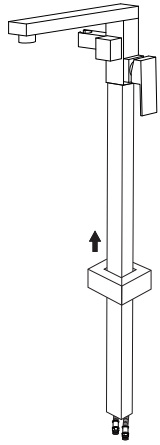

2. Attach the mounting bracket by threading it onto the base of the faucet. Hand tighten firmly. Position the faucet at its desired location, then mark the location of the mounting holes on the floor. Set the faucet aside.

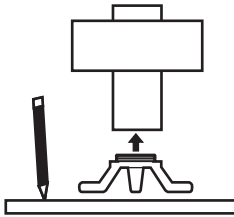

3. Drill pilot holes into the floor at the marked mounting hole locations.

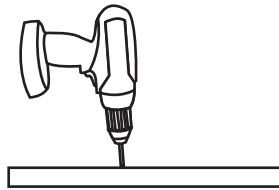

7. Secure the faucet to the floor using the metal washers, locking washers, and nuts that were removed earlier. Slide the decorative baseplate to the floor to conceal the mounting hardware and rough-in.

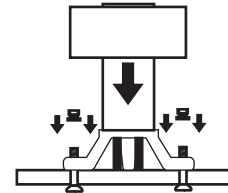

8. Finish your installation by attaching the hand shower to the faucet using the hand shower hose. Hand tighten each connection firmly.

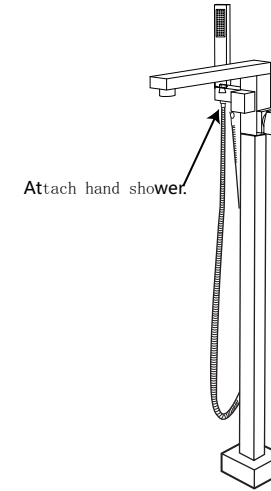

9. Once installation is complete, turn on the main water supply. Turn the faucet on and allow the water to flow for 60 seconds. Check for any leaks, and that hot and cold water are running appropriately. Divert the water to the hand shower and allow the water to flow through the hose for approximately 60 seconds

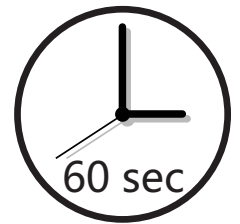

4. Remove the nuts, locking washers, and metal washer from each of the mounting screws. Drop each of the screws and anchors into the drilled pilot holes, with the threads facing up through the floor.

5. Connect the braided water lines to the main water supply at the floor. Ensure that you are connecting the hot and cold lines appropriately. Apply thread sealant or plumber's tape to the threads before attaching. Hand tighten firmly, then finish tightening using an adjustable wrench. Be careful not to overtighten.

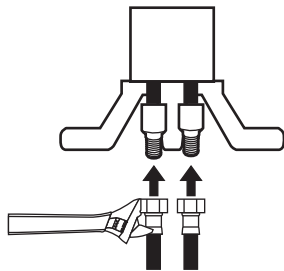
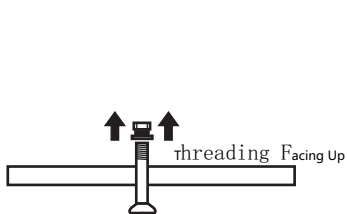

6. Briefly turn on the main water supply to ensure that there are no leaks. Once you have determined that there are no leaks, turn the water supply back off and continue with the installation.

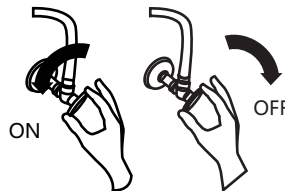

## 5. PRODUCT REPAIR

If the cartridge is worn out which cause leakage, please turn off the water source. Remove the handle, panel, and decorative cover in sequence, remove the gland with a wrench, then take out the cartridge and copper sleeve. Repair or replace the new cartridge, then install it again in sequence.

## 6. CLEARANCE AND MAINTENANCE

In order to keep the faucet appearance smooth and good performance, please follow the below steps to clean and maintain the faucet.

1. Clean with water and dry with a soft cotton cloth.
2. Use a mild liquid and a colorless glass cleaner to remove surface dirt and scale, also you can use the cleaner without grinding function.
3. Do not use detergents, polishing tools, abrasive cloth, paper towels or scrapers to clean the faucet.
4. Do not use acid cleaners, insoluble granular detergents, soaps etc to clean the Faucet.